



PRICED AT  
**\$520,400**

 2004 Sq Ft

 3 Beds

 3.5 Baths

 2 Car Garage

 3.0 Story

Spring into a New Home!! The Glendale, one of our most popular townhomes is being built here just for you! This spacious 3 story, 3 bedroom and 3.5 bath home is move-in ready! The Brackley hosts a doggie park for our four-legged friends, a fabulous pool and cabana, wide sidewalks, a great green space for meeting your neighbors, a picnic, soccer etc. Located just one mile from GA 400, the newest TPG community offers so much for our homeowners! The Cumming City Center is just around the corner, with loads of restaurants and retail for easy living! And speaking of easy, your HOA will maintain your lawn for you! The Glendale is a well laid out home with 9-foot ceilings located on all 3 floors. The terrace level will have a bedroom/office with a full bath. As you enter the main floor of the home, you will notice there is ample space for all your living needs. Open and bright! This home will have quartz countertops, our beautiful white cabinets, undercounter lighting and soft touch drawers and doors as a standard. The island in this home boasts extra storage as well as a huge sink and ample counter space. Great ...

**Want to Know More  
About This Home?**

CONTACT OUR COMMUNITY SALES MANAGER  
Call Us @ 470-509-9930



**Want to Know More  
About This Home?**

CONTACT OUR COMMUNITY SALES MANAGER  
Call Us @ 470-509-9930

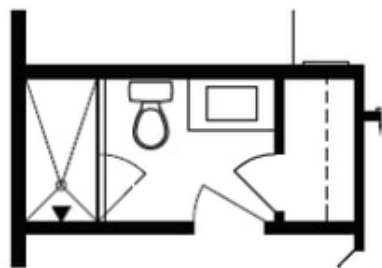

Optional Bath 3 Shower ilo Tub



Optional Owner's Luxury Shower

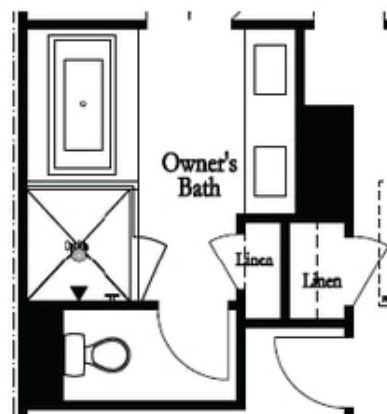

Optional Owner's Shower & Tub

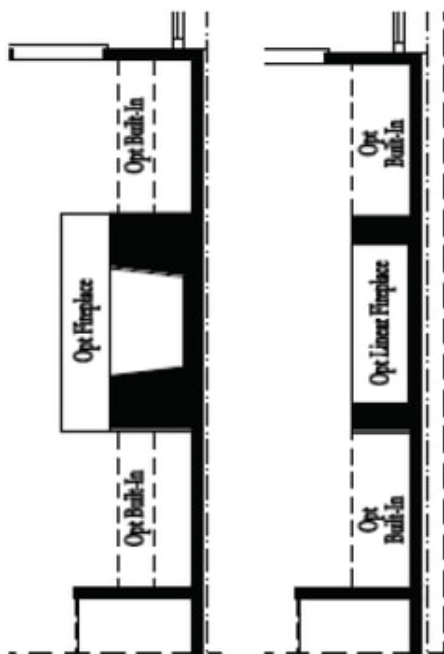

Optional  
Family Room  
Fireplace

Optional  
Family Room  
Linear Fireplace

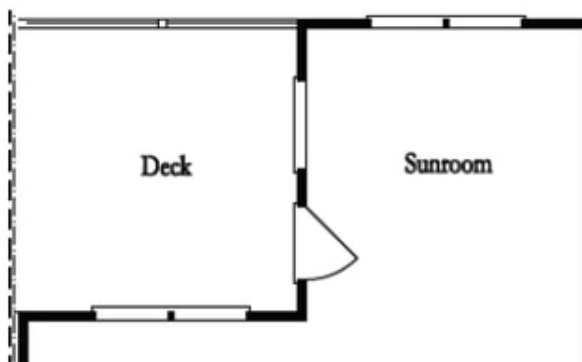

Optional Sunroom 1 ilo Extended Deck

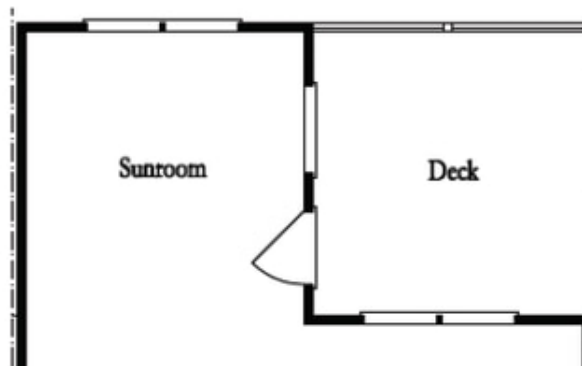

Optional Sunroom 2 ilo Extended Deck

**Want to Know More  
About This Home?**

CONTACT OUR COMMUNITY SALES MANAGER  
Call Us @ 470-509-9930