



PRICED AT  
**\$837,670**

 2379 Sq Ft

 4 Beds

 3.5 Baths

 2 Car Garage

 3.0 Story

Elevate your life in 2023 with a new home by The Providence Group \*\*\$15,000 Towards Closing Cost for Closings by 9/30 with any one of Seller's 5-Preferred Lenders\*\* MOVE IN READY! Come make Alpharetta a place to call home! OPEN CONCEPT LIVING offering an ALL WHITE DESIGN PALLET allowing for your personality to shine. BLACK MATTE HARDWARE with lighting fixtures that are a mix of black and satin bronze creating a more modern atmosphere. Family Room fireplace has gorgeous VERTICAL IRON ORE SHIPLAP Surround. 3rd floor features an oversized Owner's Suite w/large walk-in closet. Spa like Owner's Bath offers a FREE STANDING TUB too! Two bedrooms in the rear can both access the 2nd deck and enjoy some sunshine! The terrace level has a 4th bedroom with a private bath. HARDWOODS THROUGHOUT. 3-Story Brick Exterior with 2-car garage and 2-car driveway. Front fenced in landscaped yard HOA maintained. Our tree-lined Atley gated community in Downtown Alpharetta offers a pool, neighborhood garden, dog park and Alpha Loop running right through to hop on and get your day started. 1-2-8 Warranty.

**Want to Know More  
About This Home?**

CONTACT OUR COMMUNITY SALES MANAGER  
Call Us @ 470.436.2641



Want to Know More  
About This Home?

CONTACT OUR COMMUNITY SALES MANAGER  
Call Us @ 470.436.2641

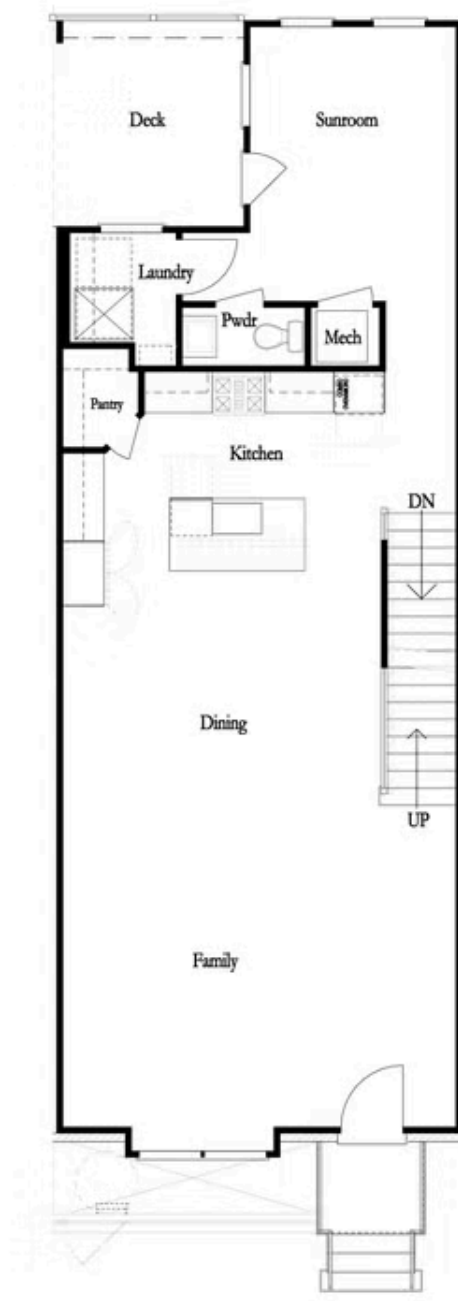

Want to Know More  
About This Home?

CONTACT OUR COMMUNITY SALES MANAGER  
Call Us @ 470.436.2641

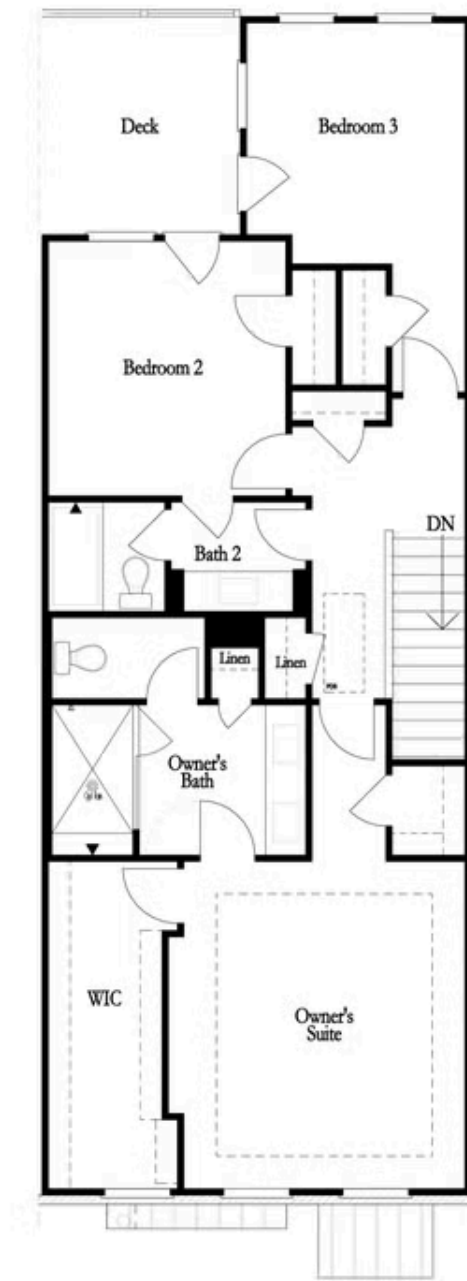

Want to Know More  
About This Home?

CONTACT OUR COMMUNITY SALES MANAGER  
Call Us @ 470.436.2641



Left End  
Opt. Sprinkler Room



Right End  
Opt. Sprinkler Room

First Floor Options

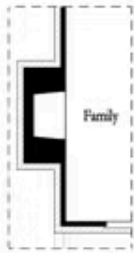

Opt. Exterior Fireplace

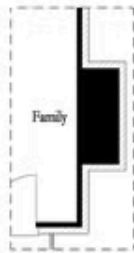

Opt. Faux Exterior  
Fireplace

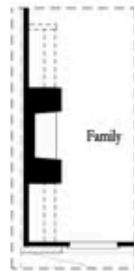

Opt. Fireplace

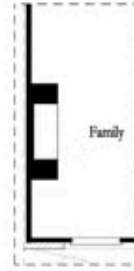

Opt. Linear Fireplace

Second Floor Options

Want to Know More  
About This Home?

CONTACT OUR COMMUNITY SALES MANAGER  
Call Us @ 470.436.2641

### Options

#### Third Floor Options

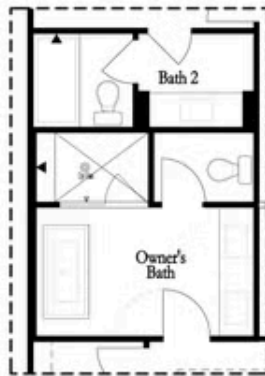

Opt. Freestanding  
Tub/Shower Combo



Opt. Walk-Through Shower

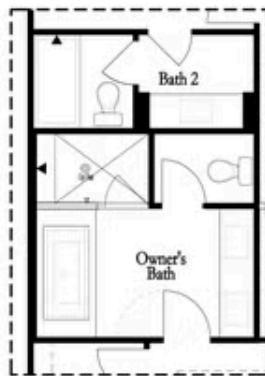

Opt. Decked  
Tub/Shower Combo

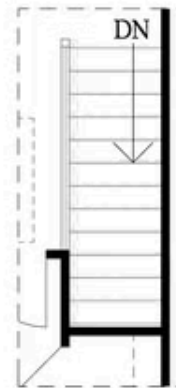

Opt. Open Rail

Want to Know More  
About This Home?

CONTACT OUR COMMUNITY SALES MANAGER  
Call Us @ 470.436.2641