



PRICED AT
\$521,325

 2520 Sq Ft

 3 Beds

 2.0 Baths

 1 Car Garage

 2.0 Story

Cochran END by The Providence Group. Welcome to the newest gated community in the heart of Alpharetta just steps from Avalon, Maxwell Retail & City Center. This community offers pool, cabana, neighborhood garden, dog park attached to the Alpha Loop surrounded by trees. Open concept one level living at its finest. Private front entrance w/covered porch & 1car garage w/private driveway. Upgrades include quartz countertops, stainless steel appliances, 10'ceilings & oversized Owner's Suite w/huge Owner's walk-in closet. Both Secondary Bedrooms have Walk in Closets Too! Soaking tub in Owner's Bath to dip your toes into after a long day. Option for an elevator should you want to add at the right time of construction. Still have time to select your design package and upgrades before it's too late! Home to be ready August/September 2021.

**Want to Know More
About This Home?**

CONTACT OUR COMMUNITY SALES MANAGER
Call Us @ 470.436.2641



Want to Know More
About This Home?

CONTACT OUR COMMUNITY SALES MANAGER
Call Us @ 470.436.2641

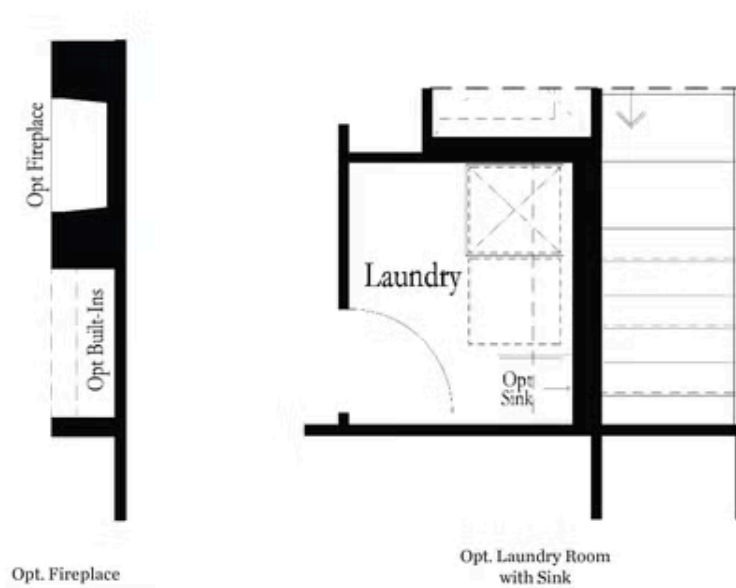

Want to Know More
About This Home?

CONTACT OUR COMMUNITY SALES MANAGER
Call Us @ 470.436.2641



SECOND FLOOR - LEFT END UNIT

Want to Know More
About This Home?

CONTACT OUR COMMUNITY SALES MANAGER
Call Us @ 470.436.2641



SECOND FLOOR - RIGHT END UNIT

Want to Know More
About This Home?

CONTACT OUR COMMUNITY SALES MANAGER
Call Us @ 470.436.2641