







PRICED AT  
**\$811,300**

-  2141 Sq Ft
-  3 Beds
-  2.5 Baths
-  2 Car Garage
-  2.0 Story

MOVE IN READY! Braxton Townhome at The Providence Group- Welcome home to a treelined gated community w/pool, cabana, dog park & neighborhood garden all in the heart of Alpharetta. Quick walk to Maxwell Retail then stroll on over to Avalon or Downtown City Center. This plan offers main level walk in from garage & front door to open concept living space and private foyer. Lots of rear windows bringing in sunlight and wooded views to enjoy. The dining room windows lets in lots of natural light! 2car garage w/driveway long enough for 2 more cars. HOA landscaped lawns providing beautiful ambiance as you relax. Large walk in closets in all bedrooms and 2 in the Owner's Suite! Owner's bath has vaulted ceilings too! Quartz countertops, cabinets to the ceiling in the kitchen that offer glass front cabinets as well. Hardwoods throughout and floor to ceiling wrapped tile at the Fireplace in the Family Room. Come make space for life here at Atley - 1/2/8 Home Warranty

**Want to Know More  
About This Home?**

CONTACT OUR COMMUNITY SALES MANAGER  
Call Us @ 470.436.2641



First Floor

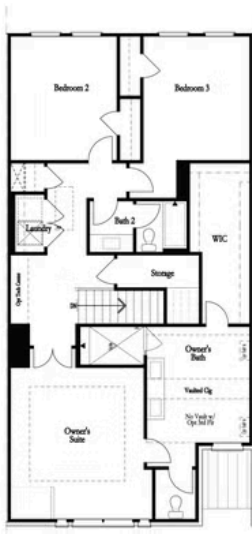

Second Floor (Owner's Front)



Second Floor (Owner's Rear)

Want to Know More  
 About This Home?

CONTACT OUR COMMUNITY SALES MANAGER  
 Call Us @ 470.436.2641