



PRICED AT  
**\$529,400**

 1450 Sq Ft

 2 Beds

 2.5 Baths

 1 Car Garage

 3.0 Story

Discover the Magnolia Plan at Brookside Reserve by The Providence Group, a brand-new community located in the heart of Alpharetta! Designed to suit a variety of lifestyles, Brookside Reserve is ideal for both first-time homebuyers and those seeking to downsize. Conveniently situated, residents will enjoy easy access to nearby retail and dining options, with Avalon just over a mile away! This home features a stylish three-story townhome with condominium ownership, offering both comfort and convenience. Spanning approximately 1,450 square feet, the residence includes two bedrooms and two-and-a-half bathrooms. The terrace level welcomes you with a gracious foyer and a conveniently located laundry room. The main level features an open-concept design, seamlessly connecting the family room, dining area, and a chef-inspired kitchen. Appointments include 42-inch cabinetry, quartz countertops, stainless steel GE appliances, a tile backsplash, modern lighting, and access to a covered porch. On the third level, the spacious primary suite includes a walk-in closet and a contemporary bathroom with a double vanity. An additional bedroom with its own private bathroom completes the upper level. Select your design package for the home now through June 8, 2026! Brookside Reserve is Alpharetta's newest community by The Providence Group. Contact us today to ...

**Want to Know More  
About This Home?**

CONTACT OUR COMMUNITY SALES MANAGER  
Call Us @ 770.846.8220



Want to Know More  
About This Home?

CONTACT OUR COMMUNITY SALES MANAGER  
Call Us @ 770.846.8220

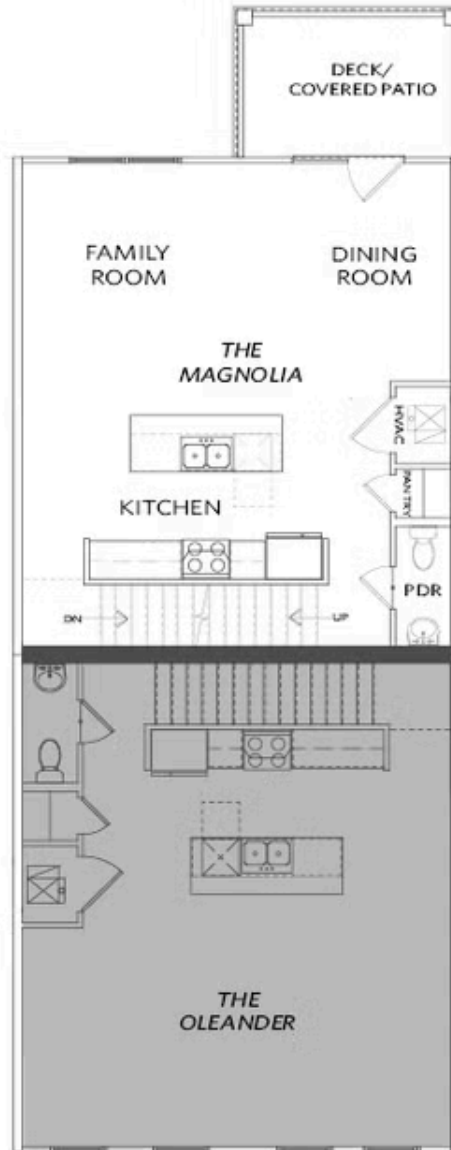

Elevations 1, 2, & 3 Interior Floor Plan Layout

Want to Know More  
About This Home?

CONTACT OUR COMMUNITY SALES MANAGER  
Call Us @ 770.846.8220

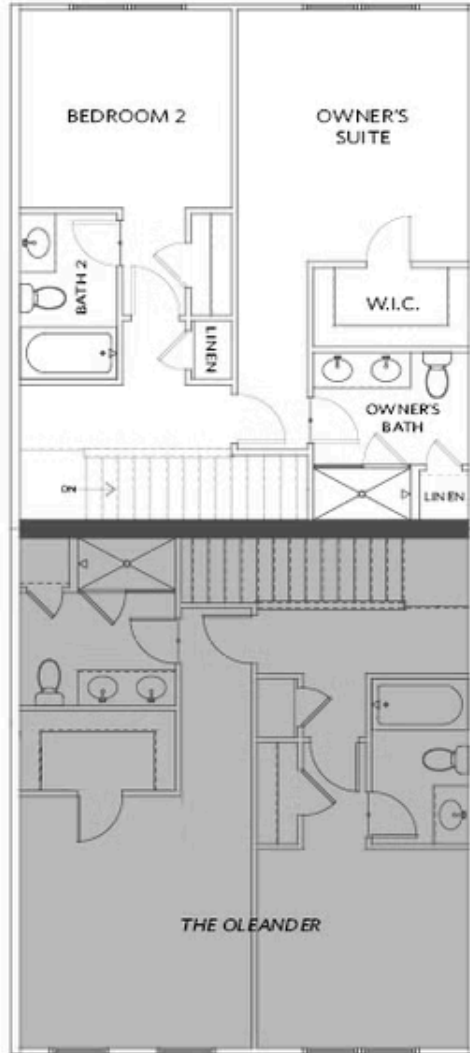

Elevations 1, 2, & 3 Interior Floor Plan Layout

Want to Know More  
About This Home?

CONTACT OUR COMMUNITY SALES MANAGER  
Call Us @ 770.846.8220