





PRICED AT
\$562,100

-  1776 Sq Ft
-  3 Beds
-  3.5 Baths
-  1 Car Garage
-  3.0 Story

Stunning New Construction in Brookside Reserve – Prime Alpharetta Location! Welcome to this beautifully designed Oleander floor plan by The Providence Group, located in the highly desirable Brookside Reserve community. This brand-new 3-bedroom, 3.5-bath townhome offers 1,776 square feet of thoughtfully curated living space across three levels, blending modern style with everyday functionality. The terrace level features a private bedroom with a full en suite bath, perfect for guests, a home office, or flexible living needs. This level also includes a conveniently located laundry area equipped with a space-saving 2-in-1 washer/dryer unit, along with direct access to the one-car garage. On the main level, enjoy an open-concept floor plan designed for effortless entertaining. The spacious family room flows seamlessly into the dining area and a beautifully appointed kitchen featuring 42" soft-close cabinetry, quartz countertops, GE stainless steel appliances, a designer tile backsplash, and upgraded lighting. The upper level offers a well-appointed primary suite complete with a large walk-in closet and a spa-inspired bath featuring dual vanities and a walk-in shower. An additional secondary bedroom with its own en suite bath and a conveniently located hall linen closet complete this level. Ideally situated in the heart of Alpharetta, just over a ...

**Want to Know More
About This Home?**

CONTACT OUR COMMUNITY SALES MANAGER
Call Us @ 770.846.8220

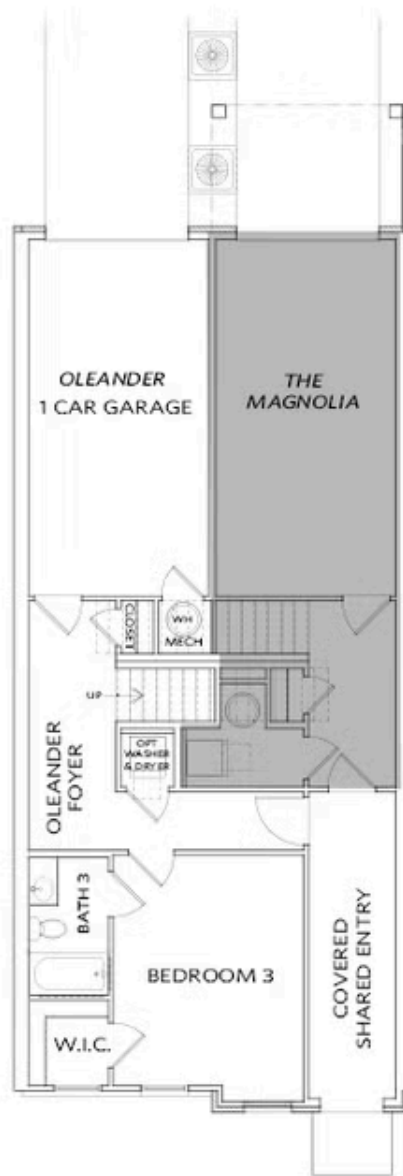

Elevations 1, 2, & 3 Interior Floor Plan Layout

Want to Know More
About This Home?

CONTACT OUR COMMUNITY SALES MANAGER
Call Us @ 770.846.8220

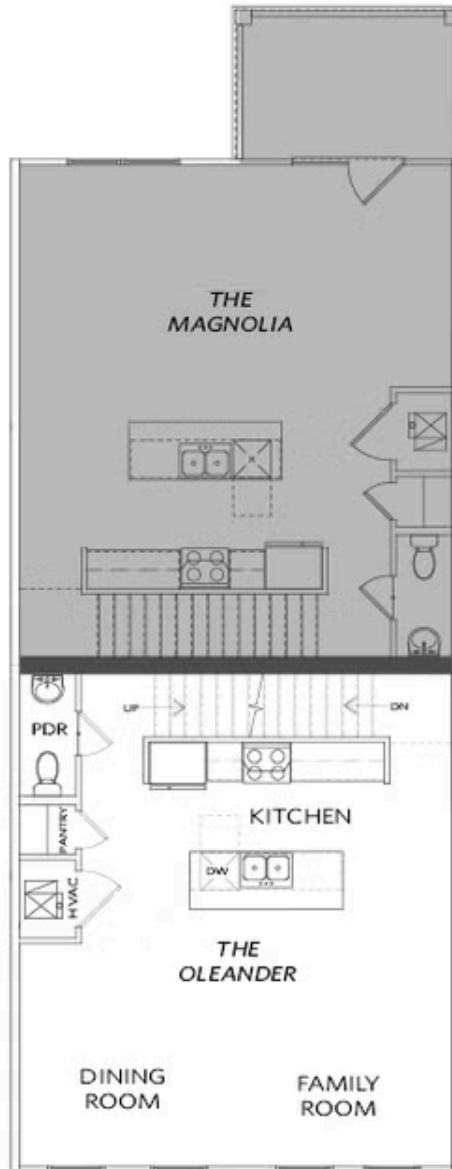

Elevations 1, 2, & 3 Interior Floor Plan Layout

Want to Know More
About This Home?

CONTACT OUR COMMUNITY SALES MANAGER
Call Us @ 770.846.8220

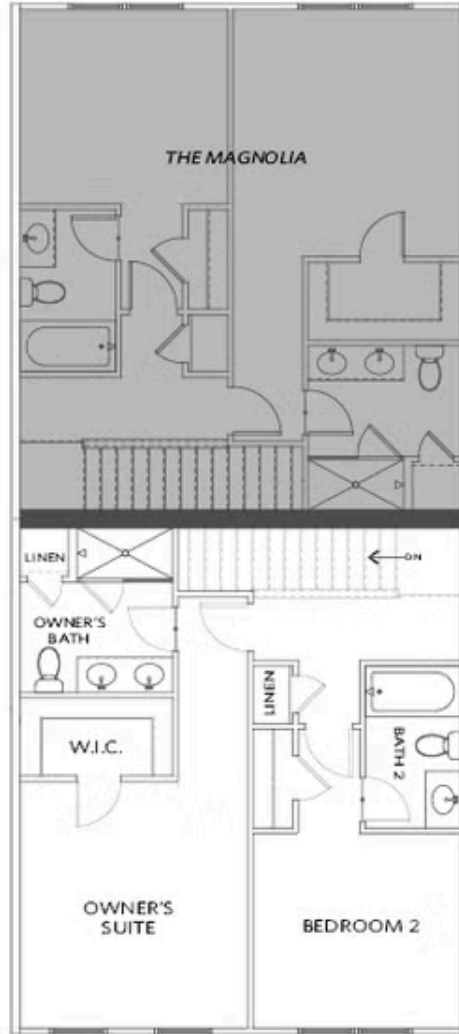

Elevations 1, 2, & 3 Interior Floor Plan Layout

Want to Know More
About This Home?

CONTACT OUR COMMUNITY SALES MANAGER
Call Us @ 770.846.8220