



PRICED AT
\$867,655

 2117 Sq Ft

 3 Beds

 3.5 Baths

 2 Car Garage

 3.0 Story

"New Year, NEW HOME " Enjoy \$35,000 Promotion on contracts written by end of January. This promotion can be applied towards a price reduction, closing costs, rate buydown and more giving you the flexibility to save where it matters most. Ends January 31, 2026. Discover The Childress by the Providence Group- This home is ready NOW -Just picture yourself enjoying the New Year in your new home!! Byers Park -Downtown Alpharetta's newest boutique townhome community just moments from Avalon and the heart of the city's vibrant lifestyle. This thoughtfully designed townhome blends modern luxury with timeless sophistication, featuring plenty of upgraded included features such as GE appliances, including a gas slide-in range, and upgraded cabinets, quartz and pendants. The spacious and open kitchen features stunning Morningside White 42" stacked cabinets with an accent Charcoal colored island finished with Calacatta Miraggio Gold Quartz and white tile with a sleek stainless steel ventless hood. The open-concept living area is anchored by a striking linear fireplace with a stunning white stacked quartzite surround to a 10-foot ceiling height. A bright sunroom provides direct access to a private deck—ideal for relaxing, entertaining, or working from home. A private terrace-level suite offers a perfect retreat ...

Want to Know More
About This Home?

CONTACT OUR COMMUNITY SALES MANAGER
Call Us @ 470.248.2777

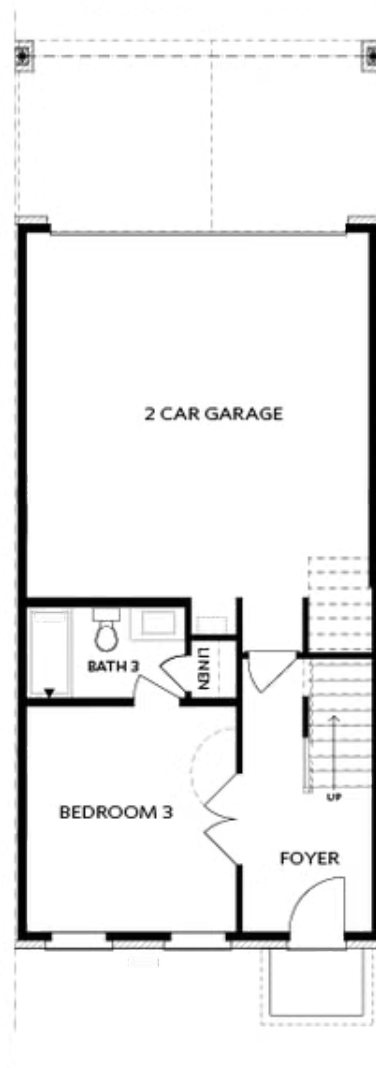

FIRST FLOOR

Elevation R

Want to Know More
About This Home?

CONTACT OUR COMMUNITY SALES MANAGER
Call Us @ 470.248.2777



SECOND FLOOR

Elevation R

Want to Know More
About This Home?

CONTACT OUR COMMUNITY SALES MANAGER
Call Us @ 470.248.2777



THIRD FLOOR

Elevation T

Want to Know More
About This Home?

CONTACT OUR COMMUNITY SALES MANAGER
Call Us @ 470.248.2777

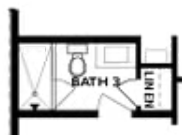

OPT Shower

BASEMENT



OPT Linear Fireplace



OPT Fireplace

SECOND FLOOR



OPT Open Rail



OPT Walk-Through Shower



OPT Freestanding Tub/Shower Combo

THIRD FLOOR

OPTIONS

Want to Know More
About This Home?

CONTACT OUR COMMUNITY SALES MANAGER
Call Us @ 470.248.2777