



PRICED FROM
\$809,900

 2,105 - 2,117 Sq Ft

 3 Beds

 3.5 Baths

 2 Car Garage

 3.0 Story

- 3 Stories - Terrace Entry
- Bedroom with Full Bath on Terrace Level
- Gourmet Kitchen with Island
- Open Concept on Main Level
- Sunroom with Deck on Main Level
- Owner's Suite and Private Bath with Separate Tub, Shower, Dual Vanities and Large Walk-In Closet
- Laundry on Third Floor

• Two Car Garage

[Read More Online](#)

Available Elevations



The Childress at Byers Park - Rendering

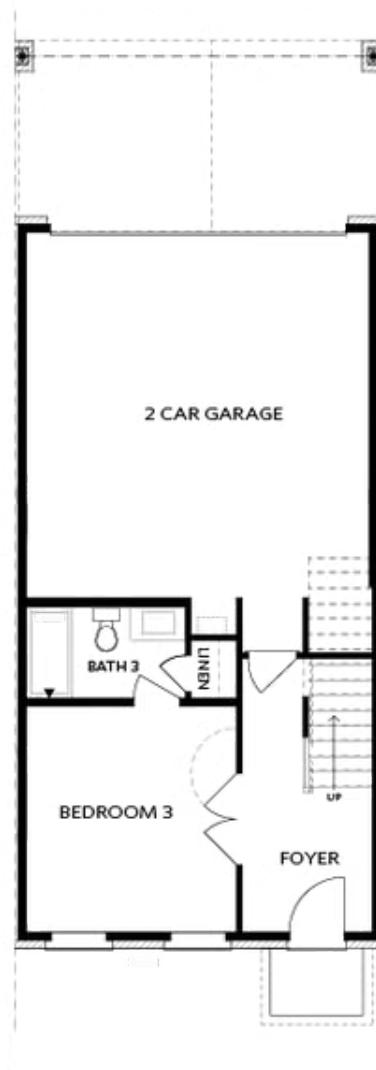

FIRST FLOOR

Elevation R

Want to Know More
About This Home?

CONTACT OUR COMMUNITY SALES MANAGER
Call Us @ 470.248.2777



Elevation R

Want to Know More
About This Home?

CONTACT OUR COMMUNITY SALES MANAGER
Call Us @ 470.248.2777



THIRD FLOOR

Elevation T

Want to Know More
About This Home?

CONTACT OUR COMMUNITY SALES MANAGER
Call Us @ 470.248.2777

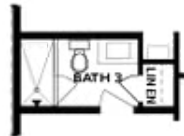

OPT Shower

BASEMENT



OPT Linear Fireplace



OPT Fireplace

SECOND FLOOR



OPT Open Rail



OPT Walk-Through Shower



OPT Freestanding Tub/Shower Combo

THIRD FLOOR

OPTIONS

Want to Know More
About This Home?

CONTACT OUR COMMUNITY SALES MANAGER
Call Us @ 470.248.2777