



PRICED AT
\$825,265

 3778 Sq Ft

 6 Beds

 5.0 Baths

 2 Car Garage

 3.0 Story

Calhoun A (Home Site 226) - TO BE BUILT HOME by The Providence Group ready Sept/Oct 2021. Hurry to be able to personalize with your own design selections! \$5000 - Seller Paid Closing Costs with use of preferred lender. Just four miles from Alpharetta's thriving Downtown or the beckoning streets of Avalon. Less than two miles to the New Halcyon! Gated neighborhood w/13 Acre Central Park with Walking Trails, Clubhouse, Pool, Tennis, Playgrounds and HOA Maintained Lawns. Top-Notch Forsyth Co Schools. Best of all, this well-situated location means you can take advantage of low Forsyth taxes while enjoying a fantastic Alpharetta lifestyle!

**Want to Know More
About This Home?**

CONTACT OUR COMMUNITY SALES MANAGER
Call Us @ (770) 521-2151



Want to Know More
About This Home?

CONTACT OUR COMMUNITY SALES MANAGER
Call Us @ (770) 521-2151



Want to Know More
About This Home?

CONTACT OUR COMMUNITY SALES MANAGER
Call Us @ (770) 521-2151



Want to Know More
About This Home?

CONTACT OUR COMMUNITY SALES MANAGER
Call Us @ (770) 521-2151

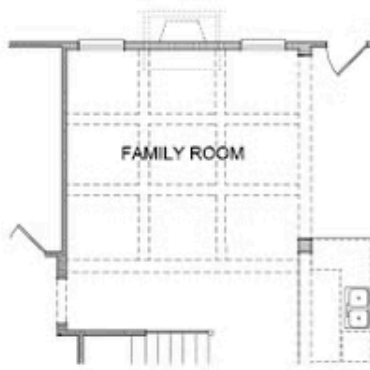

Opt. Coffered Ceilings
w/ Opt. Media Room or Bedroom 5 above



Opt. Bedroom 4 w/ Full Bath
No Study & Power Room



Opt. Sunrooms

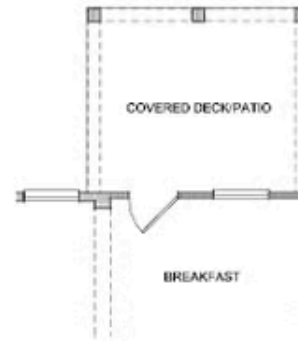

Opt. Covered Deck/Patio

Want to Know More
About This Home?

CONTACT OUR COMMUNITY SALES MANAGER
Call Us @ (770) 521-2151



Want to Know More
About This Home?

CONTACT OUR COMMUNITY SALES MANAGER
Call Us @ (770) 521-2151