



PRICED AT
\$776,130

 3507 Sq Ft

 5 Beds

 4.0 Baths

 2 Car Garage

 3.0 Story

Montgomery B (lot 208) - PRESALE BASEMENT HOME by The Providence Group. OTHER FLOORPLANS ALSO AVAILABLE! Large unfinished basement for future expansion space. Just 4 miles from Alpharetta's thriving Downtown or the beckoning streets of Avalon. Less than 2 miles to the New Halcyon! Gated neighborhood w/13 Acre Central Park w/Walking Trails, Clubhouse, Pool, Tennis, Playgrounds & HOA Maintained Lawns. Top-Notch Forsyth Co Schools. Best of all, this well-situated location means you can take advantage of low Forsyth taxes while enjoying a fantastic Alpharetta lifestyle! \$5,000 closing costs with preferred lender. HOA Maintained Lawns and trash. 1-2-10 year Warranty. New Denmark High School Cluster!!

**Want to Know More
About This Home?**

CONTACT OUR COMMUNITY SALES MANAGER
Call Us @ (770) 521-2151

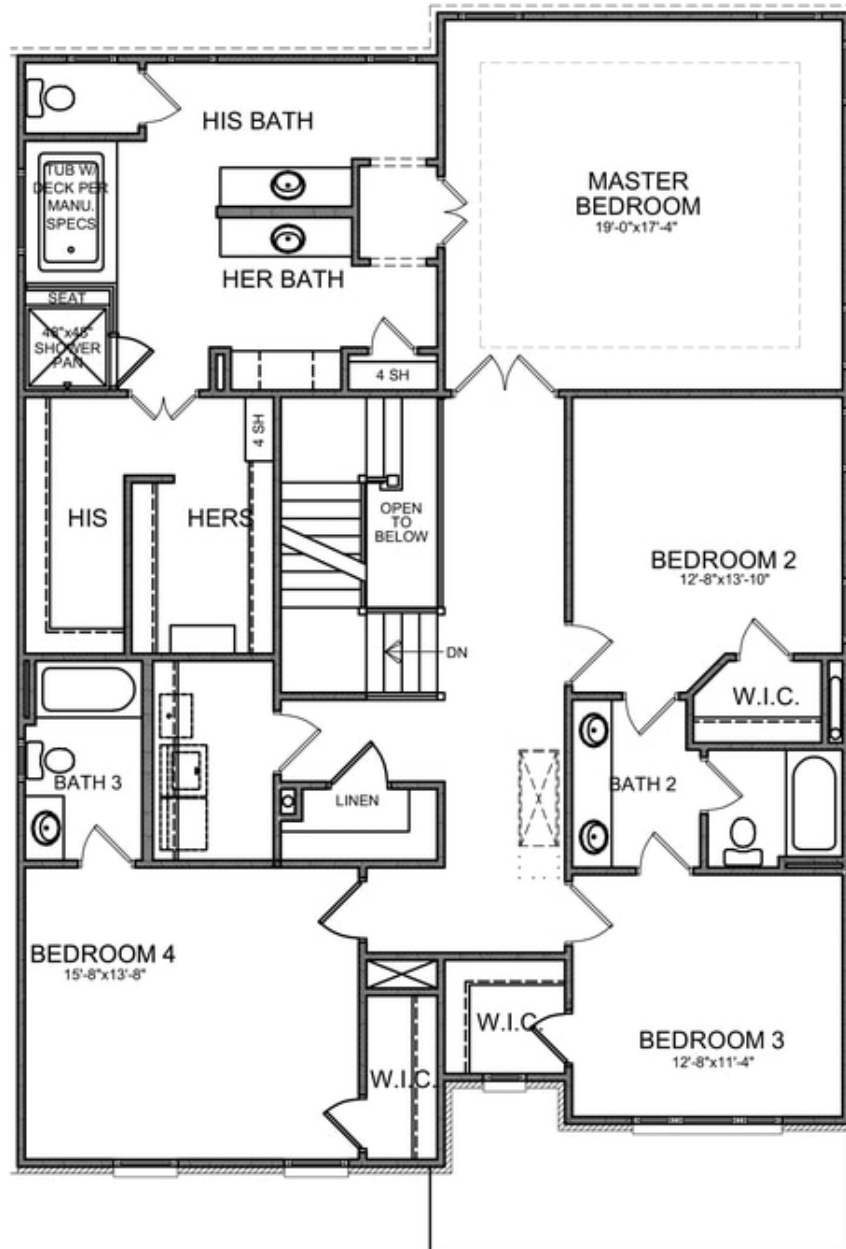

**Want to Know More
About This Home?**

CONTACT OUR COMMUNITY SALES MANAGER
Call Us @ (770) 521-2151

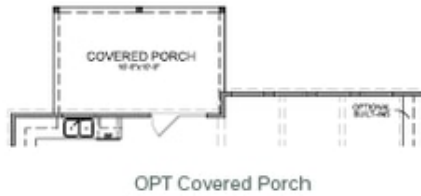
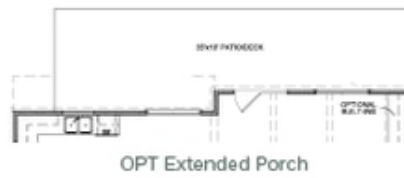
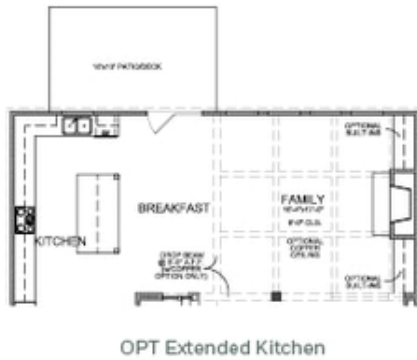

OPTIONS

Want to Know More
 About This Home?

CONTACT OUR COMMUNITY SALES MANAGER
 Call Us @ (770) 521-2151

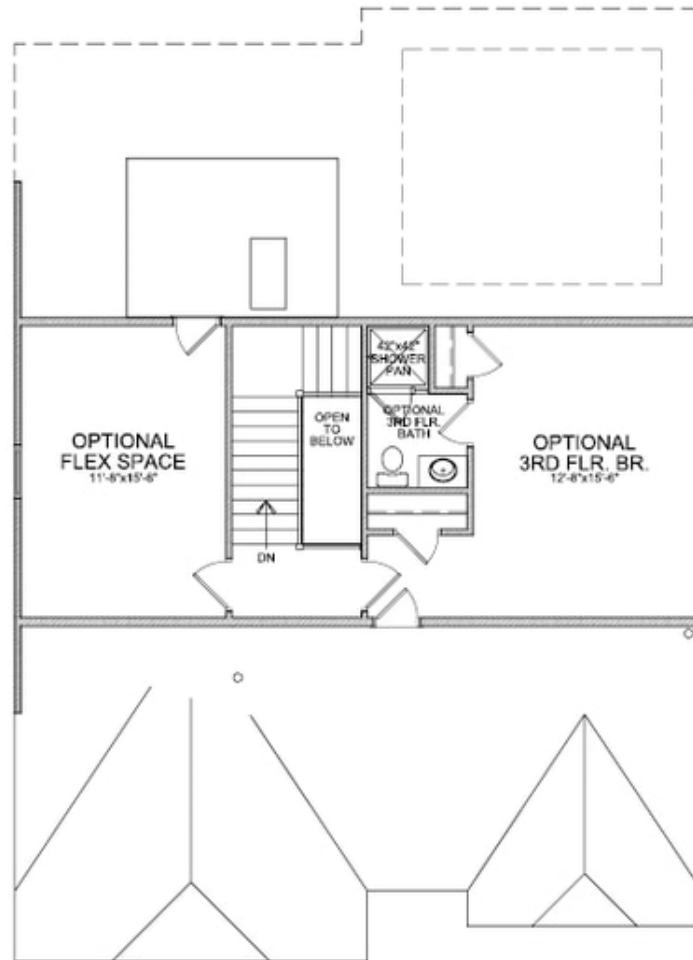

OPT Third Floor

*Third Floor NOT available on Elevations B & E

**Want to Know More
About This Home?**

CONTACT OUR COMMUNITY SALES MANAGER
Call Us @ (770) 521-2151