



PRICED AT
\$576,900

 1674 Sq Ft

 2 Beds

 2.5 Baths

 1 Car Garage

 3.0 Story

FABOLOUS FALL SAVINGSElevate your lifestyle in this new home Barnesley I Floor Plan . Astounding 2 Bedrooms and 2.5 Baths in the heart of Alpharetta, with a Terrace at the Front Entry, great for an outdoor experience , Sliding Glass Doors opens up to a Flex/ Media / Office Room with a Wet Bar , perfect for working remotely . Going upstairs Open Concept Living Room and a beautiful Kitchen with 2 islands . The Kitchen is a Award Winning Warm Stone Design Collection , with Calacatta Lavasa Quartz Countertops , 42' Light color Cabinets with Crown Molding , GE top of the line Appliances Cafe Collection , Gas Cooktop , Electrical Oven , Range Hood , Dishwasher , and Built in Microwave, creates a wonderful get together place , for friends and family . The flooring is Piedmont Hickory Hardwood . The Living Rooms is spacious with great natural light and a wooden deck . Upstairs you have 2 full Bedrooms with 2 Full Baths , with the Washer & Dryer Room locate it in the Hallway . The garage is in the Rear with one car parking space , also the Driveway could be used for additional ...

**Want to Know More
About This Home?**

CONTACT OUR COMMUNITY SALES MANAGER
Call Us @ 678.591.1930



**Want to Know More
 About This Home?**

CONTACT OUR COMMUNITY SALES MANAGER
 Call Us @ 678.591.1930

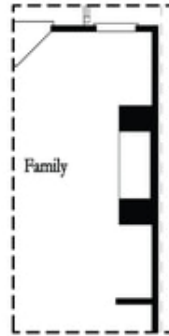

Opt. Linear Fireplace

Second Floor Options

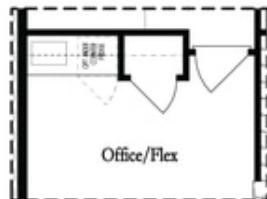

Opt. Wet Bar

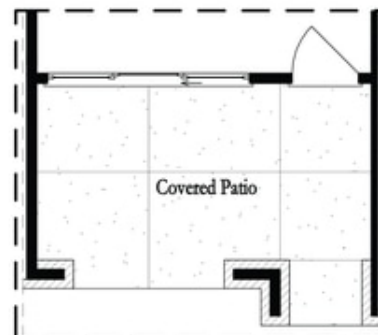

Opt. Slider Door

First Floor Options

**Want to Know More
About This Home?**

CONTACT OUR COMMUNITY SALES MANAGER
Call Us @ 678.591.1930