



PRICED AT
\$672,150

 2201 Sq Ft

 3 Beds

 2.5 Baths

 2 Car Garage

 3.0 Story

BE HOME FOR YOUR HOLIDAY MEMORIES. Welcome to ECCO PARK in Alpharetta. Vibrant neighborhood, walking distance to many restaurants, shopping centers and walking trails. Close to Avalon, Top Golf, just to mention a few. Outstanding features in a gorgeous unit. The Benton I lot 64 has a terrace level entry through a covered patio area with fireplace. The terrace level has a large media room for an extra living space. Main floor is open space concept with a beautiful kitchen, quartz countertops, crown molding, stainless steel appliances, dishwasher, gas cooktop, microwave, vent hood, electric oven, kitchen light pendants above the island. This floorplan includes a sunroom which could serve as an office or breakfast area. Off sunroom is an open deck overlooking the neighborhood. The family room has a ventless fireplace for chilly evenings. Head upstairs to the bedrooms. The large owner suite has tray ceilings, walk in closet, oversized windows. The owners bath has mega walk in shower with drying area, tile floors and walls & dual vanity. 9' feet ceilings throughout. Great schools district. Easy access to all major Highways. [The Benton I] \$5K closing assistance when finance with one of our preferred lenders

Want to Know More
About This Home?

CONTACT OUR COMMUNITY SALES MANAGER
Call Us @ 678.591.1930



TERRACE

Elevation N

Want to Know More
About This Home?

CONTACT OUR COMMUNITY SALES MANAGER
Call Us @ 678.591.1930

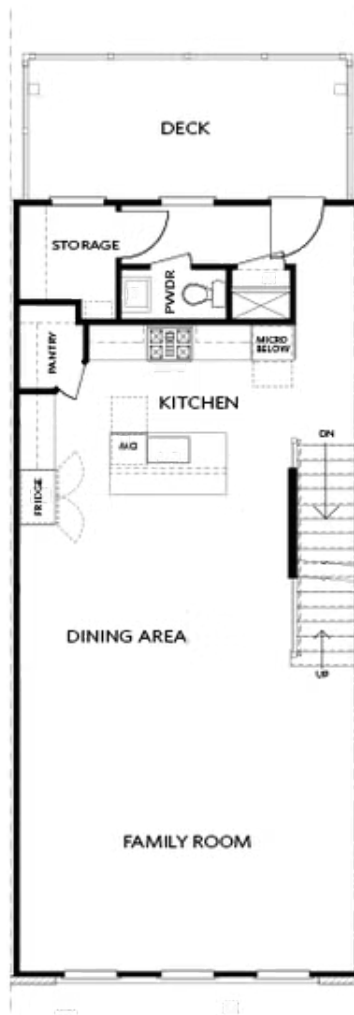

SECOND FLOOR

Elevation N

Want to Know More
About This Home?

CONTACT OUR COMMUNITY SALES MANAGER
Call Us @ 678.591.1930



THIRD FLOOR

Elevation N

Want to Know More
About This Home?

CONTACT OUR COMMUNITY SALES MANAGER
Call Us @ 678.591.1930

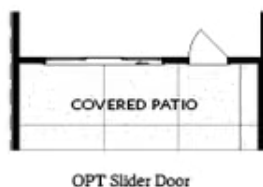

TERRACE

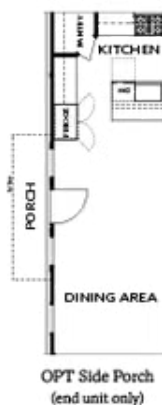

SECOND FLOOR



OPTIONS

Want to Know More
About This Home?

CONTACT OUR COMMUNITY SALES MANAGER
Call Us @ 678.591.1930



OPT Open Rail



OPT Bedroom 3 - ONLY Available
with Optional Sunroom



OPT Walk-Through Shower



OPT Freestanding
Tub/Shower Combo



OPT Decked Tub/
Shower Combo

OPTIONS

Want to Know More
About This Home?

CONTACT OUR COMMUNITY SALES MANAGER
Call Us @ 678.591.1930