



PRICED AT  
**\$729,040**

 **2201 Sq Ft**

 **3 Beds**

 **2.5 Baths**

 **2 Car Garage**

 **3.0 Story**

**Spring into a New Home with The Providence Group! Experience elevated living in a beautifully designed townhome that blends modern elegance with everyday practicality. With 3 spacious bedrooms, 2.5 bathrooms, and high-end finishes throughout, this home is built for both comfort and style. From the moment you arrive, you'll be welcomed by a private front entry, fenced-in yard, and a covered terrace—an inviting outdoor space perfect for relaxing or entertaining guests. Inside, the entry-level features a flexible office or media room with dual access via a front door and sliding glass door, offering a light-filled, adaptable space. On the main floor, the open-concept design creates a seamless flow between the living, dining, and kitchen areas. The centerpiece kitchen showcases a large island with Calacatta Sierra Quartz countertops, 42" cabinets with crown molding, and soft-close doors. Premium GE stainless steel appliances—including a gas range, built-in microwave, range hood, and dishwasher—complete the space. A private wooden deck extends your living space outdoors, perfect for unwinding or entertaining. Upstairs, retreat to the luxurious owner's suite with a spa-inspired bathroom, alongside a two secondary bedrooms with their own private deck. ?? Unbeatable Location - Ideally situated just moments from Avalon, Downtown Alpharetta, and within ...**

**Want to Know More  
About This Home?**

**CONTACT OUR COMMUNITY SALES MANAGER**  
**Call Us @ 678.472.0411**

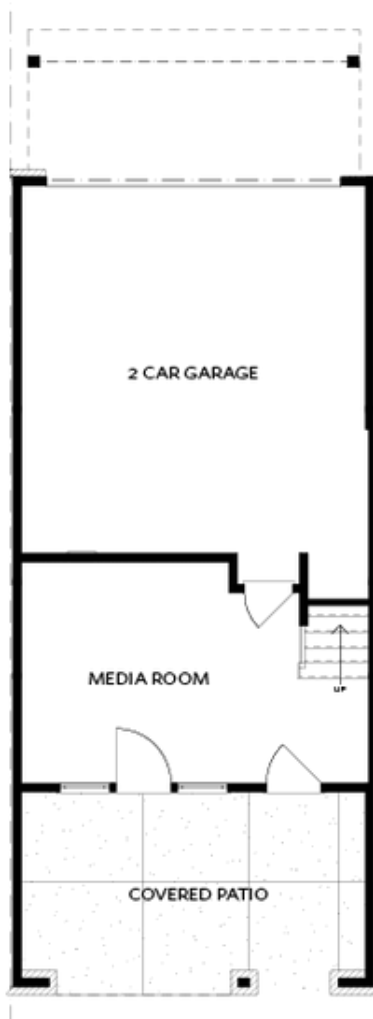

TERRACE

Elevation N

Want to Know More  
About This Home?

CONTACT OUR COMMUNITY SALES MANAGER  
Call Us @ 678.472.0411

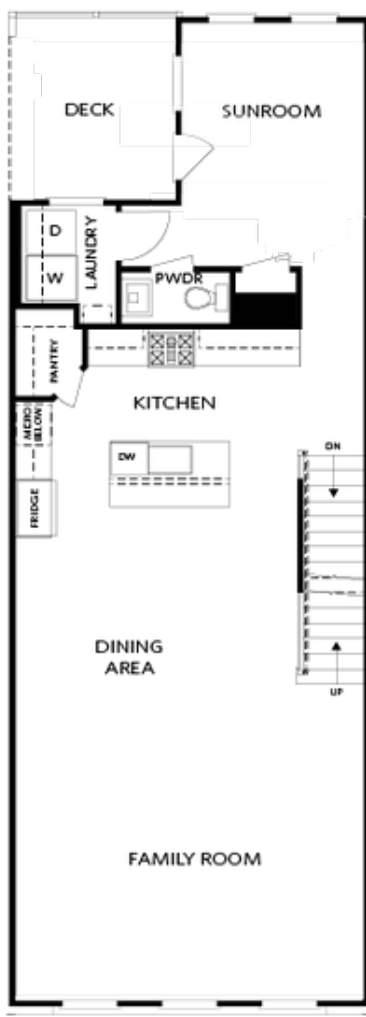

SECOND FLOOR  
W. OPT SUNROOM

Elevation N

Want to Know More  
About This Home?

CONTACT OUR COMMUNITY SALES MANAGER  
Call Us @ 678.472.0411



THIRD FLOOR  
W. OPT BEDROOM 3

Elevation N

Want to Know More  
About This Home?

**CONTACT OUR COMMUNITY SALES MANAGER**  
**Call Us @ 678.472.0411**



OPT Patio Fireplace

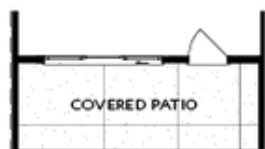

OPT Slider Door

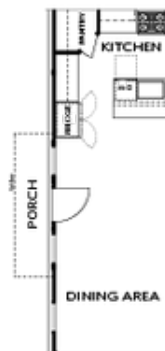

OPT Side Porch  
(end unit only)



OPT Left Side  
Linear Fireplace



OPT Left Side  
Fireplace



OPT Right Side  
Fireplace



OPT Right Side  
Linear Fireplace

## TERRACE

## SECOND FLOOR

## OPTIONS

Want to Know More  
About This Home?

CONTACT OUR COMMUNITY SALES MANAGER  
Call Us @ 678.472.0411

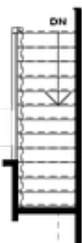

OPT Open Rail



OPT Walk-Through Shower



OPT Freestanding  
Tub/Shower Combo



OPT Decked Tub/  
Shower Combo

### THIRD FLOOR

### OPTIONS

Want to Know More  
About This Home?

CONTACT OUR COMMUNITY SALES MANAGER  
Call Us @ 678.472.0411