

PRICED AT
\$729,040

 2145 Sq Ft

 3 Beds

 2.5 Baths

 2 Car Garage

 3.0 Story

Spring into a New Home with The Providence Group! Experience elevated living in a beautifully designed townhome that blends modern elegance with everyday practicality. With 3 spacious bedrooms, 2.5 bathrooms, and high-end finishes throughout, this home is built for both comfort and style. From the moment you arrive, you'll be welcomed by a private front entry, fenced-in yard, and a covered terrace—an inviting outdoor space perfect for relaxing or entertaining guests. Inside, the entry-level features a flexible office or media room with dual access via a front door and sliding glass door, offering a light-filled, adaptable space. On the main floor, the open-concept design creates a seamless flow between the living, dining, and kitchen areas. The centerpiece kitchen showcases a large island with Calacatta Sierra Quartz countertops, 42" cabinets with crown molding, and soft-close doors. Premium GE stainless steel appliances—including a gas range, built-in microwave, range hood, and dishwasher—complete the space. A private wooden deck extends your living space outdoors, perfect for unwinding or entertaining. Upstairs, retreat to the luxurious owner's suite with a spa-inspired bathroom, alongside two secondary bedrooms with their own private deck. Unbeatable Location - Ideally situated just moments from Avalon, Downtown Alpharetta, and within walking distance ...

**Want to Know More
About This Home?**

CONTACT OUR COMMUNITY SALES MANAGER
Call Us @ 770.846.7164

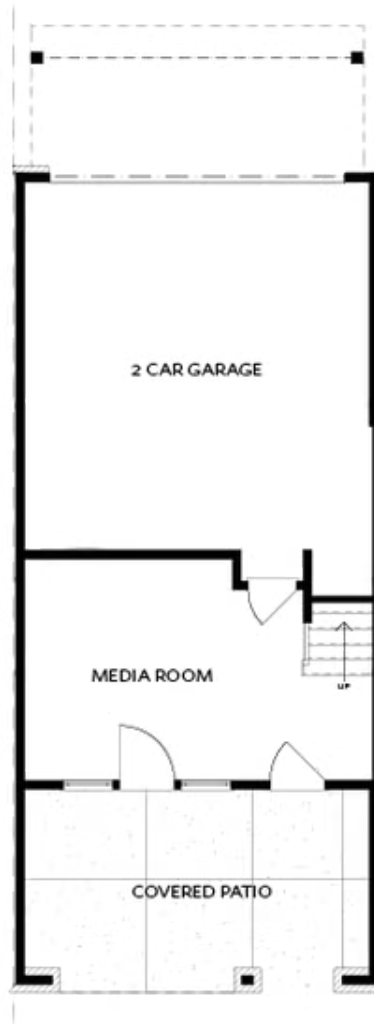

TERRACE

Elevation N

Want to Know More
About This Home?

CONTACT OUR COMMUNITY SALES MANAGER
Call Us @ 770.846.7164

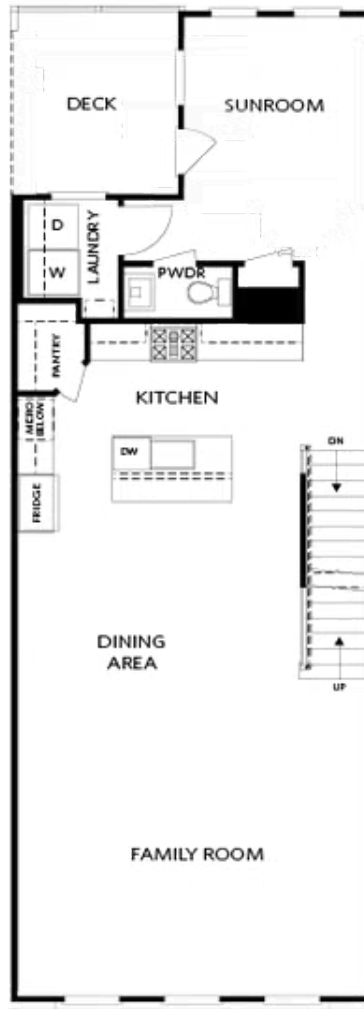

SECOND FLOOR
W. OPT SUNROOM

Elevation N

Want to Know More
About This Home?

CONTACT OUR COMMUNITY SALES MANAGER
Call Us @ 770.846.7164



THIRD FLOOR
W. OPT BEDROOM 3

Elevation N

Want to Know More
About This Home?

CONTACT OUR COMMUNITY SALES MANAGER
Call Us @ 770.846.7164

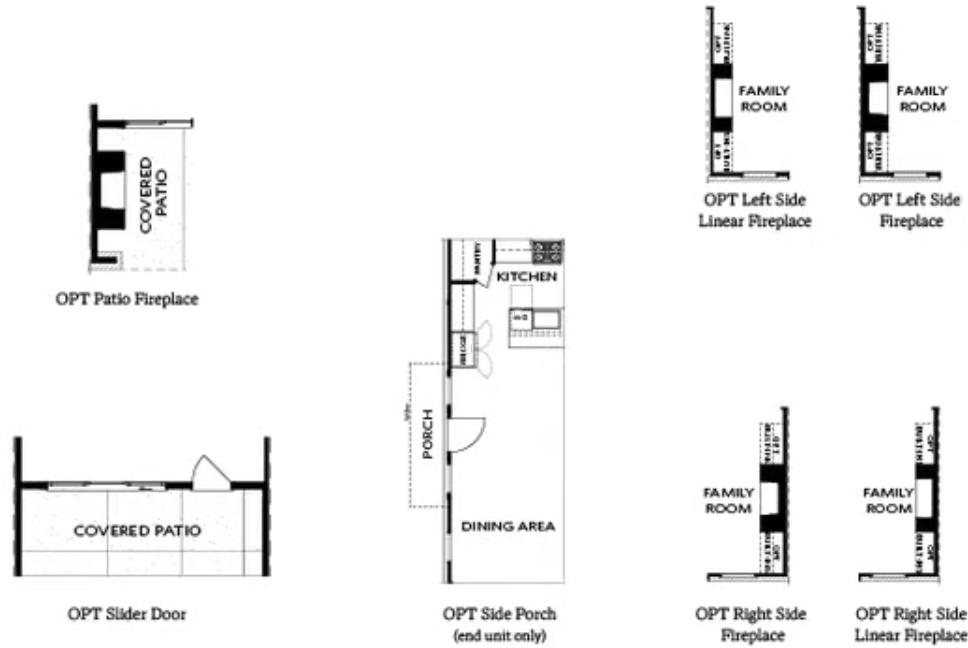

TERRACE

SECOND FLOOR

OPTIONS

Want to Know More
 About This Home?

CONTACT OUR COMMUNITY SALES MANAGER
 Call Us @ 770.846.7164



OPT Open Rail



OPT Walk-Through Shower



OPT Freestanding
Tub/Shower Combo



OPT Decked Tub/
Shower Combo

THIRD FLOOR

OPTIONS

Want to Know More
About This Home?

CONTACT OUR COMMUNITY SALES MANAGER
Call Us @ 770.846.7164