





PRICED AT  
**\$690,370**

-  2145 Sq Ft
-  3 Beds
-  2.5 Baths
-  2 Car Garage
-  3.0 Story

"New Year, New Home" - Enjoy \$ 45,000 (already include in price) promotion on contracts written by end of January. Promotion can be applied towards a price reduction, closing costs, rate buydown and more giving you the flexibility to save where it matters most. Plus an additional \$10,000 towards Closing Costs with our Preferred Lenders. Ends January 31, 2026. - The Benton I by The Providence Group! QUICK MOVE-IN! - Discover elevated living in a thoughtfully designed townhome that perfectly balances modern elegance and everyday functionality. Featuring 3 spacious bedrooms, 2.5 bathrooms, and upscale finishes throughout, this home is built with both comfort and style in mind. From the moment you arrive, you'll be greeted by a private front entry, a fenced-in yard, and a covered terrace with an outdoor fireplace—an ideal spot for relaxing or entertaining. The entry-level includes a versatile flex room that can serve as a home office or media room, complete with front and sliding glass doors that let in plenty of natural light. Upstairs, the open-concept main floor seamlessly connects the living, dining, and kitchen areas. The stunning kitchen is the heart of the home, featuring a large island with Quartz countertops, 42" cabinets ...

**Want to Know More  
About This Home?**

CONTACT OUR COMMUNITY SALES MANAGER  
Call Us @ 770.846.7164

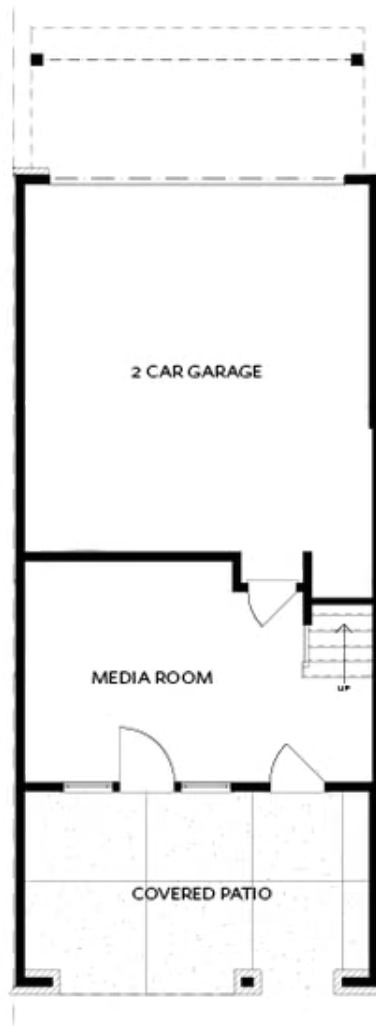

TERRACE

Elevation N

Want to Know More  
About This Home?

CONTACT OUR COMMUNITY SALES MANAGER  
Call Us @ 770.846.7164

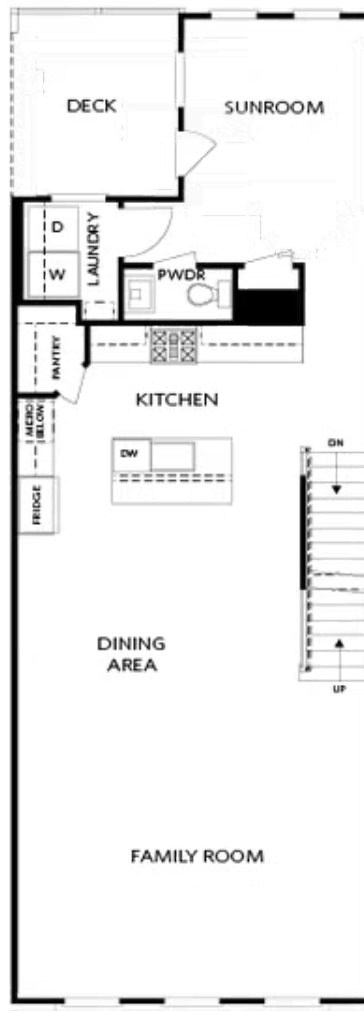

SECOND FLOOR  
W. OPT SUNROOM

Elevation N

Want to Know More  
About This Home?

CONTACT OUR COMMUNITY SALES MANAGER  
Call Us @ 770.846.7164



THIRD FLOOR  
W. OPT BEDROOM 3

Elevation N

Want to Know More  
About This Home?

CONTACT OUR COMMUNITY SALES MANAGER  
Call Us @ 770.846.7164

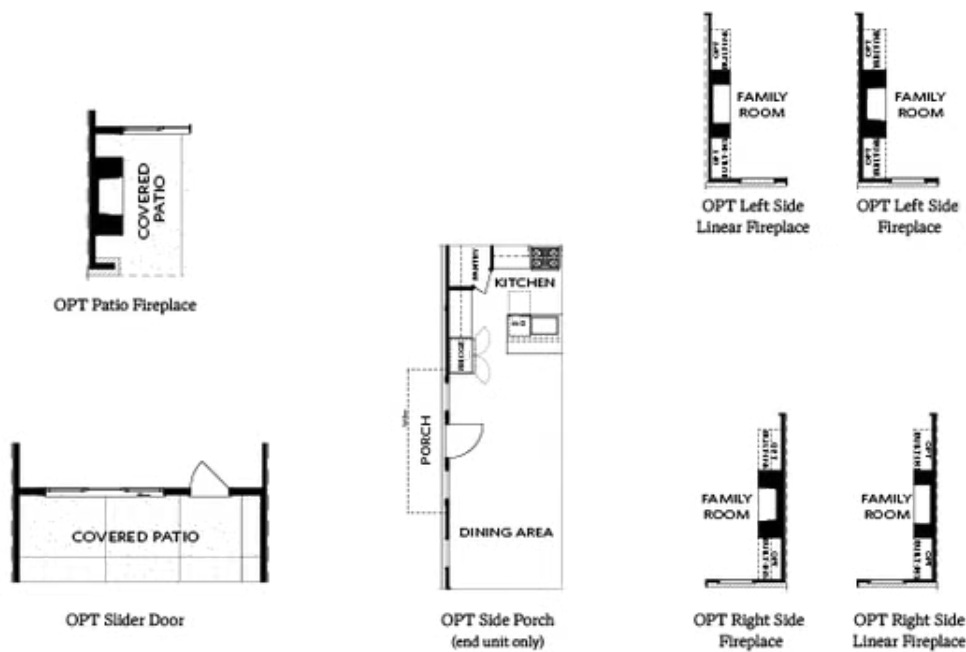

## TERRACE

## SECOND FLOOR

## OPTIONS

Want to Know More  
About This Home?

CONTACT OUR COMMUNITY SALES MANAGER  
Call Us @ 770.846.7164

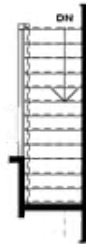

OPT Open Rail



OPT Walk-Through Shower



OPT Freestanding  
Tub/Shower Combo



OPT Decked Tub/  
Shower Combo

### THIRD FLOOR

### OPTIONS

Want to Know More  
About This Home?

CONTACT OUR COMMUNITY SALES MANAGER  
Call Us @ 770.846.7164