



PRICED FROM
\$677,900

 **1,955 - 2,201 Sq Ft**

 **2 - 3 Beds**

 **2.5 Baths**

 **2 Car Garage**

 **3.0 Story**

- **Gourmet Kitchen with Island**
- **Owner's Suite and Private Bath with Dual Vanities and Large Walk-In Shower**
- **Media room on Terrace Level**
- **Covered Porch**
- **Two Car Garage**

[Read More Online](#)

Available Elevations



**Benton I and Barnsley I -
Elevation**

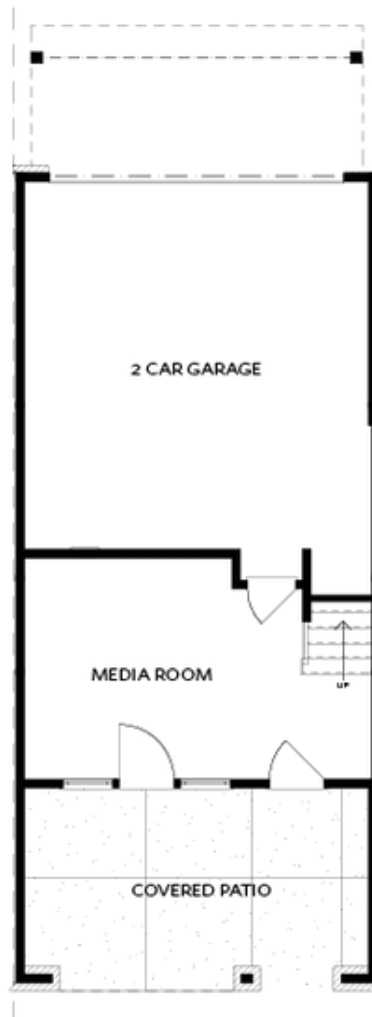

TERRACE

Elevation N

Want to Know More
About This Home?

CONTACT OUR COMMUNITY SALES MANAGER
Call Us @ 770.846.7164

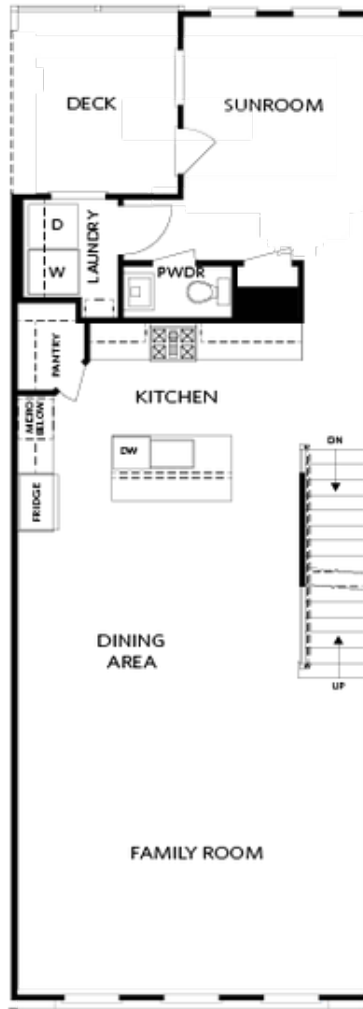

SECOND FLOOR
W. OPT SUNROOM

Elevation N

Want to Know More
About This Home?

CONTACT OUR COMMUNITY SALES MANAGER
Call Us @ 770.846.7164



THIRD FLOOR
W. OPT BEDROOM 3

Elevation N

Want to Know More
About This Home?

CONTACT OUR COMMUNITY SALES MANAGER
Call Us @ 770.846.7164

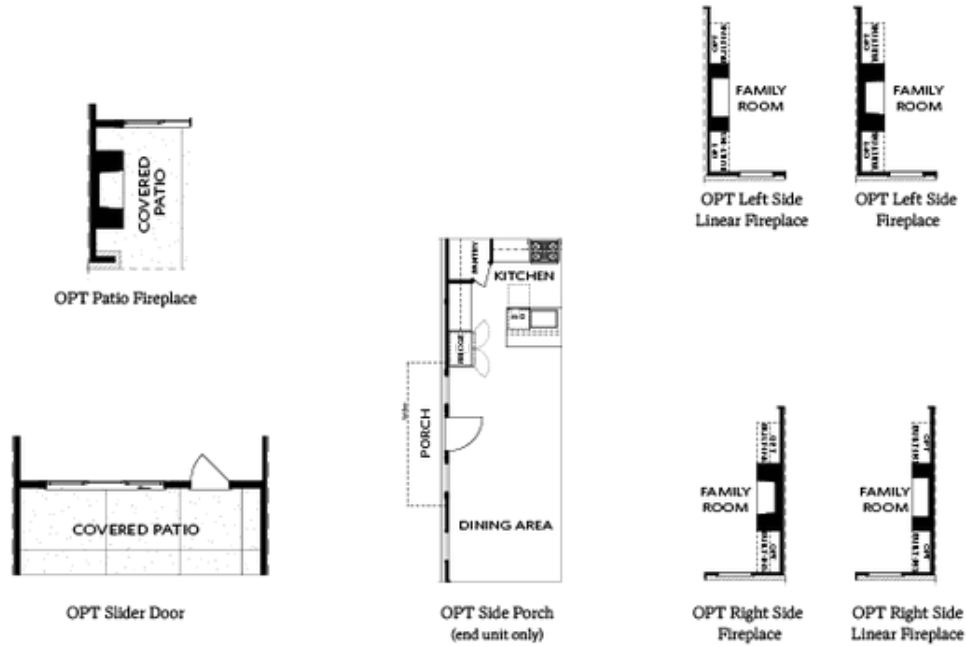

TERRACE

SECOND FLOOR

OPTIONS

Want to Know More
 About This Home?

CONTACT OUR COMMUNITY SALES MANAGER
 Call Us @ 770.846.7164



OPT Open Rail



OPT Walk-Through Shower



OPT Freestanding
Tub/Shower Combo



OPT Decked Tub/
Shower Combo

THIRD FLOOR

OPTIONS

Want to Know More
About This Home?

CONTACT OUR COMMUNITY SALES MANAGER
Call Us @ 770.846.7164