



PRICED FROM
\$722,900

 2,400 Sq Ft

 4 Beds

 3.5 Baths

 2 Car Garage

 3.0 Story

- Terrace Entry with a Large Foyer
- Bedroom, Full Bath and Walk-In Closet on the Terrace
- Open Main Level where the Kitchen Overlooks the Dining Area and Family Room
- Laundry Room Behind the Kitchen along with the Power Room, Sunroom with access to a Private Deck
- L-Shaped Gourmet Kitchen with Kitchen Island Perfect for Serving Meals or Enjoying Breakfast
- Second Floor Features Owner's Suite, and Two Secondary Bedrooms with a shared hall bath
- Owner's Suite Features a Sizeable Walk-In Closet, Dual Vanity, a Large Shower & a Private Water Closet

• 2 Car Garage

[Read More Online](#)

Available Elevations





Elevation S2

Want to Know More
About This Home?

CONTACT OUR COMMUNITY SALES MANAGER
Call Us @ 770.846.7164



Elevation S2

Want to Know More
About This Home?

CONTACT OUR COMMUNITY SALES MANAGER
Call Us @ 770.846.7164



Elevation S2

Want to Know More
About This Home?

CONTACT OUR COMMUNITY SALES MANAGER
Call Us @ 770.846.7164

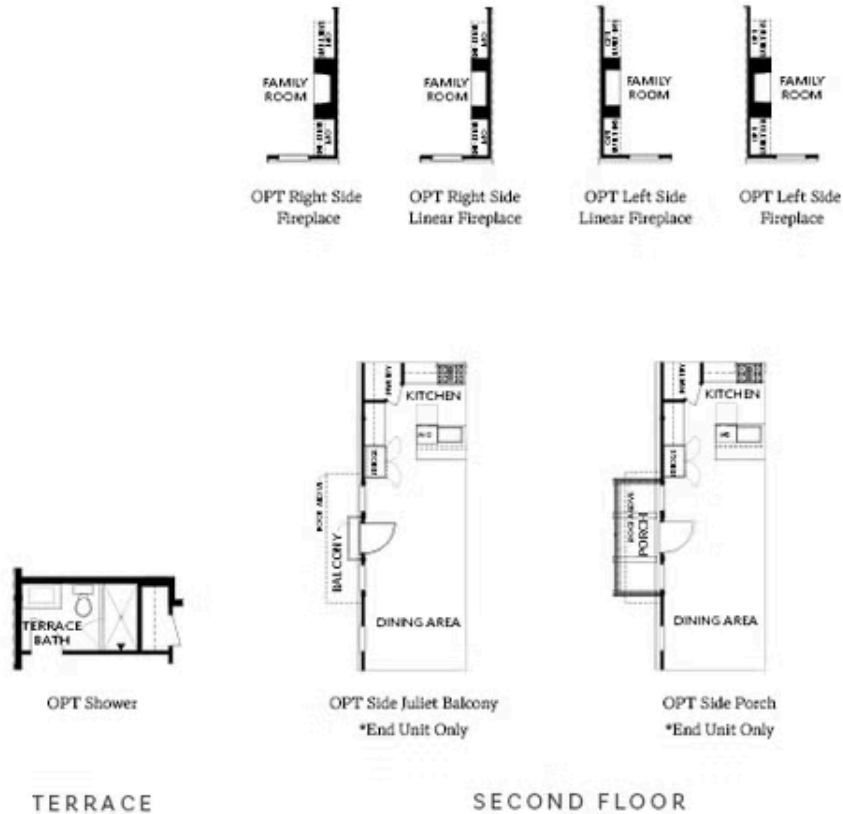

Want to Know More
About This Home?

CONTACT OUR COMMUNITY SALES MANAGER
Call Us @ 770.846.7164

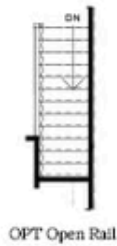

OPT Walk-Through Shower



OPT Freestanding Tub with
Separate Shower



OPT Decked Tub with
Separate Shower

Want to Know More
About This Home?

CONTACT OUR COMMUNITY SALES MANAGER
Call Us @ 770.846.7164