



PRICED AT  
**\$919,195**

 2117 Sq Ft

 3 Beds

 3.5 Baths

 2 Car Garage

 3.0 Story

Elevate your life in 2023! The Chamberlain Home Design features 3 Bed / 3.5 Bath ~ FIREPLACE ~ WALK THROUGH SHOWER ~ ACCENT TRIM WALL ON ENTRY FOYER ~ ACCENT TRIM WALL IN OWNERS BEDROOM ~ CUSTOM CLOSETS ~ Towns on Thompson- a boutique community of 48 townhomes combining luxury living with exclusive locality. Ideally situated on Thompson Street separating Downtown Alpharetta from Avalon, the possibilities are endless in the heart of vibrant Alpharetta! New Construction directly on Thompson Street! Guest welcome to park on Thompson Street as they enter you front stoop to arrive immediately at your open concept main level featuring 10 ft ceilings & Hardwoods Throughout ALL of home. Bright and Open Kitchen mindfully situated in the front of home accompanied by a 7 ft bay window. Bright White stacked cabinets to the ceiling paired with modern Driftwood Island with Cambria Quartz Countertop. GE Café Appliances including a gorgeous 36" Commercial Range w/ Gas Oven + Modern Designer Hood Vent + Café Dishwasher + Microwave Drawer Oven. Dining space separates kitchen from your living room featuring a modern FIREPLACE with Shiplap Surround. TV Bracing, Smart Tubes, Media Outlets, and Wireless Access Points have been installed for easy ...

**Want to Know More  
About This Home?**

CONTACT OUR COMMUNITY SALES MANAGER  
Call Us @ 470.248.2777



BASEMENT

Elevation R

Want to Know More  
About This Home?

CONTACT OUR COMMUNITY SALES MANAGER  
Call Us @ 470.248.2777



SECOND FLOOR

Elevation R

Want to Know More  
About This Home?

CONTACT OUR COMMUNITY SALES MANAGER  
Call Us @ 470.248.2777

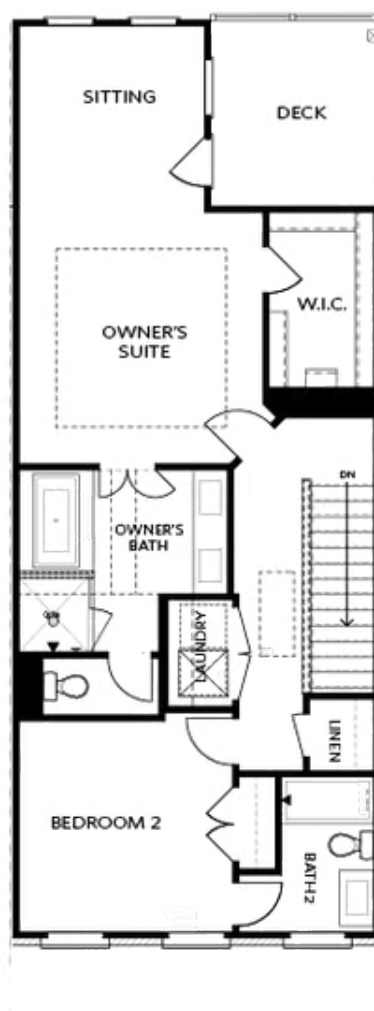

THIRD FLOOR

Elevation R

Want to Know More  
About This Home?

CONTACT OUR COMMUNITY SALES MANAGER  
Call Us @ 470.248.2777



OPT Shower

BASEMENT



OPT Linear Fireplace



OPT Fireplace

SECOND FLOOR



OPT Open Rail



OPT Walk-Through Shower



OPT Freestanding Tub/Shower Combo

THIRD FLOOR

OPTIONS

Want to Know More  
About This Home?

CONTACT OUR COMMUNITY SALES MANAGER  
Call Us @ 470.248.2777