



PRICED AT  
**\$1,033,780**

 **2325 Sq Ft**

 **4 Beds**

 **3.5 Baths**

 **2 Car Garage**

 **3.0 Story**

**MOVE IN READY NEW CONSTRUCTION!!! Elevate your life in 2023 with a new home by The Providence Group and \$5,000 towards closing cost! The Chaucer Home Design features 4 Bed / 3.5 Bath ~ FIREPLACE W/ BUILT IN'S ~ BRICK ACCENT WALL ~ MASSIVE WALK THROUGH SHOWER ~ FENCED IN BACKYARD ~ DESIGNER CURATED FINISHES ~ Towns on Thompson- a boutique community of 48 townhomes combining luxury living with exclusive locality. Ideally situated on Thompson Street separating Downtown Alpharetta from Avalon, the possibilities are endless in the heart of vibrant Alpharetta! This beautiful home design sits over 25 ft wide with windows on your main level, truly making this space feel abundantly bright, spacious, and open! Enjoy Hardwoods Throughout the home, 10 ft ceilings + oversized, split staircases featuring open railing providing views to your front door Foyer (perfect for statement foyer chandelier). Kitchen is mindfully situated in the rear of home overlooking HOA Maintained backyard & pocket park. Home Site 19 features stacked white cabinets to the ceiling, modern willow gray island with Cambria Quartz Countertops, Farmhouse Sink, and Custom Pantry Shelving. Dinner Party prep made easy with GE Café Appliances including a gorgeous 36" Commercial Range w/ Gas ...**

**Want to Know More  
About This Home?**

**CONTACT OUR COMMUNITY SALES MANAGER**  
**Call Us @ 470.248.2777**



**Want to Know More  
About This Home?**

**CONTACT OUR COMMUNITY SALES MANAGER**  
**Call Us @ 470.248.2777**

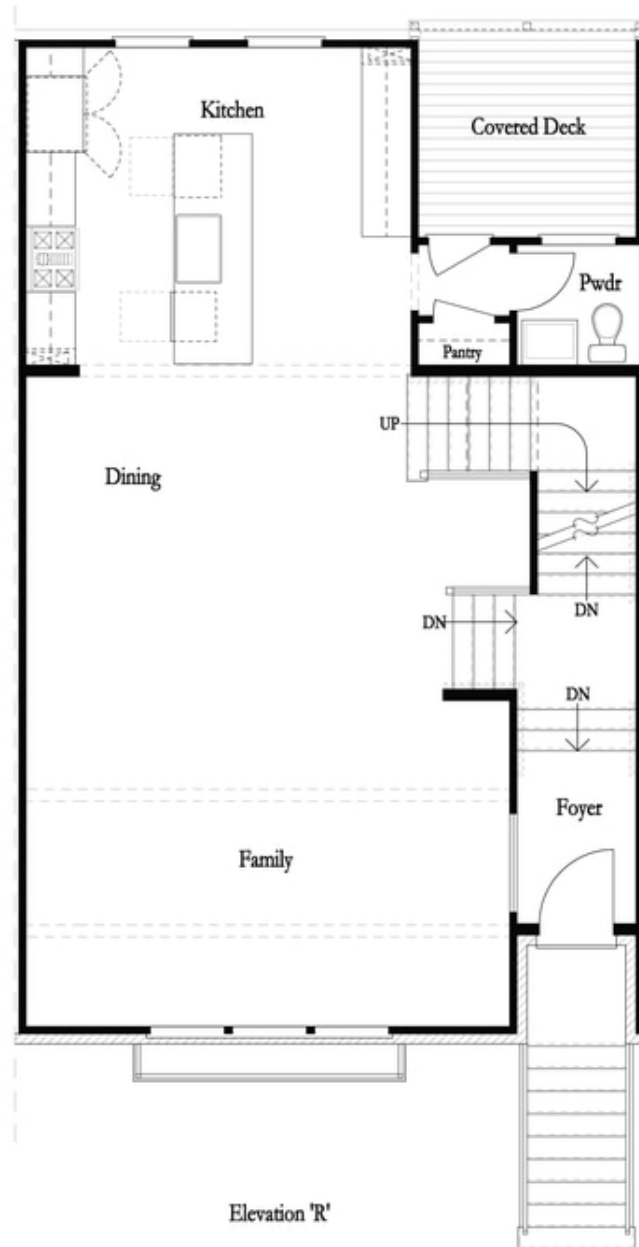

**Want to Know More  
About This Home?**

**CONTACT OUR COMMUNITY SALES MANAGER**  
**Call Us @ 470.248.2777**

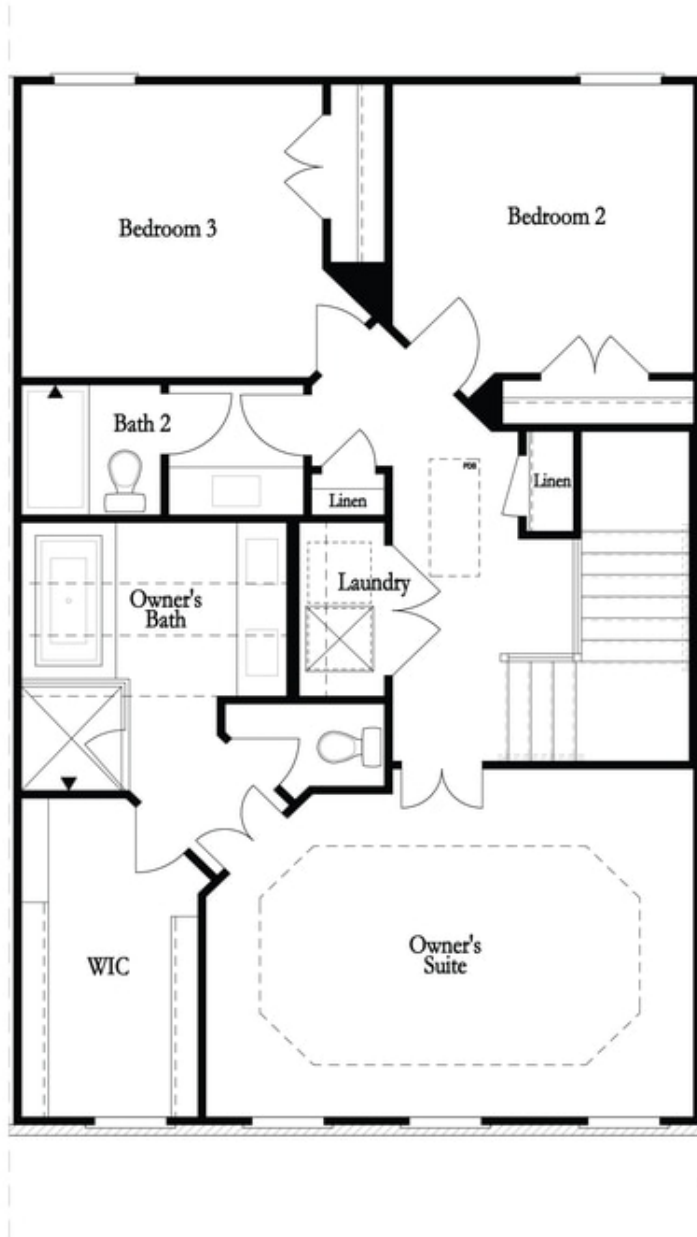

**Want to Know More  
About This Home?**

**CONTACT OUR COMMUNITY SALES MANAGER**  
**Call Us @ 470.248.2777**

Options

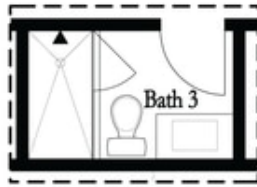

Optional Shower

First Floor Options



Optional Walk Through Shower

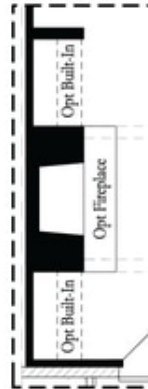

Optional Fireplace

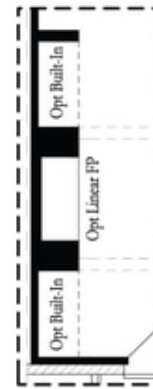

Optional Fireplace  
 Linear

Second Floor Options



Optional Free Standing Tub  
 with Shower

Third Floor Options

**Want to Know More  
 About This Home?**

**CONTACT OUR COMMUNITY SALES MANAGER**  
 Call Us @ 470.248.2777