



PRICED AT
\$988,340

 **2325 Sq Ft**

 **4 Beds**

 **3.5 Baths**

 **2 Car Garage**

 **3.0 Story**

New Year, New Home, New You! ~Elevate your life in 2024 with a new home by The Providence Group and \$20,000 Any Way You Want for Contracts Closed By February with 1 of our 5 Preferred Lenders! The Chaucer Home Design is our largest plan sitting well over 25+ ft wide featuring 4 bedrooms & 3.5 bathrooms. Enjoy the wide split stair cases creating a dramatic raised foyer leading to the living room nestled in in the front of home with 3, 5 ft' bay windows. The 10 ft ceilings are sure to make your space bright and airy. Our dining area defines space, ideally situated in the middle of the room with 2 bump outs- perfect for an accent wall (brick, shiplap, geometric design) or dry bar area. The heart of the home is positioned in the back of the plan as everyone always gathers in the kitchen. Our oversized island is braced for a waterfall island. Kitchen cabinets and appliances sit on both walls creating plenty of storage space. Covered deck sit in the back of home catching South West sunsets. Wrapped stairs lead you to the upper level with guest bedroom 2 & 3 with full bathroom. ...

**Want to Know More
About This Home?**

CONTACT OUR COMMUNITY SALES MANAGER
Call Us @ 470.248.2777



Want to Know More
About This Home?

CONTACT OUR COMMUNITY SALES MANAGER
Call Us @ 470.248.2777

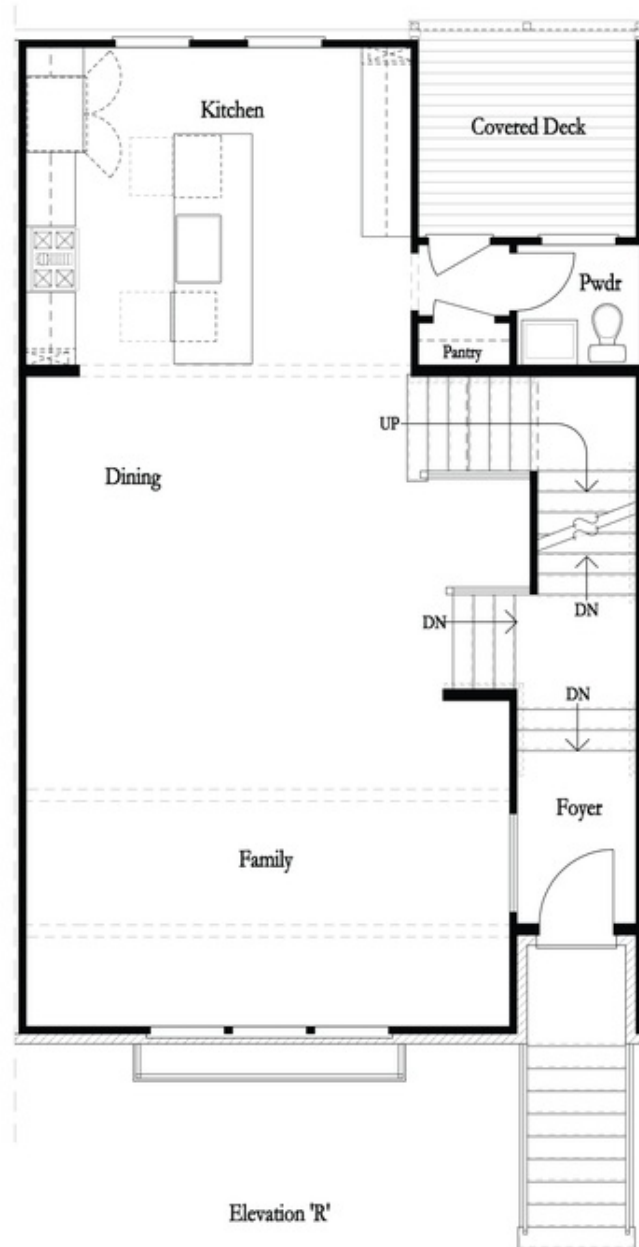

Want to Know More
About This Home?

CONTACT OUR COMMUNITY SALES MANAGER
Call Us @ 470.248.2777

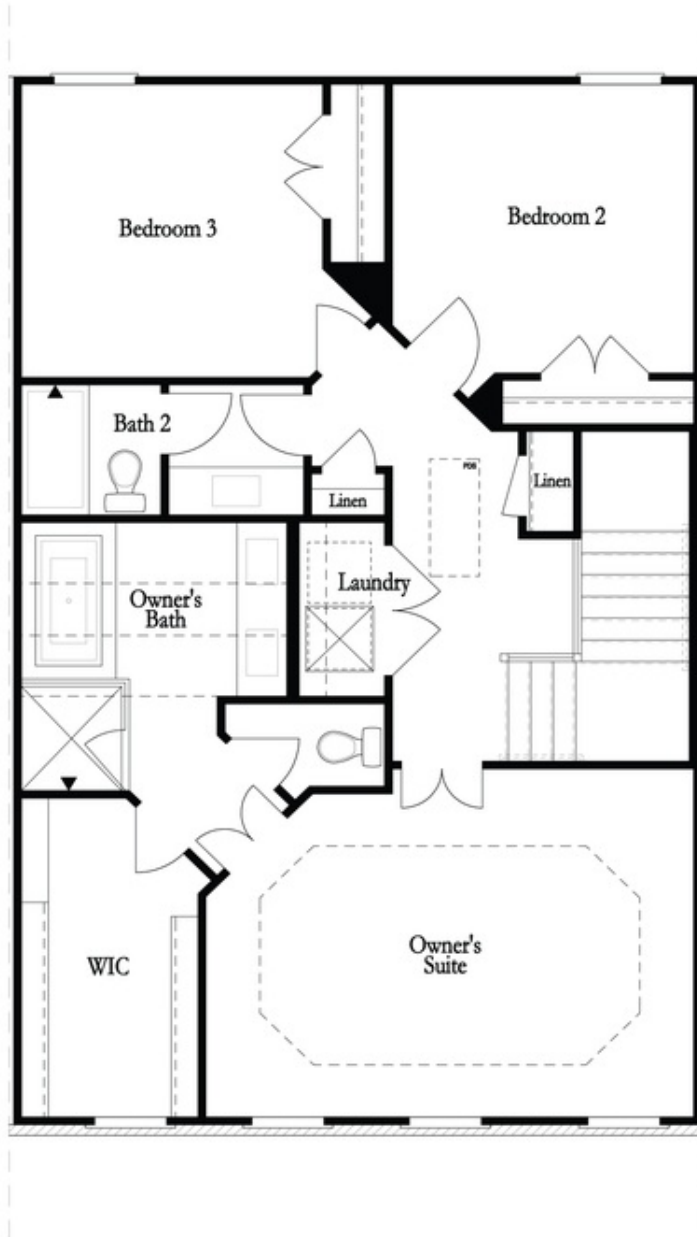

Want to Know More
About This Home?

CONTACT OUR COMMUNITY SALES MANAGER
Call Us @ 470.248.2777

Options

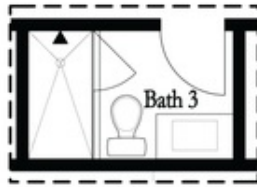

Optional Shower

First Floor Options



Optional Walk Through Shower

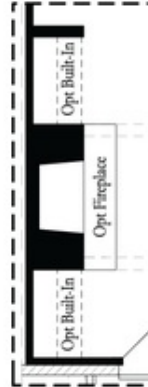

Optional Fireplace

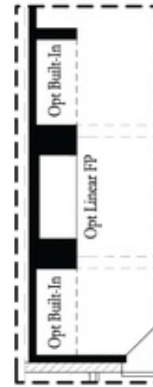

Optional Fireplace
 Linear

Second Floor Options

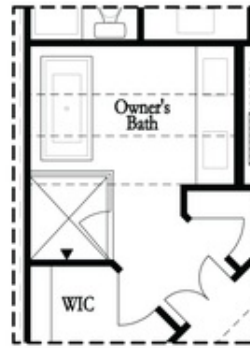

Optional Free Standing Tub
 with Shower

Third Floor Options

Want to Know More
 About This Home?

CONTACT OUR COMMUNITY SALES MANAGER
 Call Us @ 470.248.2777