



PRICED AT
\$524,900

 1484 Sq Ft

 2 Beds

 2.0 Baths

 1 Car Garage

 2.0 Story

Summer of Savings!! ***NOW FOR A LIMITED TIME ONLY!!!*** ~~~ Ask about our \$30K Anyway You Want It on purchase agreements written by the end of June 2025. Live on the Beltline! Welcome to Grant Place, a BRAND-NEW boutique community that offers a private garage and elevator service to your one level living home. Let's walk through the lavish upgrades and distinctive features that define this gorgeous home. This home is a top floor unit facing Northwest offering beautiful evening sunsets. Each home features timeless finish collections that include 42-inch wood upper cabinetry, soft close doors, under cabinet lighting, Cambria quartz countertops, durable solid surface flooring, tiled bathrooms, raised vanities, Delta fixtures and GE Café SS Appliances. The open-concept layout seamlessly connects the living, dining, and kitchen areas, fostering a sense of spaciousness and unity. As you approach the entrance, be greeted by an expansive foyer with wood flooring that will lead you into your light filled home, a living area with plenty of wall space to display art or your large screen TV, slide open your balcony door to dine alfresco on the covered balcony, step into one of the 2 bedrooms that sit apart from one another to ...

Want to Know More
About This Home?

CONTACT OUR COMMUNITY SALES MANAGER
Call Us @ 470.955.0875



2ND FLOOR	UNIT 1612 1712 1812
3RD FLOOR	UNIT 1613 1713 1813
4TH FLOOR	UNIT 1614 1714 1814

Want to Know More
About This Home?

CONTACT OUR COMMUNITY SALES MANAGER
Call Us @ 470.955.0875



2ND FLOOR	UNIT 1912		2012		2112
3RD FLOOR	UNIT 1913		2013		2113
4TH FLOOR	UNIT 1914		2014		2114

Want to Know More
About This Home?

CONTACT OUR COMMUNITY SALES MANAGER
Call Us @ 470.955.0875

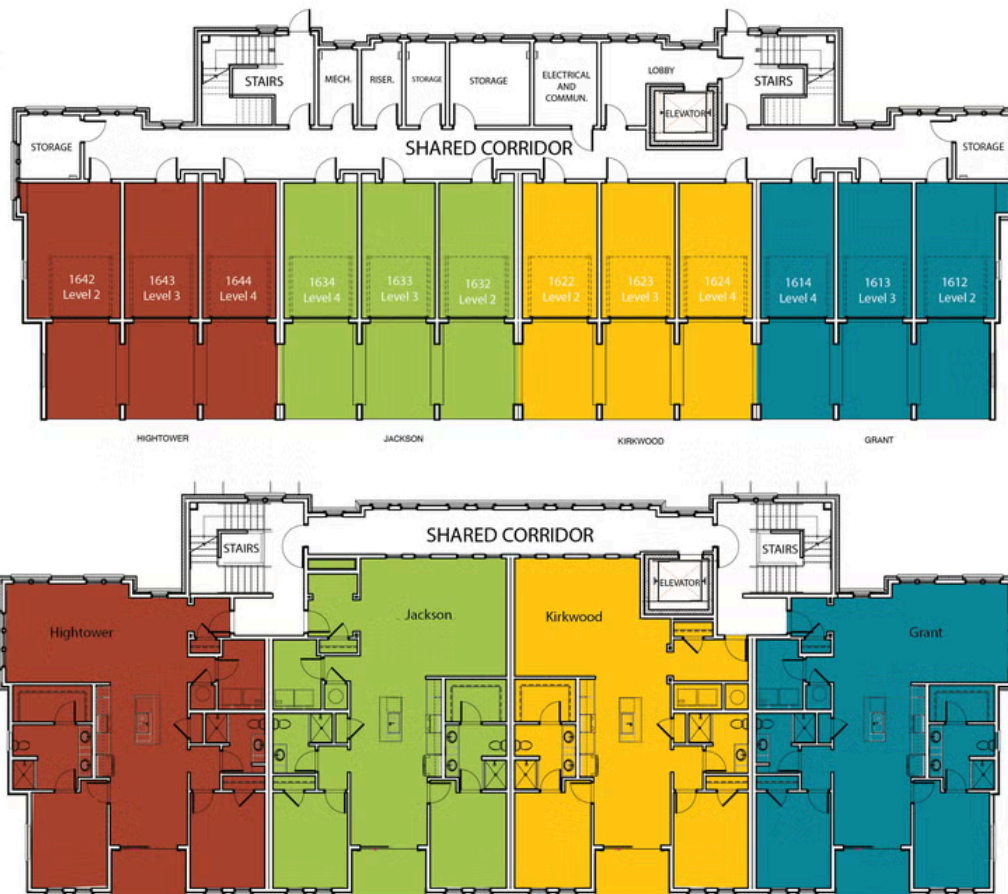

Want to Know More
About This Home?

CONTACT OUR COMMUNITY SALES MANAGER
Call Us @ 470.955.0875



Want to Know More
About This Home?

CONTACT OUR COMMUNITY SALES MANAGER
Call Us @ 470.955.0875