



PRICED AT
\$474,900

 1480 Sq Ft

 2 Beds

 2.0 Baths

 1 Car Garage

 2.0 Story

SIZZLING SUMMER SAVINGS*NOW FOR A LIMITED TIME ONLY!!!*** ~~~ \$10,000 towards Closing Costs when you use one of our Preferred Lenders!! Grant Place is a BRAND NEW boutique community that offers elevator service to your one level living home. Welcome to our model home of The Kirkwood floorplan, Unit 1722! The open-concept layout seamlessly connects the living, dining, and kitchen areas, creating a sense of spaciousness and unity. Upon entry, you will be greeted by an expansive foyer with wood flooring that will lead you into your light filled home and a living area with plenty of wall space to display art or your large screen TV. Slide open your balcony door to enjoy quiet dining on the covered balcony. Step into one of the 2 bedrooms that sit apart from one another to give way for privacy. These spaces are all designed for you to entertain or relax after a long day. Each home offers a private one car garage and a second one car covered carport. Our exquisitely designed KIRKWOOD floorplan, where sophistication meets modern luxury in a seamless blend of architectural innovation. This newly constructed design stands as a testament to superior craftsmanship and attention to detail, ...**

**Want to Know More
About This Home?**

CONTACT OUR COMMUNITY SALES MANAGER
Call Us @ 470.955.0875



2ND FLOOR	UNIT 1622		1722		1822
3RD FLOOR	UNIT 1623		1723		1823
4TH FLOOR	UNIT 1624		1724		1824

**Want to Know More
 About This Home?**

CONTACT OUR COMMUNITY SALES MANAGER
 Call Us @ 470.955.0875

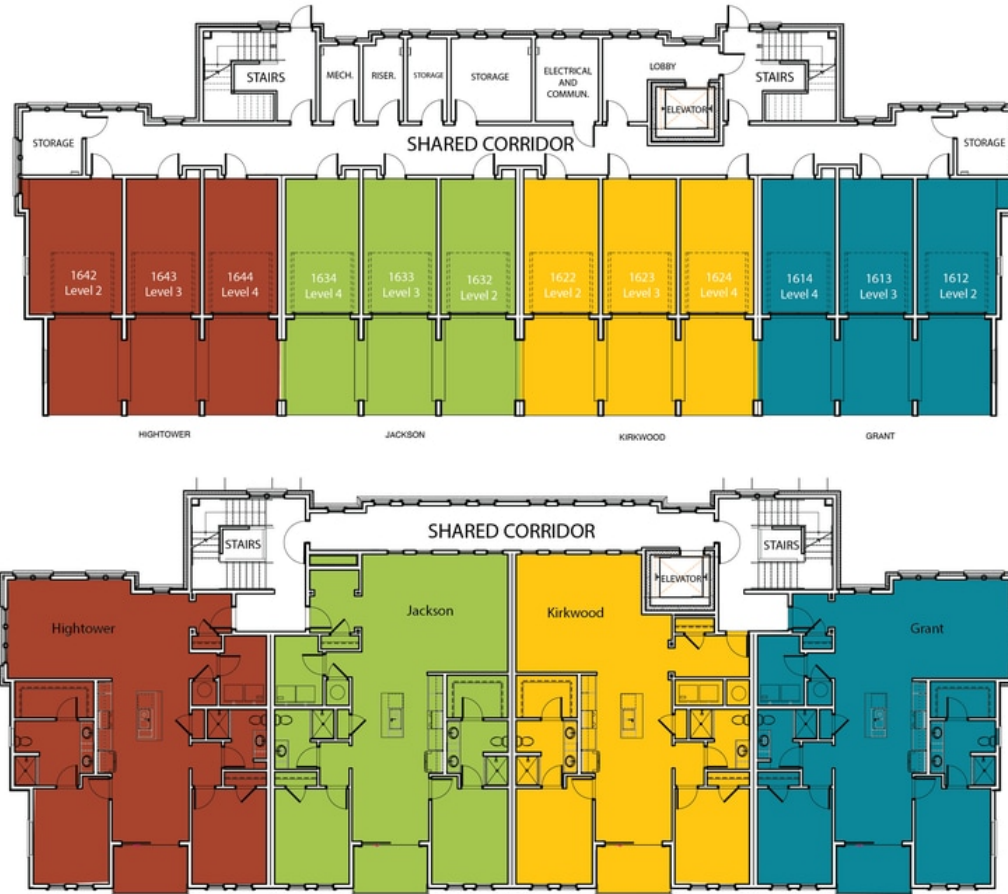

**Want to Know More
About This Home?**

CONTACT OUR COMMUNITY SALES MANAGER
Call Us @ 470.955.0875



2ND FLOOR	UNIT 1922		2022		2122
3RD FLOOR	UNIT 1923		2023		2123
4TH FLOOR	UNIT 1924		2024		2124

**Want to Know More
 About This Home?**

CONTACT OUR COMMUNITY SALES MANAGER
 Call Us @ 470.955.0875



Want to Know More
About This Home?

CONTACT OUR COMMUNITY SALES MANAGER
Call Us @ 470.955.0875