



PRICED AT
\$504,900

 1484 Sq Ft

 2 Beds

 2.0 Baths

 1 Car Garage

 2.0 Story

FALL INTO SAVINGS*NOW FOR A LIMITED TIME ONLY!!!*** Ask about our 4.875% interest rate, on contracts written by the end of November 2024 ~~~Welcome Home to Grant Place! A BRAND-NEW quiet boutique community of single level living located on the Beltline's Southside Trail! Wake up on Sunday mornings and walk outside your door to enjoy locally sourced produce and food at the Grant Park Farmers Market. Each home at Grant Place offers private garages that include a 220V outlet and an additional covered carport. Located in the 2000 building, you only have 12 neighbors spanning over 4 floors! Upon entering this Southwest CORNER UNIT, you'll notice how expansive the living area is to accommodate your furnishings and with 2 walls of windows that you can watch the evening sunset from. We've made it easy for you when purchasing your new home, the living room wall is already prepped to hang your TV and hide the wires, an oversized laundry room for a side-by-side washer & dryer with additional storage, a pantry off of the kitchen, an exhaust fan to turn on when cooking and so much more! Gather around your kitchen island when entertaining or have a sit-down dinner in ...**

Want to Know More
About This Home?

CONTACT OUR COMMUNITY SALES MANAGER
Call Us @ 470.955.0875



2ND FLOOR	UNIT 1612 1712 1812
3RD FLOOR	UNIT 1613 1713 1813
4TH FLOOR	UNIT 1614 1714 1814

Want to Know More
 About This Home?

CONTACT OUR COMMUNITY SALES MANAGER
 Call Us @ 470.955.0875



2ND FLOOR	UNIT 1912	2012	2112
3RD FLOOR	UNIT 1913	2013	2113
4TH FLOOR	UNIT 1914	2014	2114

Want to Know More
 About This Home?

CONTACT OUR COMMUNITY SALES MANAGER
 Call Us @ 470.955.0875

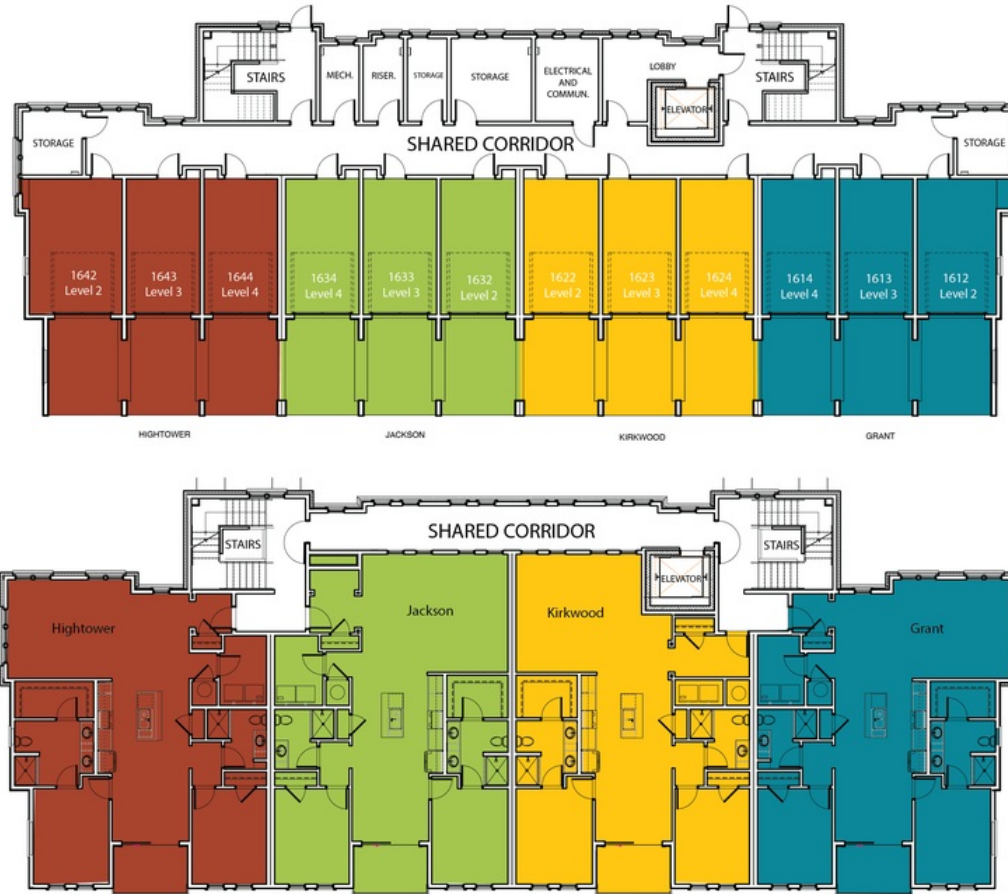

Want to Know More
 About This Home?

CONTACT OUR COMMUNITY SALES MANAGER
 Call Us @ 470.955.0875



Want to Know More
About This Home?

CONTACT OUR COMMUNITY SALES MANAGER
Call Us @ 470.955.0875