

PRICED AT
\$494,900

 1484 Sq Ft

 2 Beds

 2.0 Baths

 1 Car Garage

 2.0 Story

Spring into a New Home!! ***FINAL OPPORTUNITIES at Grant Place*** ~~~ Ask about our \$40K Anyway You Want It for qualified buyers for contracts written now through the end of June 2025. Live on the Beltline! Presented by The Providence Group, Grant Place is a boutique new construction community that sits quietly away from a pass-through street. Wake up on Sundays and step outside to enjoy the famous Grant Park Farmers' Market. Don't feel like cooking? The Beacon offers a variety of restaurants for any palate. One of our largest floorplans, the Hightower is on the northeast corner of the building where you will wake up to a beautiful sunrise! Let's walk through the lavish upgrades and distinctive features that define this gorgeous home. Each home features timeless finish collections that include 42 inch upper cabinetry, soft close doors, under cabinet lighting, Cambria quartz countertops, durable solid surface flooring, tiled bathrooms, raised vanities, Delta fixtures and GE Café SS Appliances. The open-concept layout seamlessly connects the living, dining, and kitchen areas, fostering a sense of spaciousness and unity. As you approach the entrance, be greeted by an expansive foyer with wood flooring that will lead you into your light filled ...

Want to Know More
About This Home?

CONTACT OUR COMMUNITY SALES MANAGER
Call Us @ 470.955.0875



2ND FLOOR	UNIT 1612 1712 1812
3RD FLOOR	UNIT 1613 1713 1813
4TH FLOOR	UNIT 1614 1714 1814

Want to Know More
About This Home?

CONTACT OUR COMMUNITY SALES MANAGER
Call Us @ 470.955.0875



2ND FLOOR	UNIT 1912	2012	2112
3RD FLOOR	UNIT 1913	2013	2113
4TH FLOOR	UNIT 1914	2014	2114

Want to Know More
About This Home?

CONTACT OUR COMMUNITY SALES MANAGER
Call Us @ 470.955.0875

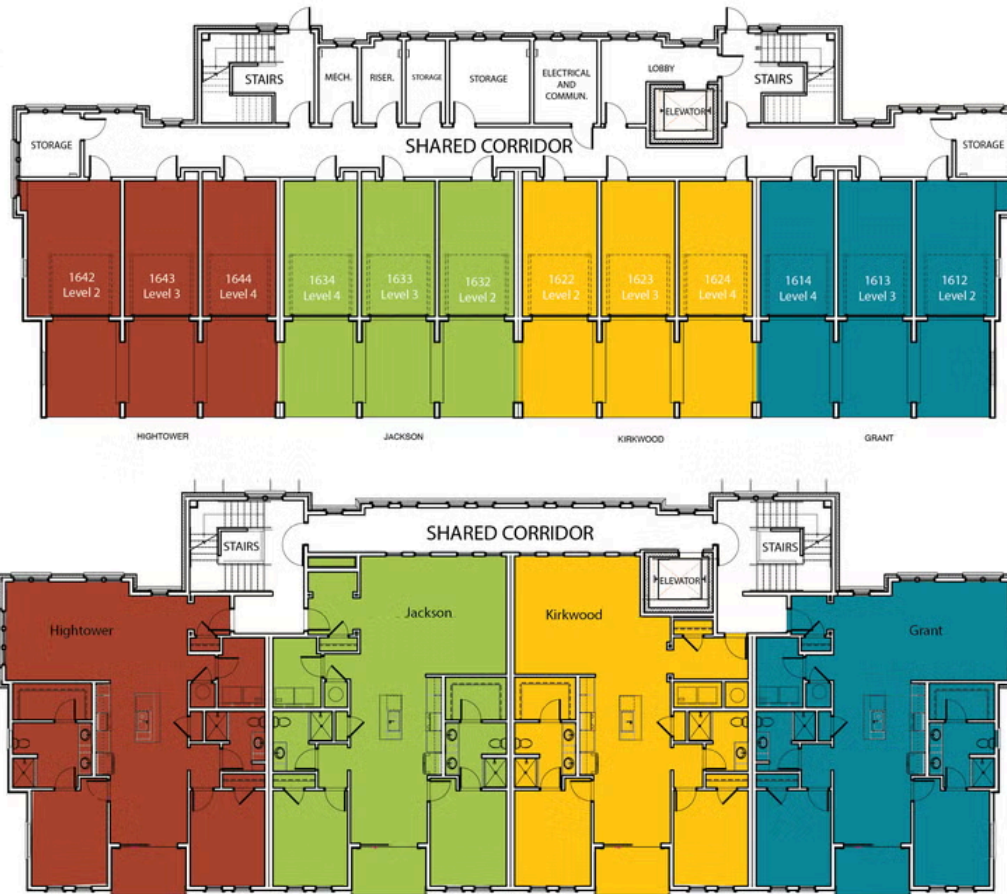

Want to Know More
About This Home?

CONTACT OUR COMMUNITY SALES MANAGER
Call Us @ 470.955.0875



Want to Know More
About This Home?

CONTACT OUR COMMUNITY SALES MANAGER
Call Us @ 470.955.0875