



PRICED AT
\$519,900

 1536 Sq Ft

 2 Beds

 2.0 Baths

 1 Car Garage

 2.0 Story

FALL INTO SAVINGS*NOW FOR A LIMITED TIME ONLY!!!*** ~~~ Ask about our 4.875% interest rate on purchase agreements written by November 30 2024. Live on the Beltline! Presented by The Providence Group, Grant Place is a boutique new construction community that sits quietly away from a pass-through street. Wake up on Sundays and step outside to enjoy the famous Grant Park Farmers' Market. Don't feel like cooking? The Beacon offers a variety of restaurants for any palate. One of our largest floorplans, the Hightower is on the northeast corner of the building where you will wake up to a beautiful sunrise! Let's walk through the lavish upgrades and distinctive features that define this gorgeous home. Each home features timeless finish collections that include 42 inch white upper cabinetry, soft close doors, under cabinet lighting, Cambria quartz countertops, durable solid surface flooring, tiled bathrooms, raised vanities, Delta fixtures and GE Café SS Appliances. The open-concept layout seamlessly connects the living, dining, and kitchen areas, fostering a sense of spaciousness and unity. As you approach the entrance, be greeted by an expansive foyer with wood flooring that will lead you into your light filled home, a living area offering 2 walls of ...**

**Want to Know More
About This Home?**

CONTACT OUR COMMUNITY SALES MANAGER
Call Us @ 470.955.0875



2ND FLOOR	UNIT 1642		1742		1842
3RD FLOOR	UNIT 1643		1743		1843
4TH FLOOR	UNIT 1644		1744		1844

**Want to Know More
 About This Home?**

CONTACT OUR COMMUNITY SALES MANAGER
 Call Us @ 470.955.0875



2ND FLOOR	UNIT 1942		2042		2142
3RD FLOOR	UNIT 1943		2043		2143
4TH FLOOR	UNIT 1944		2044		2144

**Want to Know More
 About This Home?**

CONTACT OUR COMMUNITY SALES MANAGER
 Call Us @ 470.955.0875

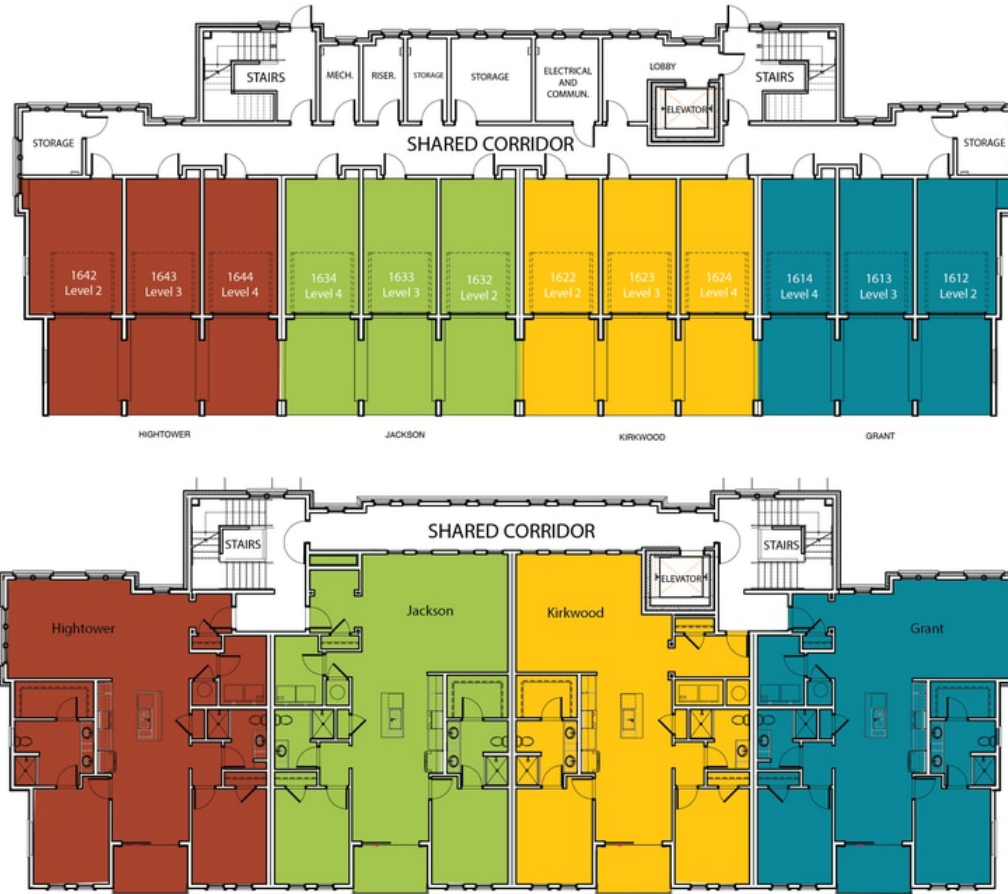

Want to Know More
About This Home?

CONTACT OUR COMMUNITY SALES MANAGER
Call Us @ 470.955.0875



Garage Assignment
Building 1600

Want to Know More
About This Home?

CONTACT OUR COMMUNITY SALES MANAGER
Call Us @ 470.955.0875