



PRICED AT
\$469,150

 1994 Sq Ft

 3 Beds

 3.5 Baths

 2 Car Garage

 3.0 Story

Home is under construction estimated completion is Jan/Feb 2023 2. Ask About our Fabulous Fall Incentives! Location, Location, Location!! Amazing Views with a great open area in front. The Glendale's desirable floor plan offers a private bedroom on the terrace level with a full bath. Your main level has a large kitchen w/island, quartz countertops & view to the fireplace in the family room. On the upper level you will find your primary suite with enlarged tile shower and drying area. Separate laundry room. The secondary bedroom comes with full bath. Our Design team has selected the Cool Slate Collection with beautiful designer finishes. Spend the holidays in your Brand New Home!! This home is in a fantastic location within the community with great views and an open space area in front of the home. This community is in highly desirable location in unincorporated Gwinnett County and close to 3 vibrant cities - downtown Sugar Hill, Suwanee Town Center and Buford!! Incredible amenities will be Pool, Clubhouse, Parks and Green Space coffee bar. Easy Access to interstates, shopping and restaurants. \$15k closing cost incentive with with use of one of the Preferred Lenders - Ameris Bank, Capital City Home Loans, ...

**Want to Know More
About This Home?**

CONTACT OUR COMMUNITY SALES MANAGER
Call Us @ 470.248.2097



Elevations B & C Floor Plan Layout

**Want to Know More
About This Home?**

CONTACT OUR COMMUNITY SALES MANAGER
Call Us @ 470.248.2097



FIRST FLOOR

Elevations B & C Floor Plan Layout

**Want to Know More
About This Home?**

CONTACT OUR COMMUNITY SALES MANAGER
Call Us @ 470.248.2097



SECOND FLOOR

Elevations B & C Floor Plan Layout

**Want to Know More
About This Home?**

CONTACT OUR COMMUNITY SALES MANAGER
Call Us @ 470.248.2097

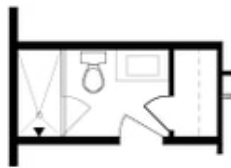

OPT Bath 3 Shower ilo
 Tub/Shower Combo



OPT Sunroom ilo Full Deck



OPT Owner's
 Walk-Through Shower



OPT Stair Landing
 on Terrace



OPT Fireplace



OPT Linear Fireplace



OPT Owner's Shower &
 Tub Combo

OPTIONS

**Want to Know More
 About This Home?**

CONTACT OUR COMMUNITY SALES MANAGER
 Call Us @ 470.248.2097