



PRICED AT
\$508,650

 **1904 Sq Ft**

 **3 Beds**

 **3.5 Baths**

 **2 Car Garage**

 **3.0 Story**

“ New Year New Home New You! ”. Limited time Don't miss out*Use \$15k anyway for contracts written in January and closing in February on this home*** Find out more about loan options & available rates with our preferred lenders or go online to schedule an appointment to view this Move in Ready Home! Brand New Home by The Providence Group! Gated Community **This home has it all!! The Beauty of this 3 story Glendale plan is that each bedroom has its own bathroom!!!! Your Guest will enter your new home just off the terrace level entry foyer, where you will find a private bedroom and full bath with upgraded Shower for guests or great as an office! The design team has selected the beautiful New Warm Wheat Package, the finishes have a modern gorgeous look!! The Main level is the definition of open concept living with gourmet kitchen complete with painted Vanilla cabinets with stained wood island, stainless steel appliances, quartz countertop and tile backsplash. The kitchen is adjacent to the dining room and has a cozy stacked quartzite fireplace to take away the chill on cool evenings. The Upper level boasts comfortable living in owner's suite with large walk-in ...**

**Want to Know More
About This Home?**

CONTACT OUR COMMUNITY SALES MANAGER
Call Us @ 470.248.2097



Elevations B & C Floor Plan Layout

Want to Know More
About This Home?

CONTACT OUR COMMUNITY SALES MANAGER
Call Us @ 470.248.2097



FIRST FLOOR

Elevations B & C Floor Plan Layout

Want to Know More
About This Home?

CONTACT OUR COMMUNITY SALES MANAGER
Call Us @ 470.248.2097

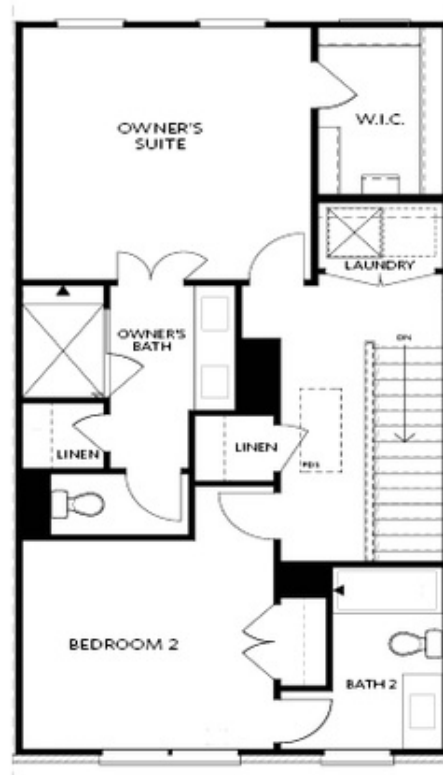

SECOND FLOOR

Elevations B & C Floor Plan Layout

Want to Know More
About This Home?

CONTACT OUR COMMUNITY SALES MANAGER
Call Us @ 470.248.2097



OPT Bath 3 Shower ilo
 Tub/Shower Combo



OPT Sunroom ilo Full Deck



OPT Owner's
 Walk-Through Shower

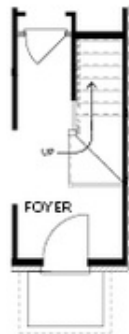

OPT Stair Landing
 on Terrace



OPT Fireplace



OPT Linear Fireplace



OPT Owner's Shower &
 Tub Combo

OPTIONS

Want to Know More
 About This Home?

CONTACT OUR COMMUNITY SALES MANAGER
 Call Us @ 470.248.2097