



PRICED AT
\$488,650

 1893 Sq Ft

 3 Beds

 3.5 Baths

 2 Car Garage

 3.0 Story

Quick Move In!!! Don't Miss out on your opportunity to Live in this sought after Gated community. **Elevate your life in 2023 with a new home by The Providence Group and \$5,000 towards closing cost when financing with one of Seller's 4 preferred lenders. The Glendale plan features 3 bedrooms/3.5 baths. Entry is on the terrace level where you will find a private bedroom and full bath or use this area as a media room/office or home gym. The main level is complete with kitchen, dining and family room with cozy, warm fireplace. The Cool Linen Design Collection showcases white kitchen cabinets, beautiful quartz countertops with gray veining, a tile backsplash and stainless appliances. The Owners Suite with Bathroom has dual vanities with quartz counters and a big master closet located on the upper floor. Finishing out the 3rd floor is a secondary bedroom with its own private bath. Home has a oversized deck for your entertainment. Enjoy your fireplace in your family room. Make this home your home today!! This home is in a fantastic location within the community. Home is under construction estimated completion is June 2023. This community is in highly desirable location in unincorporated Gwinnett County ...**

**Want to Know More
About This Home?**

CONTACT OUR COMMUNITY SALES MANAGER
Call Us @ 470-248-2097



**Want to Know More
About This Home?**

CONTACT OUR COMMUNITY SALES MANAGER
Call Us @ 470-248-2097

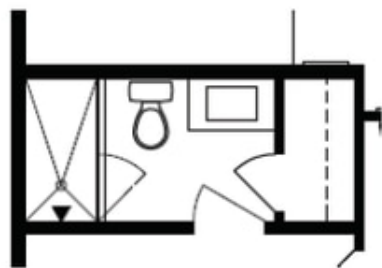

Optional Bath 3 Shower and Tub



Optional Owner's Luxury Shower

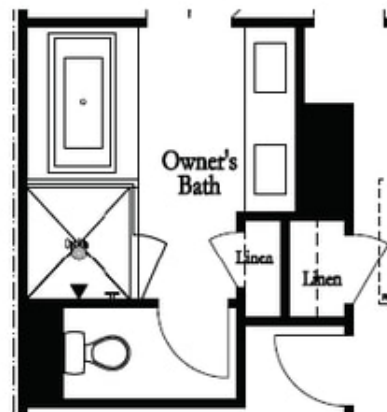

Optional Owner's Shower & Tub

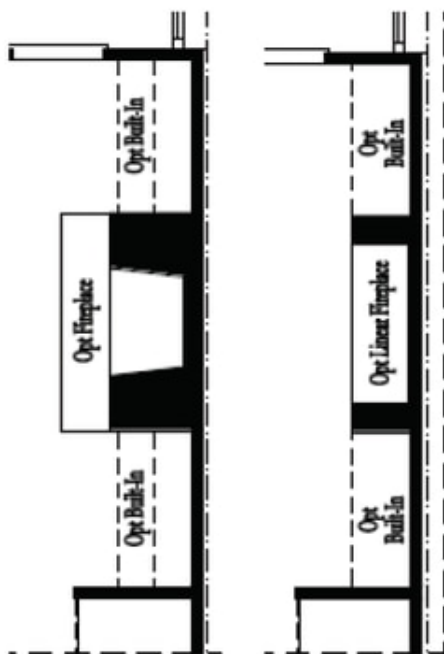

Optional
Family Room
Fireplace

Optional
Family Room
Linear Fireplace

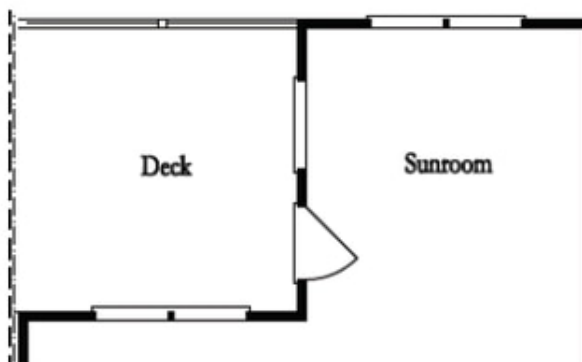

Optional Sunroom 1 into Extended Deck

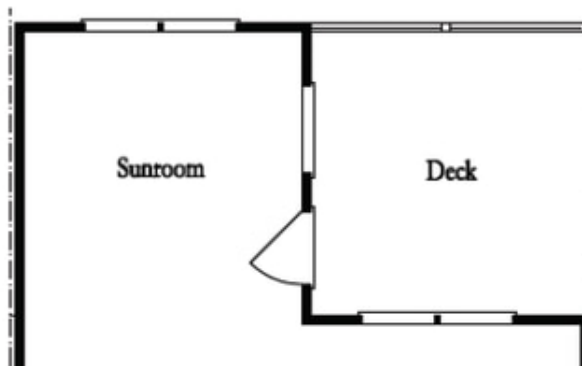

Optional Sunroom 2 into Extended Deck

**Want to Know More
About This Home?**

CONTACT OUR COMMUNITY SALES MANAGER
Call Us @ 470-248-2097