



PRICED AT
\$509,400

 1994 Sq Ft

 3 Beds

 3.5 Baths

 2 Car Garage

 3.0 Story

QUICK CLOSE!!!Elevate your life in 2023 with a new home by The Providence Group and \$10,000 towards closing cost when financing with one of Seller's 4 preferred lenders- Home must close by 9/30/23**. Our Popular Glendale Plan is waiting for you to enjoy this spacious 3 story floorplan! This homesite has the Huge Upgraded Walk in Shower with drying area and a Sunroom for extra living space/ office relaxation that leads onto your deck. Just off the terrace level entry foyer, you will find a private bedroom and full bath for guests. The Main level is the definition of open concept living with gourmet kitchen complete with large island, stainless steel appliances, quartz countertop and tile backsplash. The kitchen is adjacent to the dining room, family room and sunroom. The Upper level boasts comfortable living in owner's suite with large walk-in closet, owners bath with dual vanities and a mega walk in shower with drying area. The secondary bedroom has its own private bath and the laundry room is also upstairs for laundry day convenience. 2 car rear entry garage with garage door openers. The Design team has selected the Warm Slate Collection with beautiful design elements for this home! ...**

**Want to Know More
About This Home?**

CONTACT OUR COMMUNITY SALES MANAGER
Call Us @ 470.248.2097



Elevations B & C Floor Plan Layout

**Want to Know More
About This Home?**

CONTACT OUR COMMUNITY SALES MANAGER
Call Us @ 470.248.2097



FIRST FLOOR

Elevations B & C Floor Plan Layout

**Want to Know More
About This Home?**

CONTACT OUR COMMUNITY SALES MANAGER
Call Us @ 470.248.2097



SECOND FLOOR

Elevations B & C Floor Plan Layout

**Want to Know More
About This Home?**

CONTACT OUR COMMUNITY SALES MANAGER
Call Us @ 470.248.2097

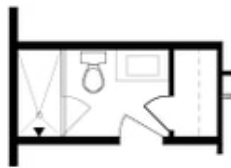

OPT Bath 3 Shower ilo
 Tub/Shower Combo



OPT Sunroom ilo Full Deck



OPT Owner's
 Walk-Through Shower



OPT Stair Landing
 on Terrace



OPT Fireplace



OPT Linear Fireplace



OPT Owner's Shower &
 Tub Combo

OPTIONS

**Want to Know More
 About This Home?**

CONTACT OUR COMMUNITY SALES MANAGER
 Call Us @ 470.248.2097