



PRICED AT
\$528,650

 2004 Sq Ft

 3 Beds

 3.5 Baths

 2 Car Garage

 3.0 Story

The Glendale Floor Plan by The Providence Group. **Elevate your life in 2023 with a new home by The Providence Group and \$5,000 towards closing cost when financing with one of Seller's 4 preferred lenders**. This End Unit is in a Gated community with amazing amenities and has all the upgrades that are in high demand. This home features a Sunroom, Fireplace & the Walk in Shower with drying area in the Owner's bathroom!! Home in Under Construction and estimated completion May/June 23 The design team has selected the beautiful Cool Linen Collection in this 3 bedroom 3.5 bathroom home. Enjoy an Open Concept on the main level, a beautiful kitchen with White cabinets, quartz countertops with pretty gray veining, tile backsplash and stainless appliances. The owners bath located on the upper floor has an enlarged shower and dual vanities with quartz countertops. The secondary bedrooms each have its own private bathroom. This home is in a fantastic location within the community. This community is in highly desirable location in unincorporated Gwinnett County and close to 3 vibrant cities - downtown Sugar Hill, Suwanee Town Center and Buford!! Incredible amenities will be Pool, Parks and Green Space Easy Access to ...

**Want to Know More
About This Home?**

CONTACT OUR COMMUNITY SALES MANAGER
Call Us @ 470-248-2097



**Want to Know More
About This Home?**

CONTACT OUR COMMUNITY SALES MANAGER
Call Us @ 470-248-2097

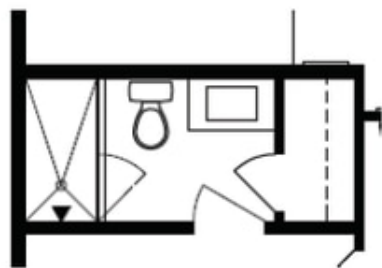

Optional Bath 3 Shower ilo Tub



Optional Owner's Luxury Shower

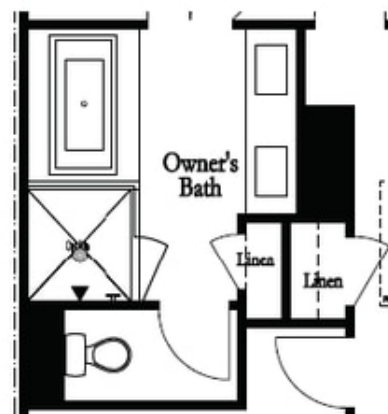

Optional Owner's Shower & Tub

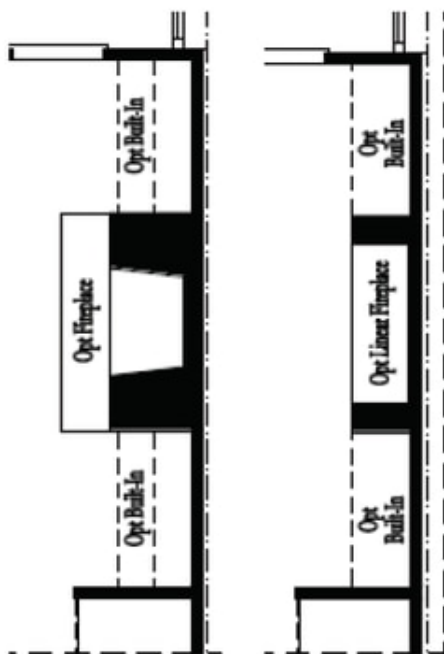

Optional
Family Room
Fireplace

Optional
Family Room
Linear Fireplace

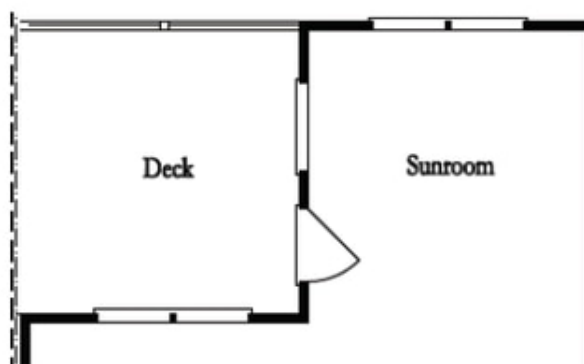

Optional Sunroom 1 ilo Extended Deck

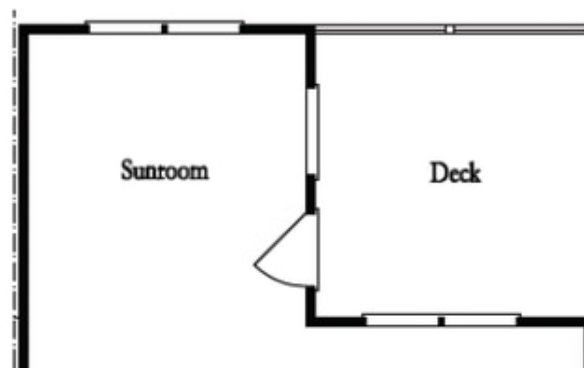

Optional Sunroom 2 ilo Extended Deck

**Want to Know More
About This Home?**

CONTACT OUR COMMUNITY SALES MANAGER
Call Us @ 470-248-2097