



PRICED AT
\$515,650

 1994 Sq Ft

 3 Beds

 3.5 Baths

 2 Car Garage

 3.0 Story

Sizzling Summer Savings **Take Advantage of \$10k anyway and \$7500 closing cost with Seller preferred lender for contracts written in August on this Home! ** The Garwood - Incredible Views in Amazing Location. QUICK MOVE IN! Gated Community - Garwood Plan only 5 units in the whole community with this plan!!! Make this your home today**. This Garwood floor plan is a 3 story townhome in great location on a hilltop with incredible views and a deck and sunroom for entertaining!! This 3 story design floor offers entry on main level. Your main level is open concept with a gourmet kitchen with light gray cabinets, quartz countertops overlooking dining and family room. Family room is very cozy with a nice fireplace to enjoy. The laundry room is located in hallway on the upper level along with the secondary bedroom. On the garage level you will find the 3rd bedroom with a large walk in closet and full bathroom. The highlight of the Garwood floor plan is that all the bedrooms have their own bathrooms. This community is in highly desirable location in unincorporated Gwinnett County and close to 3 vibrant cities - downtown Sugar Hill, Suwanee Town Center and Buford!! ...

**Want to Know More
About This Home?**

CONTACT OUR COMMUNITY SALES MANAGER
Call Us @ 470.248.2097



**Want to Know More
About This Home?**

CONTACT OUR COMMUNITY SALES MANAGER
Call Us @ 470.248.2097

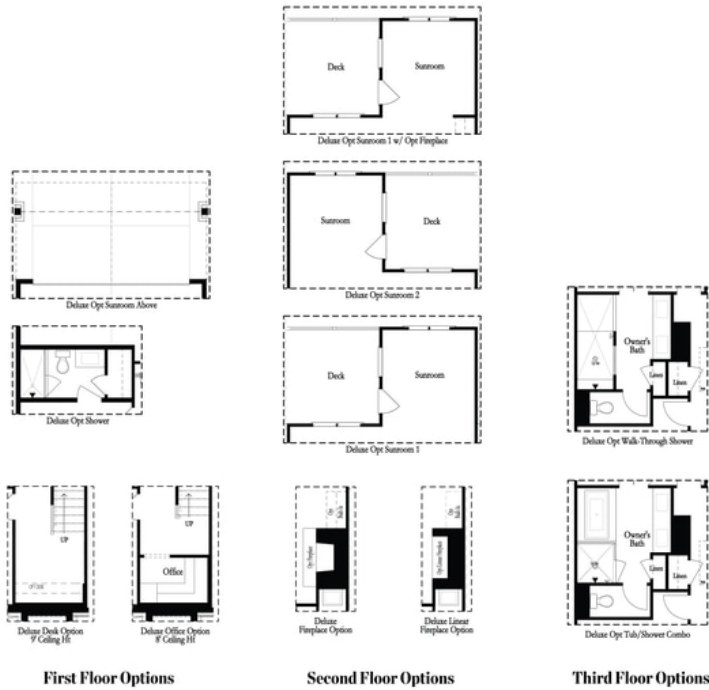

**Want to Know More
 About This Home?**

CONTACT OUR COMMUNITY SALES MANAGER
 Call Us @ 470.248.2097