



PRICED AT
\$581,400

 2030 Sq Ft

 3 Beds

 2.5 Baths

 2 Car Garage

 2.0 Story

Pick Your Promotion with \$20K - Choose the path to homeownership that fits your life - low rates, upgrades, appliances, closing costs & more. Ends July 31, 2025. Homesite #166, END UNIT, Nice Size, fenced backyard, this great two-story townhome offers an easy entrance on the main level for both your guests/family and you with front entry garage, very convenient for groceries. Private front entrance/foyer on main level with hard surface floors leads you into an open concept living with family room, kitchen, and dining. Family room features a 12 ft sliding door that provides lots of natural light and leads you out to a covered patio and fenced backyard. The backyard is fantastic being fenced in and the covered patio is a gem on this end unit. Watch your pets and family enjoy the fenced in backyard while grilling out or sipping on coffee all from outside or inside the home. Lots of natural light and windows. Gourmet kitchen has Quartz countertops with large island, single bowl sink, under cabinet lighting - cabinets are white, making this home light and bright - Warm Linen Design collection. When heading up to the second floor the owner's bedroom is in the ...

**Want to Know More
About This Home?**

CONTACT OUR COMMUNITY SALES MANAGER
Call Us @ 470.248.2097



Unfinished Basement

Want to Know More
About This Home?

CONTACT OUR COMMUNITY SALES MANAGER
Call Us @ 470.248.2097



First Floor

**Want to Know More
About This Home?**

CONTACT OUR COMMUNITY SALES MANAGER
Call Us @ 470.248.2097



Second Floor
(Owner's Front)

Elevations G, H, J1, J3 & L

Want to Know More
About This Home?

CONTACT OUR COMMUNITY SALES MANAGER
Call Us @ 470.248.2097



Second Floor
(Owner's Rear)

Elevations G, H, J1, J3 & L

Want to Know More
About This Home?

CONTACT OUR COMMUNITY SALES MANAGER
Call Us @ 470.248.2097



Opt. Screened Patio



Opt. Coverd Patio



Opt. Linear Fireplace



Opt. Fireplace



Opt. 8 Foot Slider Door



Opt. 12 Foot Slider Door

Main Level Options

**Want to Know More
About This Home?**

CONTACT OUR COMMUNITY SALES MANAGER
Call Us @ 470.248.2097

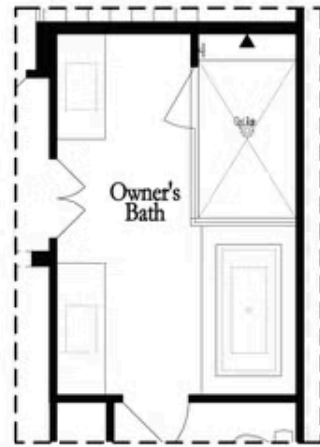

Opt. Shower/Tub



Opt. Walk-Through Shower

Owner's Front - Options

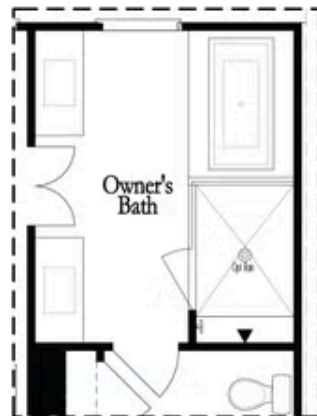

Opt. Shower/Tub



Opt. Walk-Through Shower

Owner's Rear - Options

Want to Know More
About This Home?

CONTACT OUR COMMUNITY SALES MANAGER
Call Us @ 470.248.2097