



PRICED FROM
\$487,900

 **1,893 - 2,004 Sq Ft**

 **3 Beds**

 **3.5 Baths**

 **2 Car Garage**

 **3.0 Story**

- **Spacious Three Story Design with Open Main Level Layout**
- **Gourmet Kitchen with Island overlooking Dining and Family Room**
- **Owner's Suite and Private Bath with Dual Vanities and Over Size Walk-In Closet on Upper Level**
- **A Secondary Bedroom and Laundry on Upper Level**
- **Two Car Garage**

[Read More Online](#)

Available Elevations





TERRACE

Elevations B & C Floor Plan Layout

Want to Know More
About This Home?

CONTACT OUR COMMUNITY SALES MANAGER
Call Us @ 470.248.2097



FIRST FLOOR

Elevations B & C Floor Plan Layout

Want to Know More
About This Home?

CONTACT OUR COMMUNITY SALES MANAGER
Call Us @ 470.248.2097

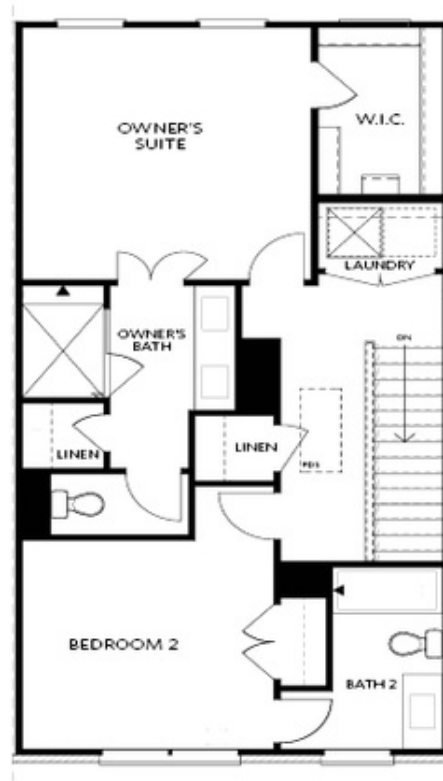

SECOND FLOOR

Elevations B & C Floor Plan Layout

**Want to Know More
About This Home?**

CONTACT OUR COMMUNITY SALES MANAGER
Call Us @ 470.248.2097

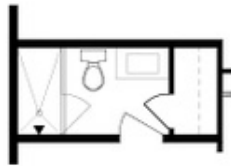

OPT Bath 3 Shower ilo
Tub/Shower Combo



OPT Sunroom ilo Full Deck



OPT Owner's
Walk-Through Shower

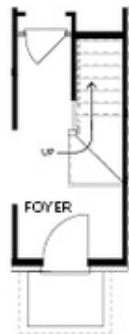

OPT Stair Landing
on Terrace



OPT Fireplace



OPT Linear Fireplace



OPT Owner's Shower &
Tub Combo

OPTIONS

Want to Know More
About This Home?

CONTACT OUR COMMUNITY SALES MANAGER
Call Us @ 470.248.2097