



PRICED AT
\$807,055

 3083 Sq Ft

 4 Beds

 4.0 Baths

 2 Car Garage

 3.0 Story

New Year, New Home, New You!" Calhoun - A top selling floorplan by The Providence Group New Construction in Buford/Sugar Hill! Close to 3 vibrant downtown areas including Suwanee, Buford, and Sugar Hill! Fantastic structural and Interior Design upgrades! Upon entering this home you will have a separate formal dining room, 10 ft. ceilings on the main floor, family room with fireplace, kitchen with view to family room and breakfast area, and guest bedroom with full bath - ALL on the MAIN level. Off of the breakfast area you will find your deck which is perfect spot to entertain and BBQ on these sunny days or for lounging with a book. Upstairs you will watch a movie in the media room or use it as another living space. The owners suite is on the upper floor featuring a master bathroom with a double vanity, both tub and walk in shower and His/Hers closets. Hers is Fantastic! Easy access to the laundry room which is centrally located upstairs. Also on the second level you will have 2 additional bedrooms and bathrooms. This will make this brand new home a 4 bdrm/4 bath home! Not to mention this home is built on ...

**Want to Know More
About This Home?**

CONTACT OUR COMMUNITY SALES MANAGER
Call Us @ 470.248.2097



Want to Know More
About This Home?

CONTACT OUR COMMUNITY SALES MANAGER
Call Us @ 470.248.2097



Want to Know More
About This Home?

CONTACT OUR COMMUNITY SALES MANAGER
Call Us @ 470.248.2097



Want to Know More
About This Home?

CONTACT OUR COMMUNITY SALES MANAGER
Call Us @ 470.248.2097

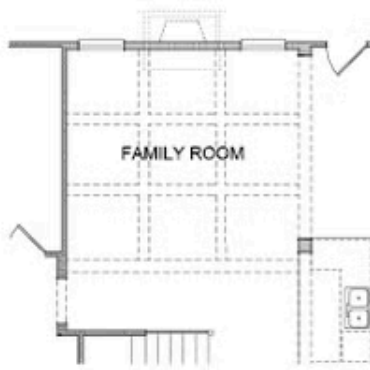

Opt. Coffered Ceilings
w/ Opt. Media Room or Bedroom 5 above



Opt. Bedroom 4 w/ Full Bath
No Study & Power Room



Opt. Sunrooms

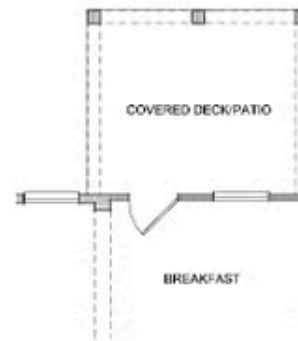

Opt. Covered Deck/Patio

Want to Know More
About This Home?

CONTACT OUR COMMUNITY SALES MANAGER
Call Us @ 470.248.2097



Want to Know More
About This Home?

CONTACT OUR COMMUNITY SALES MANAGER
Call Us @ 470.248.2097