



PRICED AT  
**\$508,150**

 1994 Sq Ft

 3 Beds

 3.5 Baths

 2 Car Garage

 3.0 Story

Elevate your life in 2023 with a new home by The Providence Group and \$10,000 towards closing cost when financing with one of Seller's 4 preferred lenders- Home must close by 9/30/23\*\* **QUICK MOVE IN HOME!!**. Upgrade options included in this home are a Sunroom for extra living space and a fireplace for those chilly evenings. Each bedroom has its own bathroom!!! This townhome is a spacious 3 story design floor plan offering a private entry & bedroom with full bath on terrace level. This 3 bedroom, 3.5 bath has a beautiful kitchen with quartz countertops, stainless appliances and tile backsplash. The open floor plan is great for entertaining. Make this home your home today!! This home is in a fantastic location within the community. This community is in highly desirable location in unincorporated Gwinnett County and close to 3 vibrant cities - downtown Sugar Hill, Suwanee Town Center and Buford!! Incredible amenities will be Incredible amenities will be Gated, Resort-style pool with covered cabana, grills, fireplace, and outdoor dining area and a community lawn featuring Adirondack group seating and fire pits. Easy Access to interstates, shopping and restaurants. Closing cost incentive with with use of one of the Preferred ...

**Want to Know More  
About This Home?**

CONTACT OUR NEW HOME NAVIGATOR

**NONE**

Call Us @ 470-248-2097



**Want to Know More  
About This Home?**

CONTACT OUR NEW HOME NAVIGATOR

**NONE**

Call Us @ 470-248-2097



Optional Bath 3 Shower ilo Tub



Optional Owner's Luxury Shower

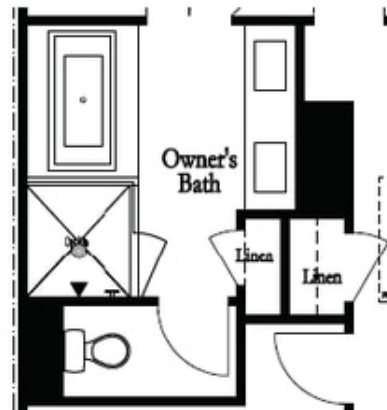

Optional Owner's Shower & Tub



Optional  
Family Room  
Fireplace

Optional  
Family Room  
Linear Fireplace



Optional Sunroom 1 ilo Extended Deck

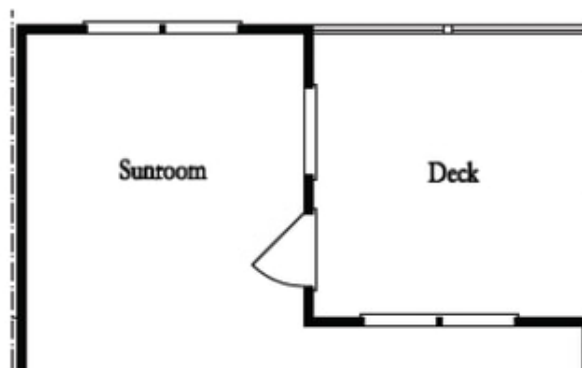

Optional Sunroom 2 ilo Extended Deck

**Want to Know More  
About This Home?**

CONTACT OUR NEW HOME NAVIGATOR

**NONE**

Call Us @ 470-248-2097