



PRICED AT
\$493,650

 1903 Sq Ft

 3 Beds

 3.5 Baths

 2 Car Garage

 3.0 Story

QUICK CLOSE!!! Gated Community **Elevate your life in 2023 with a new home by The Providence Group and \$10,000 towards closing cost when financing with one of Seller's 4 preferred lenders- Home must close by 8/31/23**. This home has a Huge deck for entertaining, The Upgraded Huge walk in shower with drying area and a Fireplace!!! The design team has selected the beautiful Warm Linen Package, the finishes have a modern gorgeous look!! The Beauty of this 3 story Glendale plan is that each bedroom has its own bathroom!!!! Your Guest will enter your new home just off the terrace level entry foyer, where you will find a private bedroom and full bath for guests or great as an office! The Main level is the definition of open concept living with gourmet kitchen complete with white cabinets, large island, stainless steel appliances, quartz countertop and tile backsplash. The kitchen is adjacent to the dining room, family room. The Upper level boasts comfortable living in owner's suite with large walk-in closet, owners bath with dual vanities and a mega walk in shower with drying area. The secondary bedroom has its own private bath and the laundry room is also upstairs for ...

**Want to Know More
About This Home?**

CONTACT OUR NEW HOME NAVIGATOR

NONE

Call Us @ 470-248-2097



**Want to Know More
About This Home?**

CONTACT OUR NEW HOME NAVIGATOR

NONE

Call Us @ 470-248-2097



Optional Bath 3 Shower ilo Tub



Optional Owner's Luxury Shower

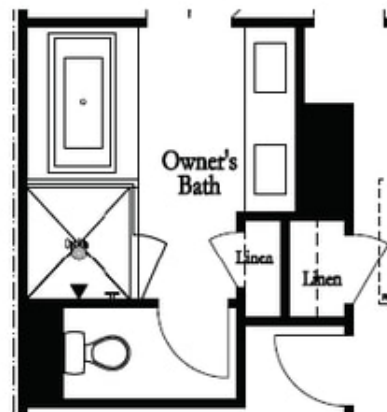

Optional Owner's Shower & Tub



Optional
Family Room
Fireplace

Optional
Family Room
Linear Fireplace



Optional Sunroom 1 ilo Extended Deck

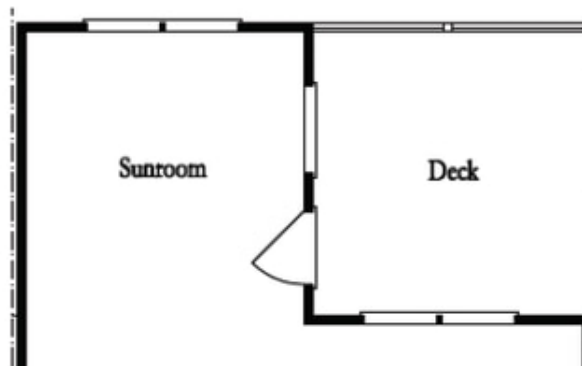

Optional Sunroom 2 ilo Extended Deck

**Want to Know More
About This Home?**

CONTACT OUR NEW HOME NAVIGATOR

NONE

Call Us @ 470-248-2097