



PRICED FROM
\$535,900

 2,727 - 2,783 Sq Ft

 3 - 4 Beds

 2.5 - 3.5 Baths

 2 Car Garage

 2.0 Story

- Preliminary Home Design
- Two Story Layout
- Spacious Owner's Suite and Bath with Dual Vanities, Walk-In Shower and Large Walk-In Closet on Main Level
- Easy access to Laundry Room from Owner's Suite
- Gourmet Kitchen with Island overlooking Dining Area and Family Room
- Private Study on Main Level

[Read More Online](#)

Available Elevations



Elevation A



Elevation B



Elevation C



FIRST FLOOR

Elevation A

Want to Know More
About This Home?

CONTACT OUR NEW HOME NAVIGATOR

NONE

Call Us @ (470) 509-9931

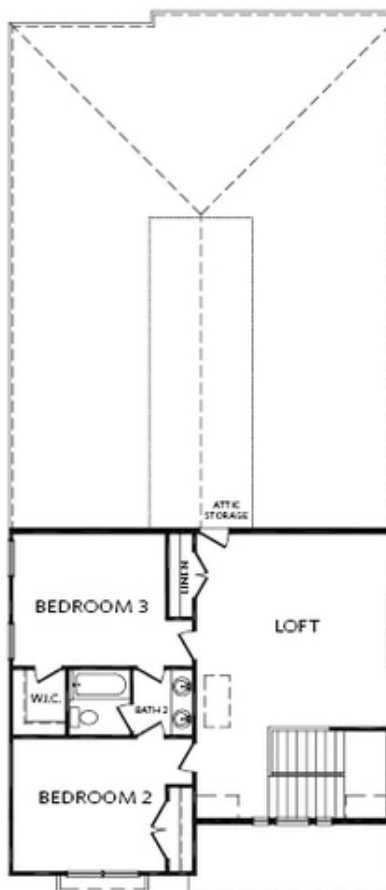

SECOND FLOOR

Elevation A

Want to Know More
About This Home?

CONTACT OUR NEW HOME NAVIGATOR

NONE

Call Us @ (470) 509-9931



OPT Sliding Glass Door



OPT Golf Cart Garage



OPT Tub/Shower Combo



OPT Storage



OPT Larger Shower

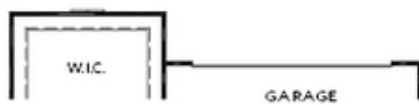

OPT Larger Owner's Closet

OPTIONS FIRST FLOOR

Want to Know More
About This Home?

CONTACT OUR NEW HOME NAVIGATOR

NONE

Call Us @ (470) 509-9931



OPT Bedroom 4 w/ Full Bath 3

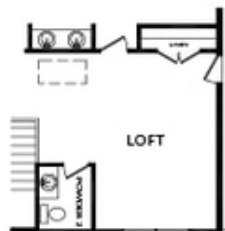

OPT 2nd Powder Room

OPTIONS SECOND FLOOR

Want to Know More
About This Home?

CONTACT OUR NEW HOME NAVIGATOR

NONE

Call Us @ (470) 509-9931