



PRICED AT  
**\$488,900**

 **1893 Sq Ft**

 **3 Beds**

 **3.5 Baths**

 **2 Car Garage**

 **3.0 Story**

**Spring into a New Home!! The Glendale, one of our most popular townhomes is being built here just for you! This spacious 3 story, 3 bedroom and 3.5 bath home is under construction at this time. Estimated time frame for completion is March/April of 2024. This home is located in The Providence Groups newest community in Cumming with quick and easy access to GA 400, the Cumming City Center is just around the corner, with loads of restaurants and retail for easy living! And speaking of easy, your HOA will maintain your lawn for you! The Glendale is a well laid out home with 9-foot ceilings located on all 3 floors. The terrace level will have a bedroom/office with a full bath. As you enter the main floor of the home, you will notice there is ample space for all your living needs. Open and bright! This home will have quartz countertops, our beautiful gray cabinets, undercounter lighting, gorgeous backsplash and all stainless-steel appliances to round out the finishes. `Plenty of space for today's living and entertaining. The back deck is huge and overlooks the woods in the back! As you ascend the steps to the third floor, your laundry ...**

**Want to Know More  
About This Home?**

**CONTACT OUR COMMUNITY SALES MANAGER  
Call Us @ 470.509.9930**



TERRACE

Elevations B & C Floor Plan Layout

Want to Know More  
About This Home?

CONTACT OUR COMMUNITY SALES MANAGER  
Call Us @ 470.509.9930



FIRST FLOOR

Elevations B & C Floor Plan Layout

Want to Know More  
About This Home?

CONTACT OUR COMMUNITY SALES MANAGER  
Call Us @ 470.509.9930

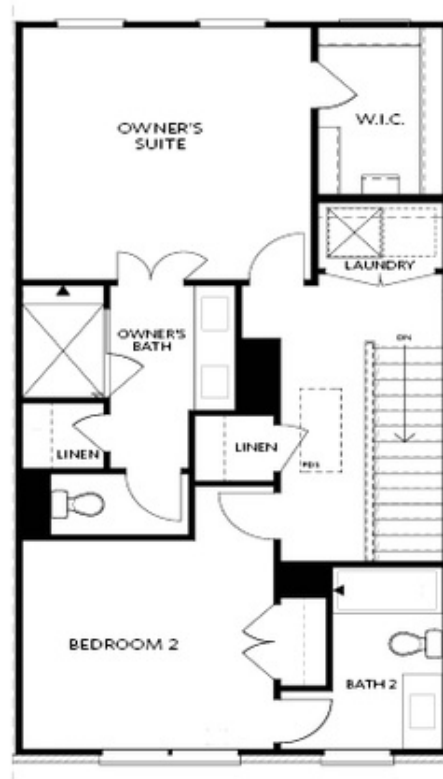

SECOND FLOOR

Elevations B & C Floor Plan Layout

Want to Know More  
About This Home?

CONTACT OUR COMMUNITY SALES MANAGER  
Call Us @ 470.509.9930



OPT Bath 3 Shower ilo  
 Tub/Shower Combo



OPT Sunroom ilo Full Deck



OPT Owner's  
 Walk-Through Shower



OPT Stair Landing  
 on Terrace



OPT Fireplace



OPT Linear Fireplace



OPT Owner's Shower &  
 Tub Combo

OPTIONS

Want to Know More  
 About This Home?

CONTACT OUR COMMUNITY SALES MANAGER  
 Call Us @ 470.509.9930