



PRICED AT
\$499,800

 **1893 Sq Ft**

 **3 Beds**

 **3.5 Baths**

 **2 Car Garage**

 **3.0 Story**

Spring into a New Home!! Spring is here and so are some amazing home opportunities here in the Brackley community located in Cumming GA. The Brackley is The Providence Groups newest community that provides elevated living in a convenient location! Located just 1 mile from GA 400, 1.3 miles from the Cumming City Center, we have it all! Location, accessibility, great restaurants, retail and more! The Glendale is our 3-bedroom 3.5-bathroom townhome which has a ton of room and natural light on all 3 floors. When you enter the home from the terrace level, you will find a bedroom with full bath on this floor. Or could be the perfect home office space. Roomy 2 car garage is found at the rear of the home making the streetscape even more appealing. As you ascend the stairs to the main floor, you will be pleasantly surprised at the amount of space! Your family room will have a gorgeous linear fireplace...perfect for the seasons! The kitchen is located in the front of the home and will have our Warm Linen Collection design finishes. Absolutely eye-catching finishes, such as quartz countertops, under cabinet lighting, designer tile backsplash, stainless steel GE appliances will all ...

**Want to Know More
About This Home?**

CONTACT OUR COMMUNITY SALES MANAGER
Call Us @ 470.509.9930



TERRACE

Elevations B & C Floor Plan Layout

Want to Know More
About This Home?

CONTACT OUR COMMUNITY SALES MANAGER
Call Us @ 470.509.9930



FIRST FLOOR

Elevations B & C Floor Plan Layout

Want to Know More
About This Home?

CONTACT OUR COMMUNITY SALES MANAGER
Call Us @ 470.509.9930

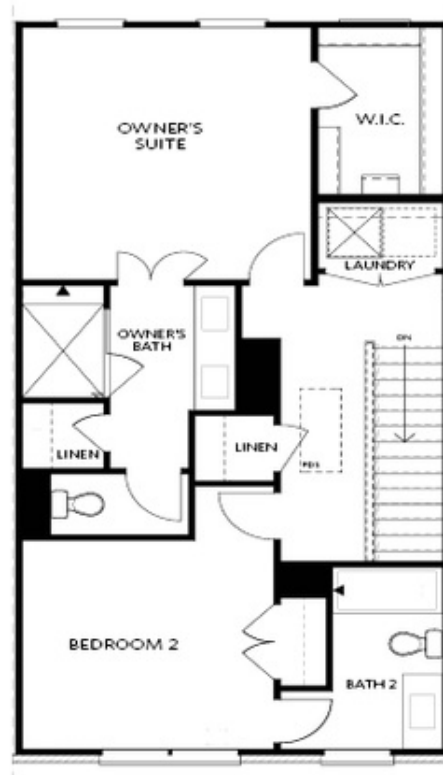

SECOND FLOOR

Elevations B & C Floor Plan Layout

Want to Know More
About This Home?

CONTACT OUR COMMUNITY SALES MANAGER
Call Us @ 470.509.9930



OPT Bath 3 Shower ilo
Tub/Shower Combo



OPT Sunroom ilo Full Deck



OPT Owner's
Walk-Through Shower



OPT Stair Landing
on Terrace



OPT Fireplace



OPT Linear Fireplace



OPT Owner's Shower &
Tub Combo

OPTIONS

Want to Know More
About This Home?

CONTACT OUR COMMUNITY SALES MANAGER
Call Us @ 470.509.9930