



PRICED AT
\$458,900

 **1373 Sq Ft**

 **2 Beds**

 **2.5 Baths**

 **1 Car Garage**

 **3.0 Story**

Experience the vibrant urban lifestyle at Sawnee Village's bustling Market Square District and Fall into Savings with 5.25% fixed interest rate or 2/1 buydown starting around 1700!* With a diverse mix of retail and dining options just steps away, convenience and excitement are at your doorstep. Market Square is perfect for both first-time homebuyers and those looking to downsize without compromising on quality. Located in the heart of Cumming, GA, this lively community offers a range of stylish condos designed to meet all your needs. This Magnolia Plan, featuring The Providence Group's Cool Stone Design Collection, features 2 bedrooms and 2.5 bathrooms spread across 3 levels, totaling 1,373 sq. ft. Enter on the terrace level to find a welcoming foyer and a charming laundry room. The main level boasts an open-concept design that seamlessly integrates the family room, dining area, and a chef-inspired kitchen. This kitchen is a dream, featuring 42" cabinets, quartz countertops, a large island, stainless-steel GE appliances, a tile backsplash, and modern lighting. The bright dining area opens onto a spacious covered deck, perfect for entertaining. On the third level, you'll find a generous Primary Suite with a large walk-in closet and a contemporary bathroom equipped with ...

Want to Know More
About This Home?

CONTACT OUR COMMUNITY SALES MANAGER
Call Us @ 678.372.1644



FIRST FLOOR

Elevations 1 & 1A Floor Plan Layout

Want to Know More
About This Home?

CONTACT OUR COMMUNITY SALES MANAGER
Call Us @ 678.372.1644

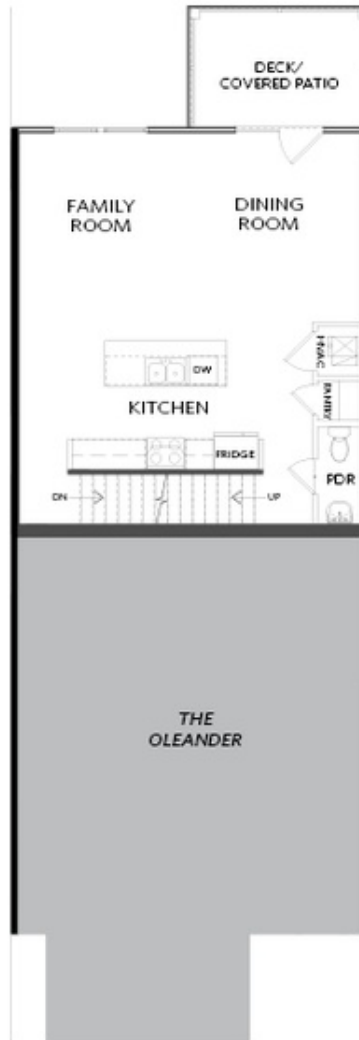

SECOND FLOOR

Elevations 1 & 1A Floor Plan Layout

Want to Know More
About This Home?

CONTACT OUR COMMUNITY SALES MANAGER
Call Us @ 678.372.1644



THIRD FLOOR

Elevations 1 & 1A Floor Plan Layout

Want to Know More
About This Home?

CONTACT OUR COMMUNITY SALES MANAGER
Call Us @ 678.372.1644