



PRICED AT  
**\$445,900**

 **1373 Sq Ft**

 **2 Beds**

 **2.5 Baths**

 **1 Car Garage**

 **3.0 Story**

**Fall Into Savings - Discover urban living right at your doorstep in the vibrant Market Square District of Sawnee Village. With a mix of retail and dining options just steps away, convenience and excitement abound. Whether you're a first-time homebuyer or seeking quality downsizing, Market Square offers something for everyone. Nestled in Cumming, GA, this community features stylish condos designed with you in mind. This Magnolia Plan hosts The Providence Groups' Warm Stone Design Collection. The plan spans 3 levels, boasting 2 bedrooms and 2.5 bathrooms across 1373 sq. ft. On the terrace level, find a gracious foyer and laundry room. The main level seamlessly combines the family room, dining area, chef-style kitchen with 42" cabinets and quartz countertops, and a covered porch. Stainless-steel GE appliances, a tile backsplash, and a modern lighting package complete this dreamy kitchen. On the third level, you'll find a spacious Primary Suite boasting a walk-in closet and a contemporary double-vanity bathroom. Additionally, there's an extra bedroom with its own private bathroom, completing this top-level area. Market Square isn't just a residence; it's a lifestyle—a place where thoughtful design meets convenience. This home is projected for delivery in December 2024/January 2025. At TPG, we value ...**

**Want to Know More  
About This Home?**

**CONTACT OUR COMMUNITY SALES MANAGER**  
Call Us @ 678.372.1644



FIRST FLOOR

Elevations 1 & 1A Floor Plan Layout

**Want to Know More  
About This Home?**

**CONTACT OUR COMMUNITY SALES MANAGER**  
Call Us @ 678.372.1644

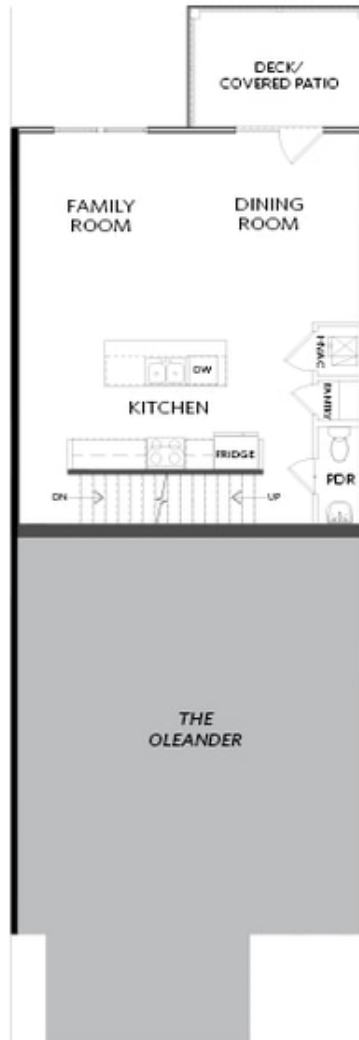

SECOND FLOOR

Elevations 1 & 1A Floor Plan Layout

Want to Know More  
About This Home?

CONTACT OUR COMMUNITY SALES MANAGER  
Call Us @ 678.372.1644



THIRD FLOOR

Elevations 1 & 1A Floor Plan Layout

**Want to Know More  
About This Home?**

**CONTACT OUR COMMUNITY SALES MANAGER**  
Call Us @ 678.372.1644