



PRICED AT
\$461,900

 1373 Sq Ft

 2 Beds

 2.5 Baths

 1 Car Garage

 3.0 Story

Embrace the pulse of urban living in Sawnee Village's lively Market Square District and Fall Into Savings with a fixed 5.25% interest rate or 2/1 Buydown starting at 1700!*. With an eclectic blend of retail and dining options mere steps away, convenience and vibrancy abound. Market Square caters to both first-time homebuyers and those seeking quality downsizing. Nestled in the heart of Cumming, GA, this vibrant community offers an array of stylish Condos that cater to your every need. Designed with The Providence Groups' Warm Linen Design Collection, the Magnolia Plan features 2 bedrooms and 2.5 bathrooms across 3 levels at 1373 sq. ft. Entering on the terrace level, this plan boasts a gracious foyer complemented by a quaint laundry room. Ascend to the main level, where an open-concept layout seamlessly merges the family room and dining area with a chef-style kitchen, adorned with stunning 42" cabinets and striking quartz countertops atop a massive island. Stainless-steel GE appliances, a tile backsplash, and modern lighting round out this dreamy kitchen. The sun-drenched dining area leads out to an expansive covered deck, ideal for hosting gatherings. Ascend to the third level to discover a large Primary Suite with a vast walk-in closet

...

**Want to Know More
About This Home?**

CONTACT OUR COMMUNITY SALES MANAGER
Call Us @ 678.372.1644



FIRST FLOOR

Elevations 1 & 1A Floor Plan Layout

**Want to Know More
About This Home?**

CONTACT OUR COMMUNITY SALES MANAGER
Call Us @ 678.372.1644

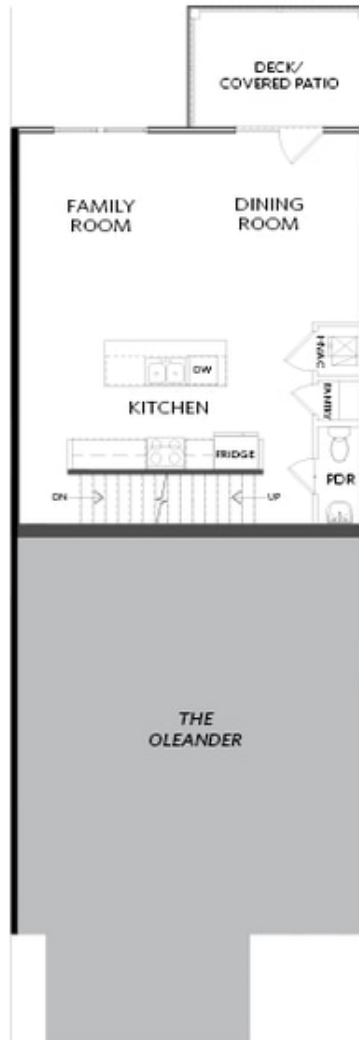

SECOND FLOOR

Elevations 1 & 1A Floor Plan Layout

**Want to Know More
About This Home?**

CONTACT OUR COMMUNITY SALES MANAGER
Call Us @ 678.372.1644



THIRD FLOOR

Elevations 1 & 1A Floor Plan Layout

**Want to Know More
About This Home?**

CONTACT OUR COMMUNITY SALES MANAGER
Call Us @ 678.372.1644