







PRICED AT
\$414,900

-  1703 Sq Ft
-  3 Beds
-  3.5 Baths
-  1 Car Garage
-  3.0 Story

Discover the Oleander Plan built by The Providence Group. February Completion Date. The Oleander Plan spans 3 levels and offers 3 bedrooms, 3.5 bathrooms, and 1,703 sq. ft. of stylish, low-maintenance living. Designed and curated with The Providence Group's Warm Wheat Design Collection, this home is perfect for modern lifestyles. Terrace Level: Enter from your oversized 1-car garage with EV charger and a private driveway for additional parking. Enjoy an oversized private bedroom with full bath and access to a covered terrace—ideal for guests, a home office, or personal gym. An additional coat closet and Laundry with GE Profiles 2 in 1 Washer/Dryer included with the home! Main Level: The open-concept layout is perfect for entertaining, featuring a spacious 8 ft. island topped with Calacatta Prado Quartz countertops and accented by pendant lighting. The kitchen includes 42" soft-close Alabaster Perimeter cabinetry & Maple Stained Island, GE appliances, and Light Oak Riverside Flooring flows throughout the main level, offering a sleek, low-maintenance surface ideal for hosting. Additional pantry space provides ample storage, and a convenient half bath completes this level. Upper Level: The Primary Suite features a generous walk-in closet and a spa-inspired bathroom with quartz countertops, a dual vanity, and ...

**Want to Know More
About This Home?**

CONTACT OUR COMMUNITY SALES MANAGER
Call Us @ 678.372.1644



FIRST FLOOR

Elevations 1 & 1A Floor Plan Layout

Want to Know More
About This Home?

CONTACT OUR COMMUNITY SALES MANAGER
Call Us @ 678.372.1644

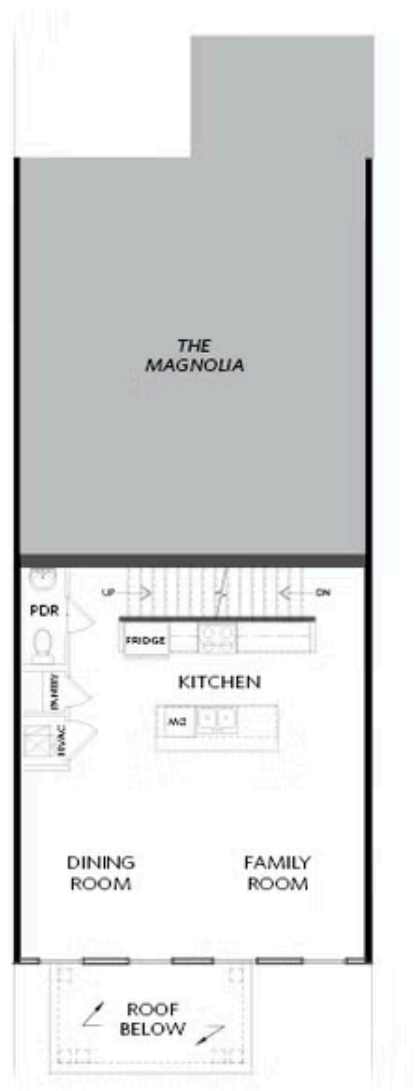

SECOND FLOOR

Elevations 1 & 1A Floor Plan Layout

Want to Know More
About This Home?

CONTACT OUR COMMUNITY SALES MANAGER
Call Us @ 678.372.1644



SECOND FLOOR

Elevations 1 & 1A Floor Plan Layout

Want to Know More
About This Home?

CONTACT OUR COMMUNITY SALES MANAGER
Call Us @ 678.372.1644

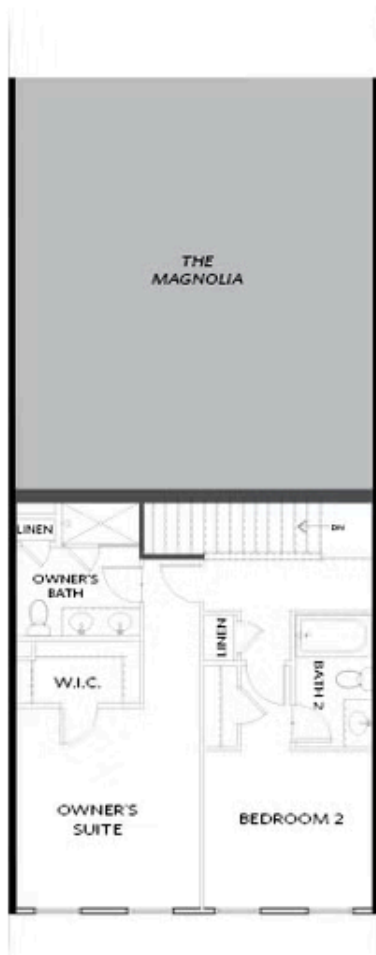

THIRD FLOOR

Elevations 1 & 1A Floor Plan Layout

Want to Know More
About This Home?

CONTACT OUR COMMUNITY SALES MANAGER
Call Us @ 678.372.1644