



PRICED AT  
**\$369,900**

 1373 Sq Ft

 2 Beds

 2.5 Baths

 1 Car Garage

 3.0 Story

Season of Savings at Market Square! Take advantage of an additional \$2,500 toward closing costs on the Magnolia Plan by The Providence Group. Estimated Completion: January/February 2026 Step into elevated living with this beautifully designed 3-story stacked townhome offering 2 bedrooms, 2.5 bathrooms, and 1,373 sq. ft. of stylish comfort and functionality. Curated with the Warm Slate Design Collection, this home features Calacatta Prado Quartz Countertops and Jackson Pine Flooring for a warm, contemporary ambiance. Terrace Level: A welcoming foyer leads to a convenient laundry area and a private garage equipped with an Electric Vehicle Charger—a modern touch for eco-conscious living. Main Level: Enjoy seamless flow in the open-concept layout connecting the family room, dining area, and chef-inspired kitchen. Highlights include 42" Slate Cabinets, quartz countertops, stainless steel GE appliances, a stylish tile backsplash, and a generous 8-foot island—perfect for entertaining. Step outside to your covered patio, ideal for morning coffee or evening unwinding. Third Level: Relax in the spacious Primary Suite featuring a walk-in closet and a spa-inspired bath with dual quartz vanities and a walk-in shower with tile surround. A secondary bedroom with its own private bath offers comfort and flexibility for guests or home office needs. More ...

Want to Know More  
About This Home?

CONTACT OUR COMMUNITY SALES MANAGER  
Call Us @ 678.372.1644

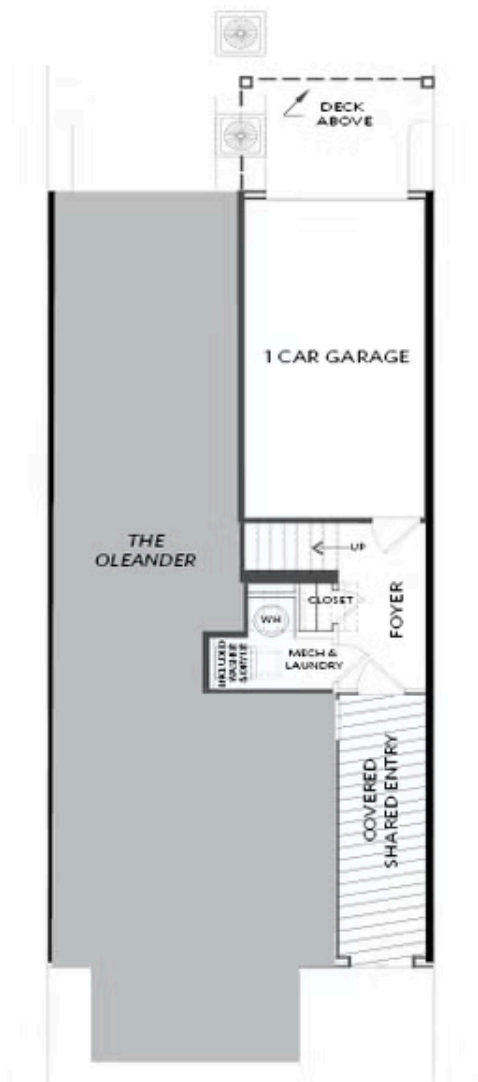

FIRST FLOOR

Elevations 1 & 1A Floor Plan Layout

Want to Know More  
About This Home?

CONTACT OUR COMMUNITY SALES MANAGER  
Call Us @ 678.372.1644

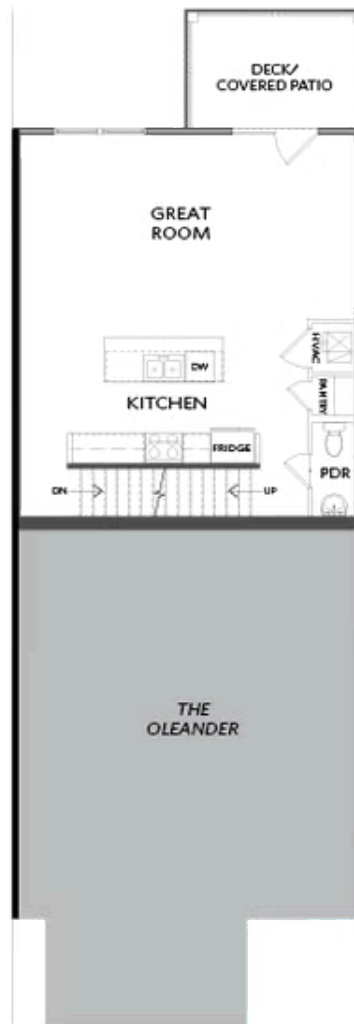

## SECOND FLOOR

Elevations 1 & 1A Floor Plan Layout

Want to Know More  
About This Home?

CONTACT OUR COMMUNITY SALES MANAGER  
Call Us @ 678.372.1644



THIRD FLOOR

Elevations 1 & 1A Floor Plan Layout

Want to Know More  
About This Home?

CONTACT OUR COMMUNITY SALES MANAGER  
Call Us @ 678.372.1644