







PRICED AT
\$399,900

-  1373 Sq Ft
-  2 Beds
-  2.5 Baths
-  1 Car Garage
-  3.0 Story

Kick off this Fall with a reduced interest rate for the month of September! 4.875% on FHA and 5.25% on Conventional loans with the use of our preferred lender. Welcome to Market Square at Sawnee Village - Where Style Meets Convenience in the Heart of Cumming, GA. Experience the perfect blend of modern living and walkable charm at Market Square at Sawnee Village. With shops, dining, and entertainment just steps away—and walkability to the Cumming City Center—this vibrant community is designed to fit your lifestyle, whether you're a first-time homebuyer or looking to right-size. The Magnolia Plan - 2 Bed | 2.5 Bath | 1,373 Sq Ft This 3-story stacked townhome with Condominium Ownership showcases The Providence Group's Warm Linen Design Collection, featuring Calacatta Prado quartz countertops and Piedmont Morningside flooring for a clean, elegant finish throughout the main living level. Terrace Level: Welcoming foyer with a thoughtfully placed laundry area and storage space. Main Level: Open-concept layout combining the family room, dining area, and chef-inspired kitchen. Highlights include 42" soft close cabinetry, Calacatta Prado quartz countertops, stainless GE appliances, textured White tile backsplash, and a spacious island spanning over 8 ft in length. The space opens to a private ...

**Want to Know More
About This Home?**

CONTACT OUR COMMUNITY SALES MANAGER
Call Us @ 678.372.1644

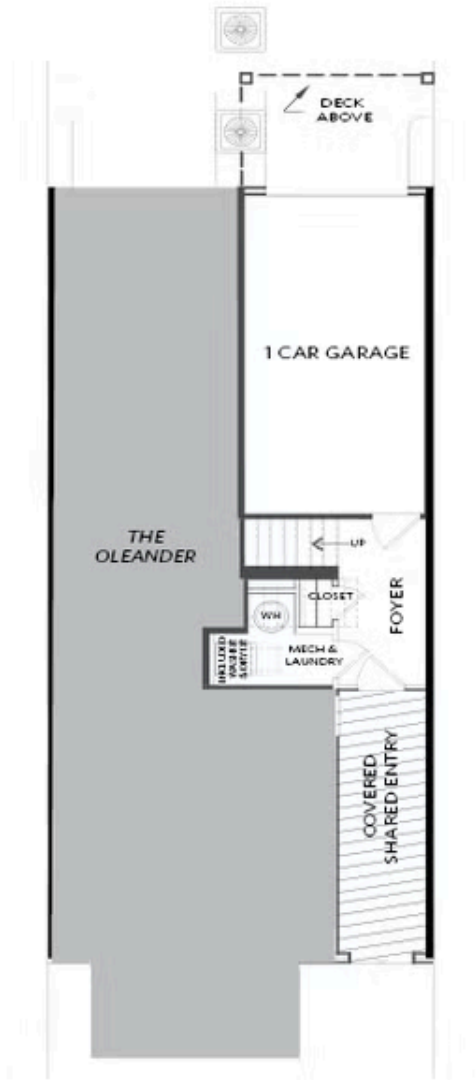

FIRST FLOOR

Elevations 1 & 1A Floor Plan Layout

Want to Know More
About This Home?

CONTACT OUR COMMUNITY SALES MANAGER
Call Us @ 678.372.1644

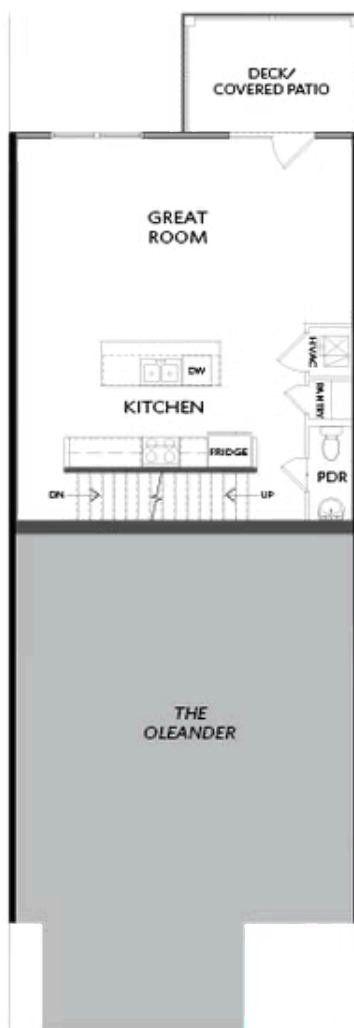

SECOND FLOOR

Elevations 1 & 1A Floor Plan Layout

Want to Know More
About This Home?

CONTACT OUR COMMUNITY SALES MANAGER
Call Us @ 678.372.1644

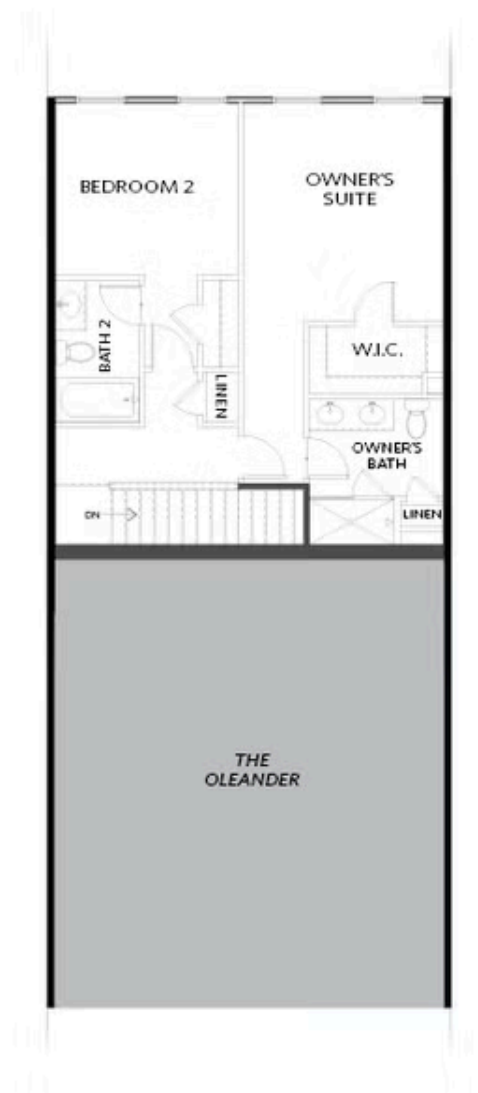

THIRD FLOOR

Elevations 1 & 1A Floor Plan Layout

Want to Know More
About This Home?

CONTACT OUR COMMUNITY SALES MANAGER
Call Us @ 678.372.1644