







PRICED AT
\$409,900

-  1703 Sq Ft
-  3 Beds
-  3.5 Baths
-  1 Car Garage
-  3.0 Story

HOME OF THE MONTH!! - Elevate Your Savings at Market Square with a \$409,900 Sales Price with Preferred Lender for the month of April! Discover the Oleander Plan built by The Providence Group. Estimated Completion: June 2026! Discover the Oleander Plan built by The Providence Group. Quick Move In! Welcome to the Oleander Plan, a beautifully designed three-story townhome offering 3 spacious bedrooms, 3.5 bathrooms, and 1,703 square feet of thoughtfully crafted living space. This luxury homesite showcases The Providence Group's Warm Slate Design Collection, featuring elegant cabinetry, stunning quartz countertops, and durable hardwood flooring throughout the main living level and hallways. Terrace Level: Enjoy a private bedroom with an ensuite bath and access to a covered patio—perfect for guests, a home office, or a personal fitness space. This level also includes a GE Profile 2-in-1 washer/dryer, offering added convenience. A one-car garage is located on this level and comes equipped with EV chargers already installed, making it ideal for modern living. Main Level: The open-concept layout seamlessly connects the family room, dining area, and chef-inspired kitchen, complete with 42" soft-close cabinetry, stainless GE appliances, tile backsplash, and designer lighting. A walk-out porch from the dining room offers a limited ...

**Want to Know More
About This Home?**

CONTACT OUR COMMUNITY SALES MANAGER
Call Us @ 678.372.1644



FIRST FLOOR

Elevations 1 & 1A Floor Plan Layout

Want to Know More
About This Home?

CONTACT OUR COMMUNITY SALES MANAGER
Call Us @ 678.372.1644

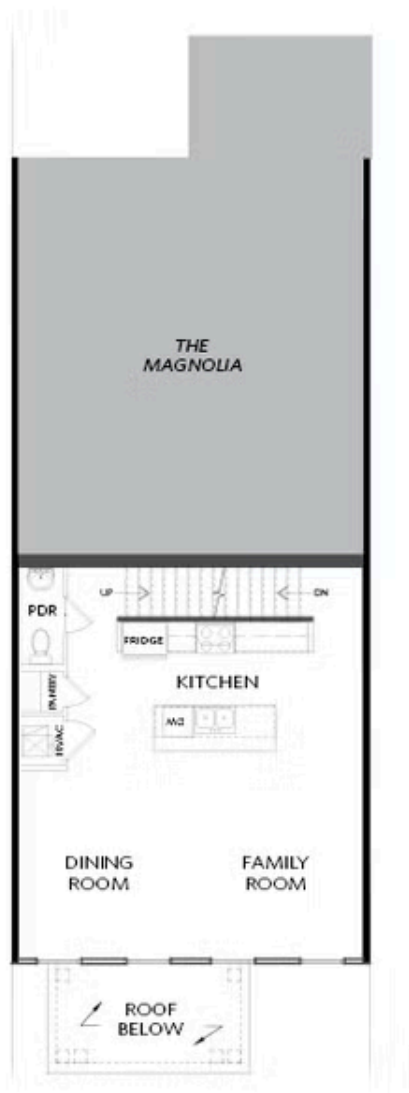

SECOND FLOOR

Elevations 1 & 1A Floor Plan Layout

Want to Know More
About This Home?

CONTACT OUR COMMUNITY SALES MANAGER
Call Us @ 678.372.1644

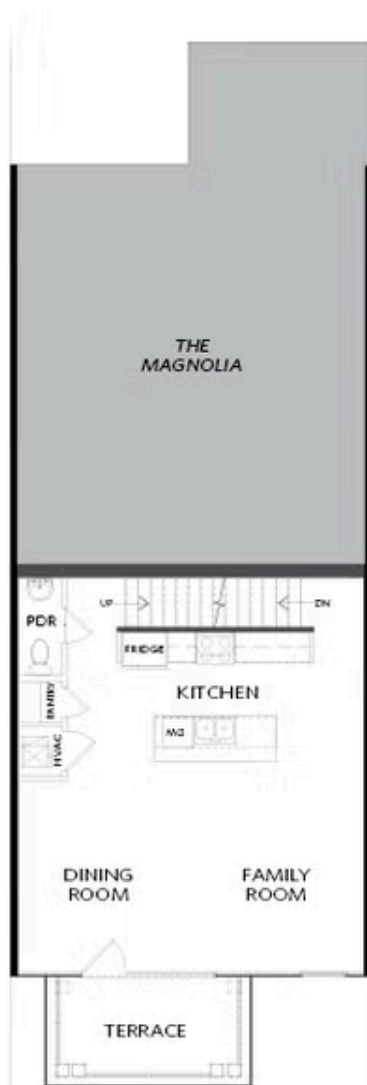

SECOND FLOOR

Elevations 1 & 1A Floor Plan Layout

Want to Know More
About This Home?

CONTACT OUR COMMUNITY SALES MANAGER
Call Us @ 678.372.1644

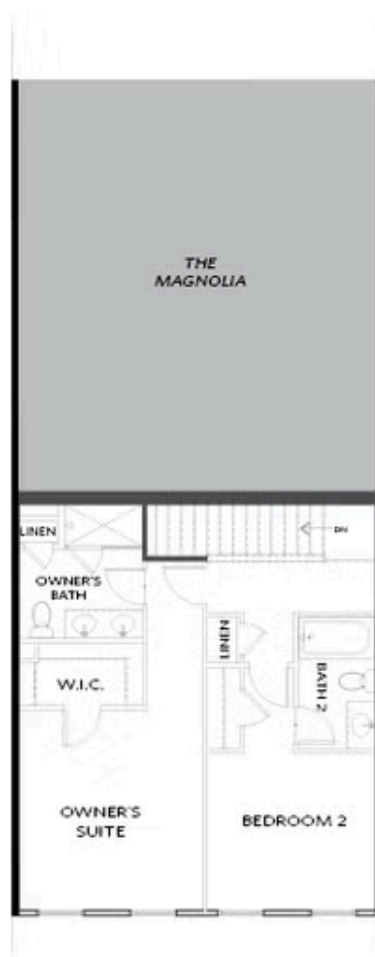

THIRD FLOOR

Elevations 1 & 1A Floor Plan Layout

Want to Know More
About This Home?

CONTACT OUR COMMUNITY SALES MANAGER
Call Us @ 678.372.1644