



PRICED AT
\$512,400

 1703 Sq Ft

 3 Beds

 3.5 Baths

 1 Car Garage

 3.0 Story

Move-In Ready End Unit at Market Square at Sawnee Village! Experience low-maintenance urban living in the heart of Cumming, GA—just steps from shopping, dining, and entertainment in the vibrant Market Square District. Whether you're a first-time homebuyer or looking to right-size, this community delivers modern comfort and unbeatable convenience in a walkable location. This 3-story Oleander plan offers 3 bedrooms, 3.5 bathrooms, and 1,703 sq ft of thoughtfully crafted living space with Condominium Ownership. Showcasing The Providence Group's Cool Stone Design Collection, this luxury homesite is part of a limited selection featuring a deck off the main-level living area—perfect for outdoor dining or relaxing. Enjoy upscale finishes including light gray cabinetry, Calacatta Ultra quartz countertops, and durable Dogwood hardwood flooring throughout the main living level and hallways. Terrace Level: Features a private bedroom with ensuite bath and access to a covered patio—ideal for guests, a home office, or fitness space. Main Level: The open-concept design blends a spacious family room, dining area, and a chef-inspired kitchen with 42" cabinetry, stainless GE appliances, tile backsplash, and designer lighting. Upper Level: The Primary Suite offers a large walk-in closet and spa-like bath with double vanities and a walk-in shower. A secondary bedroom ...

**Want to Know More
About This Home?**

CONTACT OUR COMMUNITY SALES MANAGER
Call Us @ 678.372.1644



FIRST FLOOR

Elevations 1 & 1A Floor Plan Layout

Want to Know More
About This Home?

CONTACT OUR COMMUNITY SALES MANAGER
Call Us @ 678.372.1644

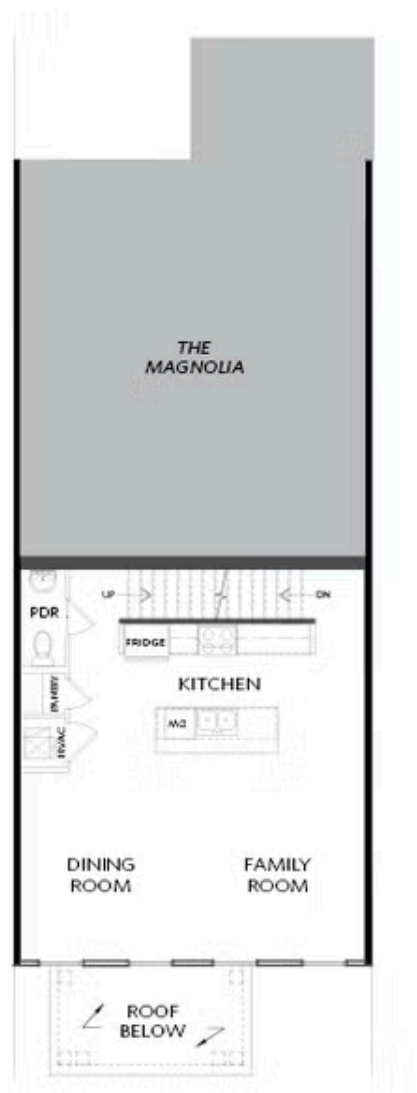

SECOND FLOOR

Elevations 1 & 1A Floor Plan Layout

Want to Know More
About This Home?

CONTACT OUR COMMUNITY SALES MANAGER
Call Us @ 678.372.1644

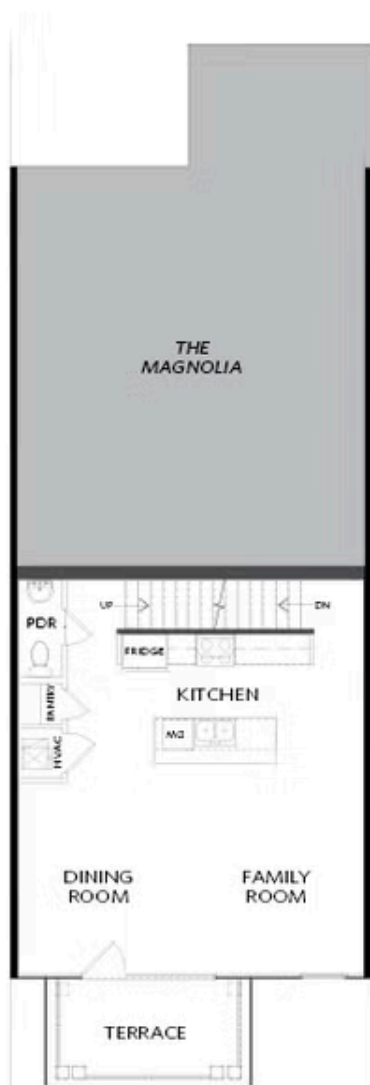

SECOND FLOOR

Elevations 1 & 1A Floor Plan Layout

Want to Know More
About This Home?

CONTACT OUR COMMUNITY SALES MANAGER
Call Us @ 678.372.1644

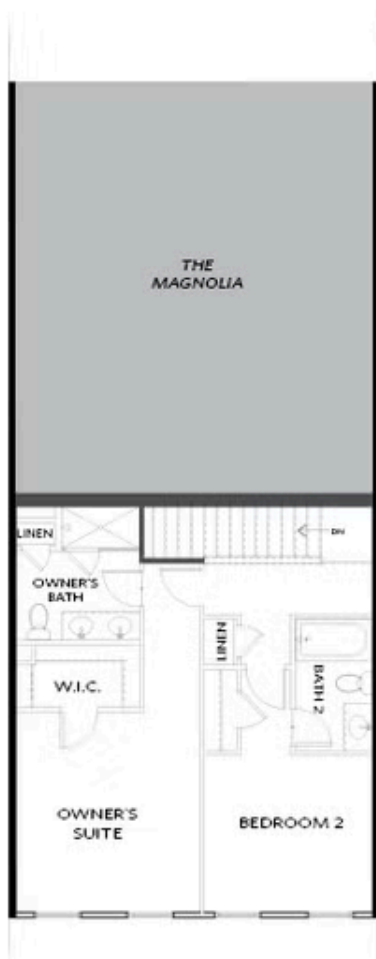

THIRD FLOOR

Elevations 1 & 1A Floor Plan Layout

Want to Know More
About This Home?

CONTACT OUR COMMUNITY SALES MANAGER
Call Us @ 678.372.1644