



PRICED AT
\$399,900

 1373 Sq Ft

 2 Beds

 2.5 Baths

 1 Car Garage

 3.0 Story

Kick off this Fall with a reduced interest rate for the month of September! 4.875% on FHA and 5.25% on Conventional loans with the use of our preferred lender. Welcome to Market Square at Sawnee Village - Experience the perfect balance of style, convenience, and value in the heart of Cumming, GA. Market Square at Sawnee Village offers an urban-inspired lifestyle with local shops, dining, and entertainment just steps from your door. Whether you're a first-time buyer or looking to right-size, this vibrant community is designed for the way you live. The Magnolia Plan - Modern Comfort Meets Timeless Design This 3-story stacked townhome with condominium ownership features 2 bedrooms, 2.5 bathrooms, and 1,373 sq. ft., thoughtfully curated with The Providence Group's Warm Wheat Design Collection for a sophisticated, contemporary aesthetic. Terrace Level: Welcoming foyer entry with a conveniently located laundry area. Main Level: Open-concept layout connecting the family room, dining area, and chef-inspired kitchen. Enjoy 42" cabinets, quartz countertops, stainless-steel GE appliances, textured geometric taupe tile backsplash, and a large island with a light brown stain finish paired with an Alabaster perimeter. Flooded with natural light, this space opens to a private deck—perfect for morning coffee or evening entertaining. ...

**Want to Know More
About This Home?**

CONTACT OUR COMMUNITY SALES MANAGER
Call Us @ 678.372.1644

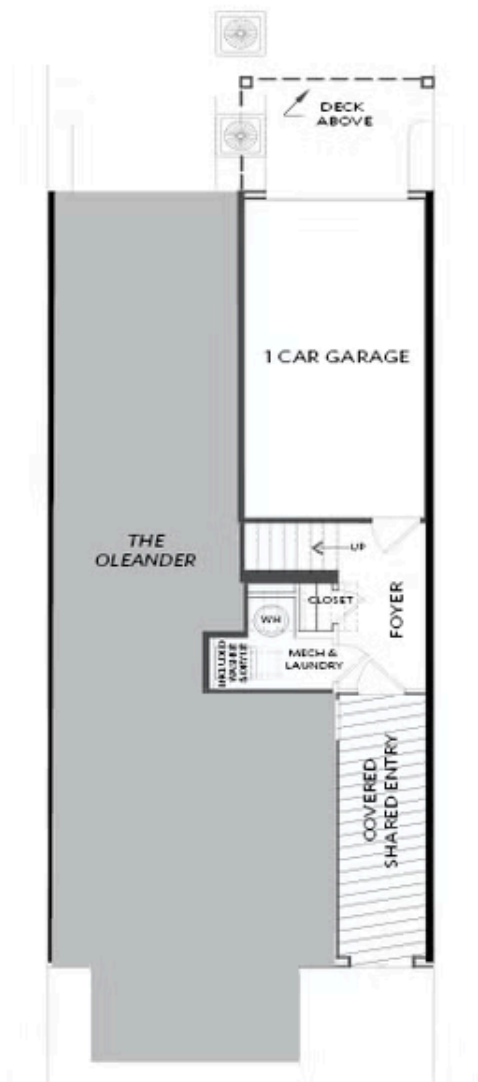

FIRST FLOOR

Elevations 1 & 1A Floor Plan Layout

Want to Know More
About This Home?

CONTACT OUR COMMUNITY SALES MANAGER
Call Us @ 678.372.1644

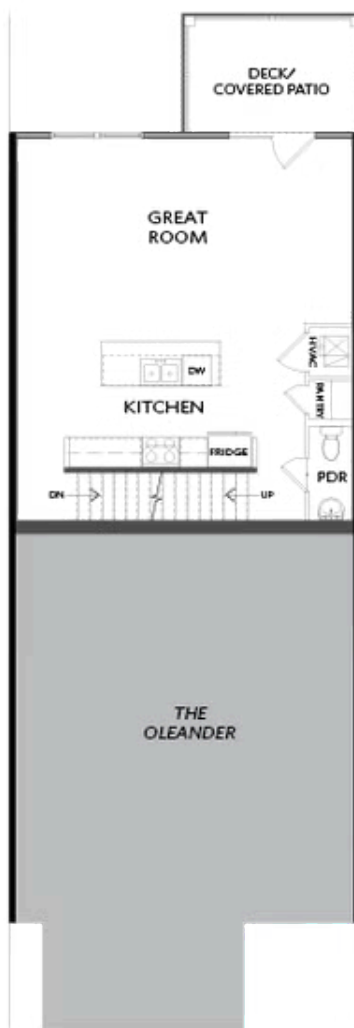

SECOND FLOOR

Elevations 1 & 1A Floor Plan Layout

Want to Know More
About This Home?

CONTACT OUR COMMUNITY SALES MANAGER
Call Us @ 678.372.1644



THIRD FLOOR

Elevations 1 & 1A Floor Plan Layout

Want to Know More
About This Home?

CONTACT OUR COMMUNITY SALES MANAGER
Call Us @ 678.372.1644