







PRICED AT
\$504,400

-  1703 Sq Ft
-  3 Beds
-  3.5 Baths
-  1 Car Garage
-  3.0 Story

Spring into a New Home with \$5,000 towards Closing Cost in Market Square at Sawnee Village Master Planned Community - walkable to Cumming City Center for Summer Concert Series! Discover Market Square at Sawnee Village - a vibrant master-planned community offering the perfect blend of shopping, dining, and entertainment right outside your door. Introducing The Oleander Plan - a beautifully designed 3 bedroom, 3.5 bath stacked townhome with condominium ownership. Offering 1,703 square feet across three thoughtfully designed levels, this home features The Providence Group's Cool Linen Design Collection—where elegance meets everyday functionality. Terrace Level: Enjoy the flexibility of a private bedroom with full bath and its own terrace patio—perfect as a guest suite, home office, or workout space. An oversized 1-car garage with EV charger and additional driveway parking add practicality to your lifestyle. Main Level: Entertain in style with an open-concept layout that seamlessly connects the family room, dining area, and chef's kitchen. The kitchen is a standout, featuring 42" soft-close cabinets, quartz countertops, GE stainless steel appliances, a designer tile backsplash, and curated lighting accents. Upper Level: Unwind in the serene Primary Suite, complete with a walk-in closet and a spa-inspired bath with dual vanities and a ...

**Want to Know More
About This Home?**

CONTACT OUR COMMUNITY SALES MANAGER
Call Us @ 678.372.1644



FIRST FLOOR

Elevations 1 & 1A Floor Plan Layout

Want to Know More
About This Home?

CONTACT OUR COMMUNITY SALES MANAGER
Call Us @ 678.372.1644

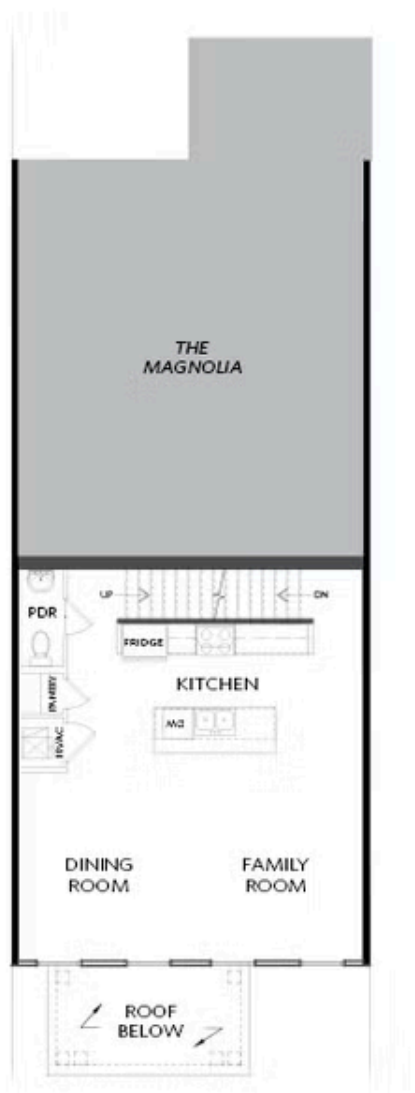

SECOND FLOOR

Elevations 1 & 1A Floor Plan Layout

Want to Know More
About This Home?

CONTACT OUR COMMUNITY SALES MANAGER
Call Us @ 678.372.1644

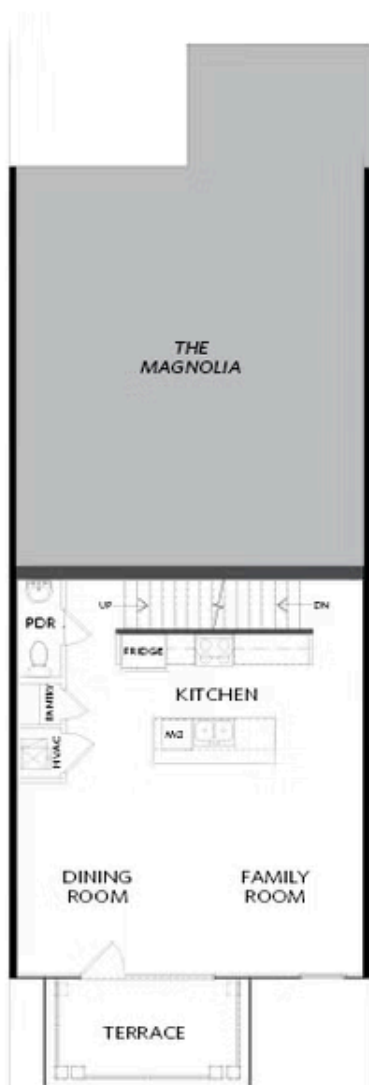

SECOND FLOOR

Elevations 1 & 1A Floor Plan Layout

Want to Know More
About This Home?

CONTACT OUR COMMUNITY SALES MANAGER
Call Us @ 678.372.1644

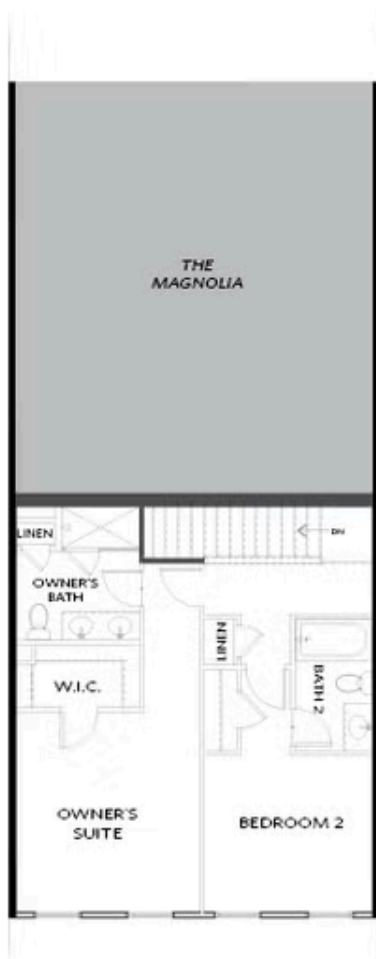

THIRD FLOOR

Elevations 1 & 1A Floor Plan Layout

Want to Know More
About This Home?

CONTACT OUR COMMUNITY SALES MANAGER
Call Us @ 678.372.1644