



PRICED AT
\$504,400

 1703 Sq Ft

 3 Beds

 3.5 Baths

 1 Car Garage

 3.0 Story

Welcome to Market Square at Sawnee Village – A Master-Planned Community with Retail, Dining & Entertainment at Your Doorstep! The Oleander Plan offers 3 bedrooms, 3.5 bathrooms, and 1,703 sq. ft. of stylish, low-maintenance living with Condominium Ownership. Thoughtfully designed across three levels, this move-in ready home showcases The Providence Group’s Cool Linen Design Collection, featuring Calacatta Ultra quartz countertops and Ambassador flooring for a modern, refined finish throughout. **Terrace Level:** Enjoy a private bedroom with full bath and access to a covered terrace—perfect for guests, a home office, or a personal gym. Includes an oversized 1-car garage with EV charger and a private driveway for extra parking. **Main Level:** Entertain with ease in the open-concept layout that blends the family room, dining area, and chef-inspired kitchen. The kitchen features 42” cabinetry, Calacatta Ultra quartz countertops, stainless GE appliances, sleek tile backsplash, and designer lighting. **Upper Level:** Unwind in the spacious Primary Suite with a walk-in closet and spa-like bath complete with double vanities and a walk-in shower. A secondary bedroom with its own private bath completes this top-level retreat. Market Square at Sawnee Village is more than a home—it’s a lifestyle. Walkable to Cumming City Center with more shops ...

**Want to Know More
About This Home?**

CONTACT OUR COMMUNITY SALES MANAGER
Call Us @ 678.372.1644



FIRST FLOOR

Elevations 1 & 1A Floor Plan Layout

Want to Know More
About This Home?

CONTACT OUR COMMUNITY SALES MANAGER
Call Us @ 678.372.1644

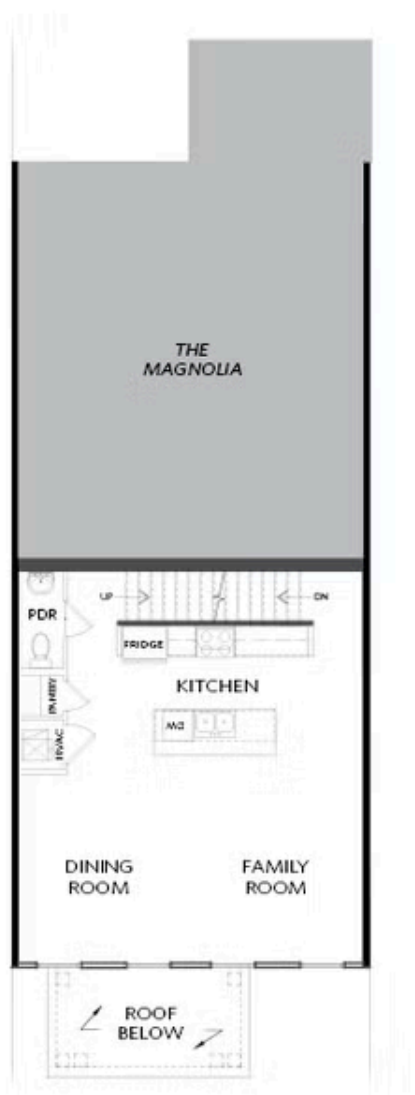

SECOND FLOOR

Elevations 1 & 1A Floor Plan Layout

Want to Know More
About This Home?

CONTACT OUR COMMUNITY SALES MANAGER
Call Us @ 678.372.1644

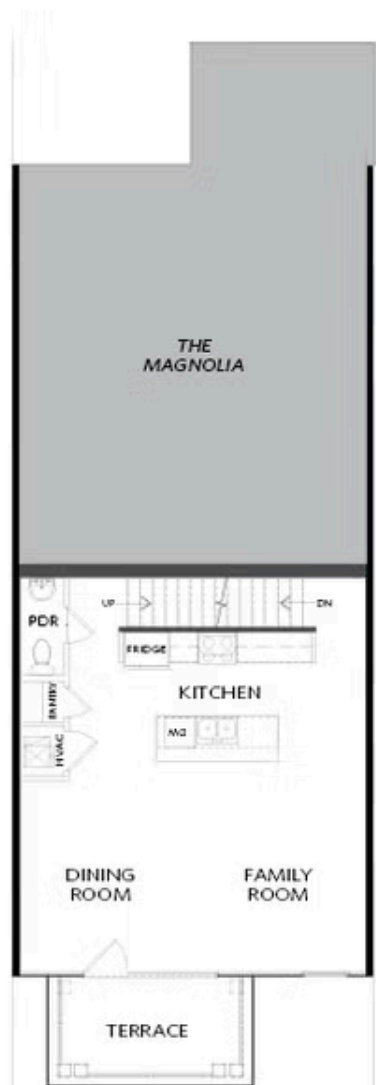

SECOND FLOOR

Elevations 1 & 1A Floor Plan Layout

Want to Know More
About This Home?

CONTACT OUR COMMUNITY SALES MANAGER
Call Us @ 678.372.1644

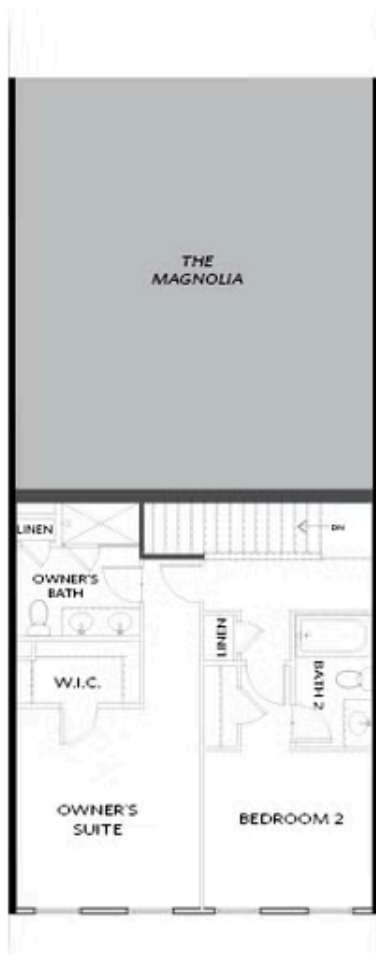

THIRD FLOOR

Elevations 1 & 1A Floor Plan Layout

Want to Know More
About This Home?

CONTACT OUR COMMUNITY SALES MANAGER
Call Us @ 678.372.1644